

CN-UB-280DC-BB

Order No.: 2818850

The illustration shows version CN-UB-280DC-SB

<http://eshop.phoenixcontact.de/phoenix/treeViewClick.do?UID=2818850>

Attachment plug with replaceable surge protection for coaxial signal interfaces. Connection: N connector female connector/female connector

Commercial data	
GTIN (EAN)	 4 017918 164027
sales group	J401
Pack	1 pcs.
Customs tariff	85363010
Catalog page information	Page 170 (TT-2011)

Product notes

WEEE/RoHS-compliant since:
05/05/2006



<http://www.download.phoenixcontact.com>
Please note that the data given here has been taken from the online catalog. For comprehensive information and data, please refer to the user documentation. The General Terms and Conditions of Use apply to Internet downloads.

Technical data	
General	
Housing material	Nickel-plated brass
Color	nickel

Standards for air and creepage distances	DIN VDE 0110-1
	IEC 60664-1: 1992-10
Surge voltage category	III
Pollution degree	2
Total surge current (8/20) μ s	20 kA
Ambient temperature (operation)	-40 °C ... 80 °C
Mounting type	Connection-specific intermediate plugging
Design	Attachment plug
Degree of protection	IP55
Direction of action	Line-Shield/Earth Ground
Width	25.00 mm
Height	67.00 mm
Length	25.00 mm

Protective circuit

IEC category	C2
	C3
	D1
VDE requirement class	C2
	C3
	D1
Maximum continuous operating voltage U_c	280 V DC
	195 V AC
Maximum continuous voltage U_c (wire-ground)	280 V DC
	195 V AC
Nominal current I_n	5 A (25°C)
Operating effective current I_c at U_c	$\leq 1 \mu$ A
Nominal discharge surge current I_n (8/20) μ s (Core-Earth)	20 kA
Nominal discharge surge current I_n (8/20) μ s (Core-Shield)	20 kA
Total surge current (8/20) μ s	20 kA
Max. discharge surge current I_{max} (8/20) μ s maximum (Core-Shield)	20 kA
Nominal pulse current I_{an} (10/1000) μ s (Core-Shield)	100 A
Lightning test current (10/350) μ s, peak value I_{imp}	2.5 kA

Output voltage limitation at 1 kV/μs (Core-Earth) spike	≤ 700 V
Output voltage limitation at 1 kV/μs (Core-Shield) spike	≤ 700 V
Output voltage limitation at 1 kV/μs (Core-Earth) static	≤ 700 V
Output voltage limitation at 1 kV/μs (Core-Shield) static	≤ 700 V
Protection level U _p (Core-Earth)	≤ 1.1 kV (C2 - 10 kV / 5 kA) ≤ 700 V (C1 - 1 kV/500 A)
Protection level U _p (Core-Shield)	≤ 1.1 kV (C2 - 10 kV / 5 kA) 700 V (C1 - 1 kV/500 A)
Response time t _A (Core-Earth)	≤ 100 ns
Response time t _A (Core-GND)	≤ 100 ns
Input attenuation a _E , asym.	Typ. 0.1 dB (≤ 1.2 GHz) Typ. 0.2 dB (≤ 2.2 GHz)
Cut-off frequency f _g (3 dB), asym. (shield) in 50 Ohm system	> 3 GHz
Standing wave ratio SWR in a 50 Ω system	Typ. 1.1 (≤ 2 GHz)
Permissible HF power P _{max.} at SWR=xx (50 Ohm system)	700 W (VSWR = 1.1) 200 W (VSWR = ∞)
Capacity (Core-Earth)	Typ. 1.5 pF
Capacity asymmetrical (shield)	Typ. 1.5 pF
Surge carrying capacity in acc. with IEC 61643-21 (Core-Earth)	C1 (1 kV / 500 A) C2 (10 kV/5 kA) C3 (100 A) D1 (2.5 kA)

Connection data

Connection method	N connector 50 Ω
Connection type IN	N connector, female
Connection type OUT	N connector, female

Connection, protective circuit

Standards/regulations	IEC 61643-21
-----------------------	--------------

Certificates / Approvals

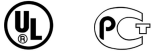

Certification: GOST, UL Listed
 Certification Ex: CUL-EX, UL-EX

Accessories

Item	Designation	Description
Assembly		
2818135	CN-UB/MP	Tongue for attaching the CN-UB..., to housing panels, for example.
2803137	CN-UB/MP-90DEG-50	Angled bracket for individually fixing CN-UB... to housing panels, for example.

Additional products

Item	Designation	Description
Assembly		
2818135	CN-UB/MP	Tongue for attaching the CN-UB..., to housing panels, for example.

Diagrams/Drawings

Diagram

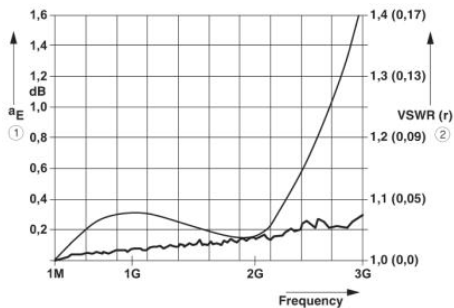

① Typical attenuation curve for CN-UB-280DC...
 ② Typical VSWR at CN-UB-280DC...

Dimensioned drawing

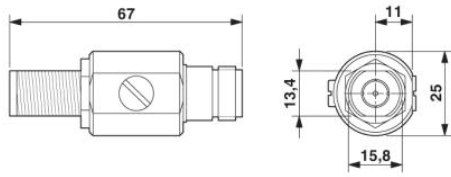

Circuit diagram

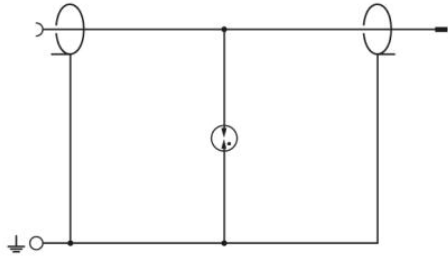

Address

PHOENIX CONTACT Inc., USA
586 Fulling Mill Road
Middletown, PA 17057, USA
Phone (800) 888-7388
Fax (717) 944-1625
<http://www.phoenixcon.com>



© 2011 Phoenix Contact
Technical modifications reserved;