



Poppet seal couplings made to the ISO 5675 Standard*

DINV, DNVZ Series



INTRODUCTION

Holmbury's DINV Series couplings are designed with a poppet valve for quick connection and disconnection. They are interchangeable with the ISO A couplings in 1/2" size.

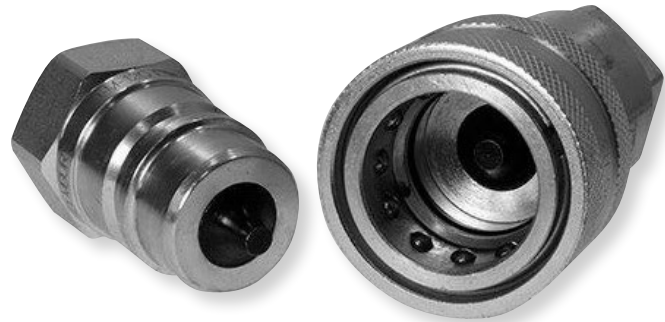
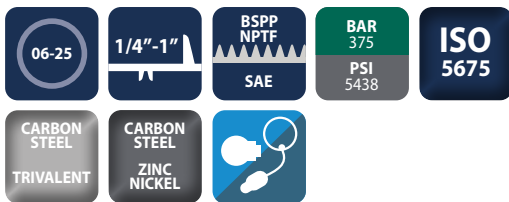

CONSTRUCTION

- Carbon steel with trivalent plating, also available in zinc nickel
- Fitted with NBR seals
- Also available in ball valve design (See DINB Series)

FEATURES

- Poppet valves have balanced springs
- Locking ball system allows quick connection
- Bidirectional flow

ACCESSORIES

- Dust caps, plugs and seal kits are available for the DINV Series

SPECIFICATIONS

- Operating temperatures (with NBR seals): -40°C (-40°F) to 106°C (223°F)

APPLICATIONS

- Agricultural
- Mobile
- Construction
- General hydraulics

DINV, DNVZ PERFORMANCE CHARACTERISTICS

Body Size	DINV06	DINV10	DINV12	DINV19	DINV25
	Pressure in bar - Flow in LPM				
	Pressure in PSI - Flow in GPM				
Maximum working pressure (Coupled)	375 5437	350 5075	320 4640	300 4350	275 3987
Burst pressure (Coupled)	1600 23200	1450 21025	1300 18850	1200 17400	1100 15950
Burst pressure (Male)	1600 23200	1300 18850	1500 21750	1100 15950	1000 14500
Burst pressure (Female)	1600 23200	1300 18850	1400 20300	1100 15950	1000 14500
Rated flow	3 0.8	23 6.1	45 12	106 28	189 50

* 1/2 Only.

CAPS/PLUGS ACCESSORIES

FEMALE PLUGS	MALE CAPS
DIN06-F-PLUG	DIN06-M-CAP
DIN10-F-PLUG	DIN10-M-CAP
DIN12-F-PLUG	DIN12-M-CAP
DIN19-F-PLUG	DIN19-M-CAP
DIN25-F-PLUG	DIN25-M-CAP

Standard colour is red pvc, other colours available upon request

SEAL KITS

DIN06-F-SEAL KIT
DIN10-F-SEAL KIT
DIN12-F-SEAL KIT
DIN19-F-SEAL KIT
DIN25-F-SEAL KIT

DINV, DNVZ Series

DINV, DNVZ FEMALE COUPLING

Body Size	Part Number	Thread Size	A/F1		L1		D1	
			mm	inch	mm	inch	mm	inch
06 (1/4)	DINV06-F-04G	1/4 BSPP	22.2	0.87	55.5	2.19	27.6	1.09
	DINV06-F-04N	1/4 NPTF	22.2	0.87	55.5	2.19	27.6	1.09
	DINV06-F-06S	9/16-18 UNF	22.2	0.87	55.5	2.19	27.6	1.09
10 (3/8)	DINV10-F-06G	3/8 BSPP	24.0	0.94	60.5	2.38	34.0	1.34
	DINV10-F-06N	3/8 NPTF	24.0	0.94	60.5	2.38	34.0	1.34
	DINV10-F-06S	9/16-18 UNF	24.0	0.94	60.5	2.38	34.0	1.34
12 (1/2)	DINV12-F-08G	1/2 BSPP	27.0	1.06	68.0	2.68	38.0	1.50
	DINV12-F-08N	1/2 NPTF	27.0	1.06	68.0	2.68	38.0	1.50
	DINV12-F-08S	3/4-16 UNF	27.0	1.06	68.0	2.68	38.0	1.50
	DINV12-F-10S	7/8-14 UNF	27.0	1.06	68.0	2.68	38.0	1.50
19** (3/4)	DINV19-F-12G	3/4 BSPP	34.0	1.34	82.5	3.25	48.2	1.90
	DINV19-F-12N	3/4 NPTF	35.0	1.38	83.0	3.27	47.5	1.87
	DINV19-F-12S	1 1/16-12 UN	35.0	1.38	83.0	3.27	47.5	1.87
25 (1)	DINV25-F-16G	1 BSPP	41.0	1.61	97.5	3.84	56.2	2.21
	DINV25-F-16N	1 NPTF	41.0	1.61	97.5	3.84	56.2	2.21
	DINV25-F-16S	1 5/16-12 UN	41.0	1.61	97.5	3.84	56.2	2.21

**Size 19 differs in USA and UK, neither meet ISO 5675 dimensional requirements.
For all other configurations or thread types please contact the sales office.

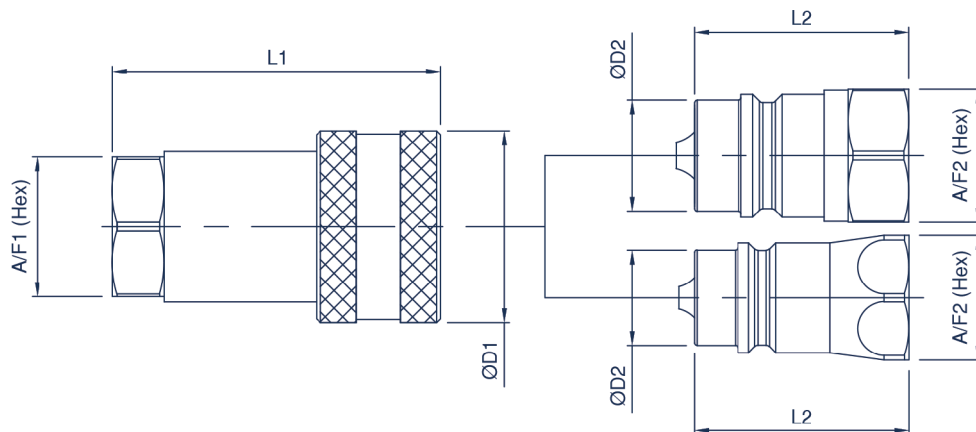

DINV, DNVZ MALE COUPLING

Body Size	Part Number	Thread Size	D2		L2		A/F2	
			mm	inch	mm	inch	mm	inch
06 (1/4)	DINV06-M-04G	1/4 BSPP	14.2	0.56	36.0	1.42	19.0	0.75
	DINV06-M-04N	1/4 NPTF	14.2	0.56	36.0	1.42	19.0	0.75
	DINV06-M-06S	9/16-18 UNF	14.2	0.56	36.0	1.42	19.0	0.75
10 (3/8)	DINV10-M-06G	3/8 BSPP	19.0	0.75	40.0	1.57	24.0	0.94
	DINV10-M-06N	3/8 NPTF	19.0	0.75	40.0	1.57	24.0	0.94
	DINV10-M-06S	9/16-18 UNF	19.0	0.75	40.0	1.57	24.0	0.94
12* (1/2)	DINV12-M-08G	1/2 BSPP	20.5	0.81	46.0	1.81	27.0	1.06
	DINV12-M-08N	1/2 NPTF	20.5	0.81	46.0	1.81	27.0	1.06
	DINV12-M-08S	3/4-16 UNF	20.5	0.81	46.0	1.81	27.0	1.06
	DINV12-M-10S	7/8-14 UNF	20.5	0.81	46.0	1.81	27.0	1.06
19** (3/4)	DINV19-M-12G	3/4 BSPP	28.0	1.10	53.5	2.11	34.0	1.34
	DINV19-M-12N	3/4 NPTF	26.9	1.06	51.0	2.01	33.3	1.31
	DINV19-M-12S	1 1/16-12 UN	26.9	1.06	51.0	2.01	33.3	1.31
25 (1)	DINV25-M-16G	1 BSPP	31.3	1.23	64.0	2.52	41.0	1.61
	DINV25-M-16N	1 NPTF	31.3	1.23	64.0	2.52	41.0	1.61
	DINV25-M-16S	1 5/16-12 UN	31.3	1.23	64.0	2.52	41.0	1.61

*Size 12 outside profile of male is different in USA and incorporates an internal shield.
**Size 19 differs in USA and UK, neither meet ISO 5675 dimensional requirements.