

Accessories——Silencers

NBSL, NBSLM, NBESL, BSL, BSLM, BESL, PAL, PALM series



Ordering code

NBSL 1/4

①

②

① Silencer Type

NBSL: Universal silencer
NBSLM: Mini Silencer
NBESL: Throttling Silencer

② Thread connection

U10: #10-32 UNF
1/8: NPT1/8
1/4: NPT1/4
3/8: NPT3/8
1/2: NPT1/2

BSL 01

①

②

① Silencer Type

BSL: Universal silencer
BSLM: Mini Silencer
BESL: Throttling silencer
PAL: Plastic silencer
PALM: Mini plastic Silencer

② Thread connection

M5: M5X0.8
01: PT1/8
02: PT1/4
03: PT3/8
04: PT1/2

Configuration table of tubing thread

Product series	Thread connection				
	#10-32 UNF	NPT1/8	NPT1/4	NPT3/8	NPT1/2
NBSL/NBSLM	•	•	•	•	•
NBESL		•	•	•	•

Product series	Thread connection				
	M5	PT1/8	PT1/4	PT3/8	PT1/2
BSL/BSLM	•	•	•	•	•
BESL/PAL		•	•	•	•
PALM		•	•		

Specification

Model	NBSLU10	NBSL1/8	NBSL1/4	NBSL3/8	NBSL1/2	NBSLMU10	NBSLM1/8	NBSLM1/4	NBSLM3/8	NBSLM1/2
Thread connection	#10-32 UNF	NPT1/8	NPT1/4	NPT3/8	NPT1/2	#10-32 UNF	NPT1/8	NPT1/4	NPT3/8	NPT1/2
Silencing effect(dB)(0.5MPa)	13	13	13	13	13	13	13	13	13	13
Model							NEBSL1/8	NEBSL1/4	NEBSL3/8	NEBSL1/2
Thread connection							NPT1/8	NPT1/4	NPT3/8	NPT1/2
Silencing effect(dB)(75psi)							13	13	13	13
Operating pressure	0~10kgf/cm ² (0~1.0MPa)									
Negative pressure	-750mmHg(10Torr)									
Proof pressure	215psi(1.5MPa)									
Temperature range	-5~160°F(-20~70°C)									

Model	BSLM5	BSL01	BSL02	BSL03	BSL04	BSLMM5	BSLM01	BSLM02	BSLM03	BSLM04
Thread connection	M5×0.8	PT1/8	PT1/4	PT3/8	PT1/2	M5×0.8	PT1/8	PT1/4	PT3/8	PT1/2
Silencing effect(dB)(0.5MPa)	13	13	13	13	13	13	13	13	13	13
Model	BESL01	BESL02	BESL03	BESL04	PAL01	PAL02	PAL03	PAL04	PALM01	PALM02
Thread connection	PT1/8	PT1/4	PT3/8	PT1/2	PT1/8	PT1/4	PT3/8	PT1/2	PT1/8	PT1/4
Silencing effect(dB)(0.5MPa)	13	13	13	13	25	25	25	25	25	25
Operating pressure	0~10kgf/cm ² (0~1.0MPa)									
Negative pressure	-750mmHg(10Torr)									
Proof pressure	1.5MPa									
Temperature range	-20~70°C									

NBSL, NBSLM, NBESL, BSL, BSLM, BESL, PAL, PALM series

Product feature

NBSL, NBSLM, NBESL, BSL, BSLM, BESL Series:

1. This silencers have excellent noise silencing performance.
2. The installation of the silencer is simple and convenient, and the connecting portion is reliable and durable.
3. It is easy to adjust the exhaust flow of the throttling type silencer.

PAL Series, PALM Series:

1. The silencer body is made of plastic.
2. The mini type silencer has the characteristics of small volume and compact structure.

Inner structure

NBSL, BSL Series

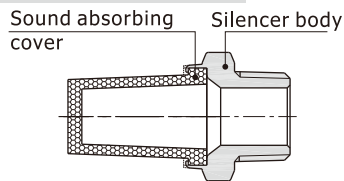

NBESL, BESL Series

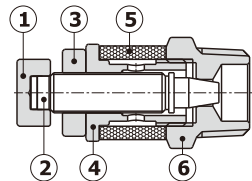

NO.	Name	NO.	Name
1	Adjusting cap	4	Locking ring
2	Throttling column	5	Silencer ring
3	Locking cap	6	Silencer body

PAL Series

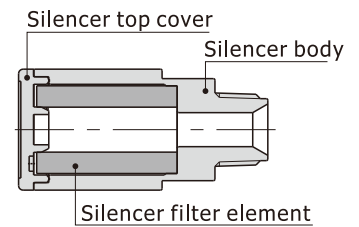

Flowrate characteristic

NBSL Series

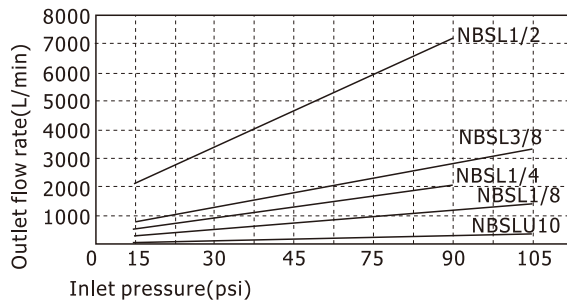

NBSLM Series

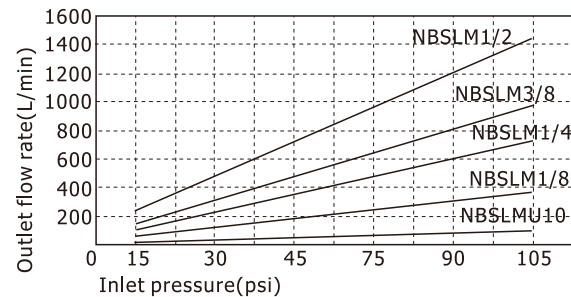

NBESL Series

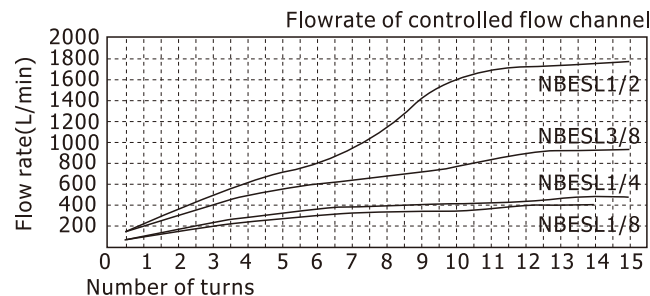

NBESL Series

(Inlet pressure and outlet flow rate)

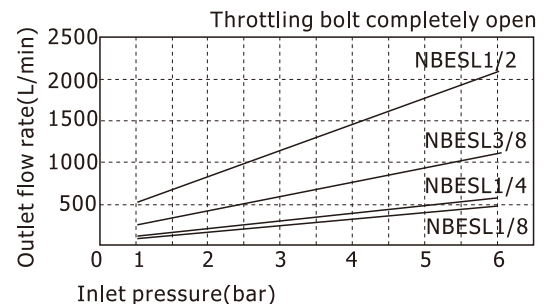

Accessories—Silencers

NBSL, NBSLM, NBESL, BSL, BSLM, BESL, PAL, PALM series

Flowrate characteristic

BSL Series

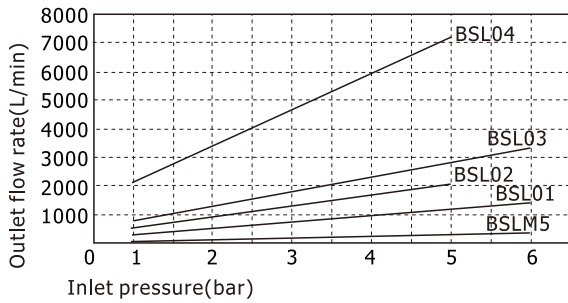

BSLM Series

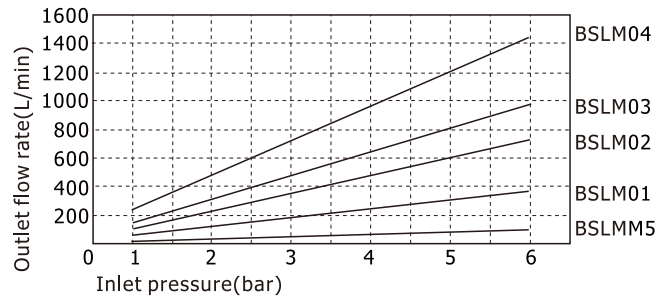

PAL, PALM Series

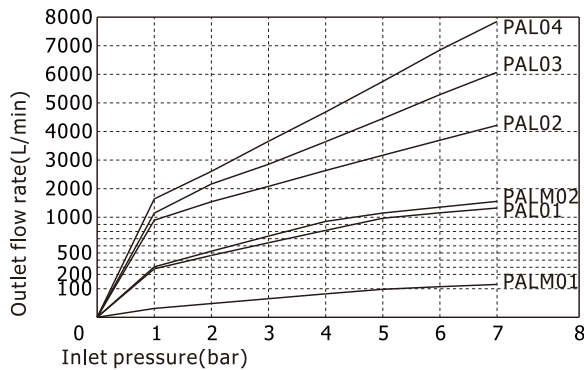

BESL Series (Inlet pressure and outlet flow rate)

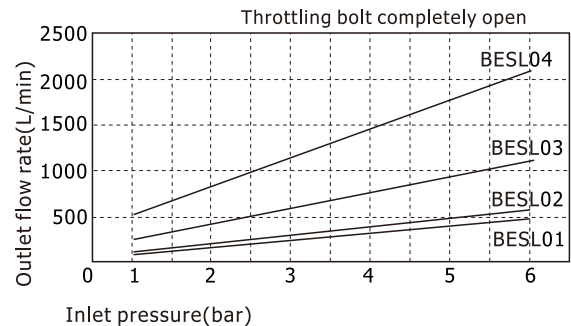

BESL Series

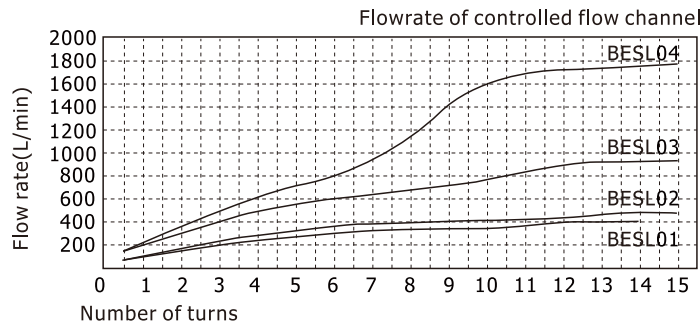

Dimensions

PAL, PALM Series

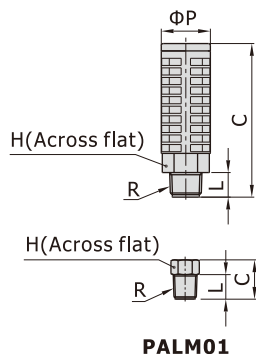

[Unit: mm]

Model\Item	R	ΦP	L	C	H	Weight(g)
PAL01	PT1/8	16	7	33	14	4.2
PALM01	PT1/8	/	10	16	10	0.9
PAL02	PT1/4	20	10	62.5	17	10.7
PALM02	PT1/4	16	10	36	14	5.1
PAL03	PT3/8	26	12	68	24	20
PAL04	PT1/2	28	12	73	24	23.1

Accessories——Silencers

NBSL, NBSLM, NBESL, BSL, BSLM, BESL, PAL, PALM series

NBSL Series

[Unit: inch]

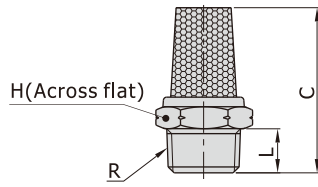

Model\Item	R	L	C	H	Weight(g)
NBSLU10	#10-32 UNF	0.14	0.77	5/16	2.9
NBSL1/8	NPT1/8	0.24	0.94	1/2	7.1
NBSL1/4	NPT1/4	0.31	1.18	5/8	12.4
NBSL3/8	NPT3/8	0.35	1.52	3/4	22.0
NBSL1/2	NPT1/2	0.41	1.87	7/8	35.3

BSL Series

[Unit: mm]

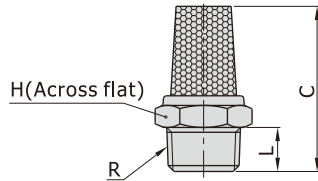

Model\Item	R	L	C	H	Weight(g)
BSLM5	M5×0.8	3.5	19.5	8	2.9
BSL01	PT1/8	6	24	12	6.7
BSL02	PT1/4	8	30	15	11.6
BSL03	PT3/8	9	38.5	19	22
BSL04	PT1/2	10.5	46	22	35

NBSLM Series

[Unit: inch]

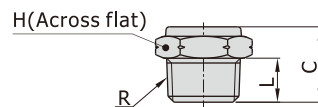

Model\Item	R	L	C	H	Weight(g)
NBSLMU10	#10-32 UNF	0.14	0.37	5/16	2.3
NBSLM1/8	NPT1/8	0.24	0.43	7/16	4.3
NBSLM1/4	NPT1/4	0.31	0.53	5/8	9.2
NBSLM3/8	NPT3/8	0.35	0.61	3/4	15.8
NBSLM1/2	NPT1/2	0.41	0.81	7/8	26.3

BSLM Series

[Unit: mm]

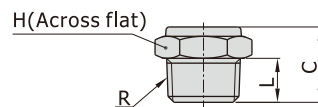

Model\Item	R	L	C	H	Weight(g)
BSLMM5	M5×0.8	3.5	9.5	8	2.3
BSLM01	PT1/8	6	11	11	4.3
BSLM02	PT1/4	8	13.5	15	8.4
BSLM03	PT3/8	9	15.5	19	15.8
BSLM04	PT1/2	10.5	19	22	25.9

NBESL Series

[Unit: inch]

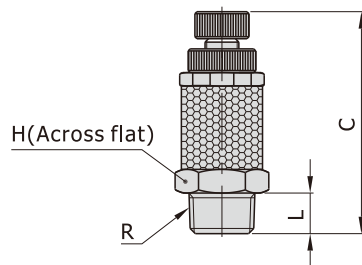

Model\Item	R	L	C	H	Weight(g)
NBESL1/8	NPT1/8	0.24	0.94	1/2	10.4
NBESL1/4	NPT1/4	0.31	1.18	9/16	18.4
NBESL3/8	NPT3/8	0.35	1.52	11/16	31.7
NBESL1/2	NPT1/2	0.41	1.81	15/16	69.4

BESL Series

[Unit: mm]

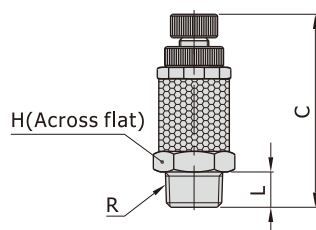

Model\Item	R	L	C		H	Weight(g)
			max	min		
BESL01	PT1/8	6	40.5	33	12	10
BESL02	PT1/4	8	42.5	35	14	18.1
BESL03	PT3/8	9	49	41.5	17	31.1
BESL04	PT1/2	10.5	59.5	52	24	69.8

