

## Pneumatic connection technologies → Push-In fittings

## Series QR1-S standard

► T-plug connector ► push-in fitting ► Ø 4 - Ø16 ► push-in fitting ► Ø 4 - Ø16 ► QR1-S-RTK



Ambient temperature min./max.

+0°C / +60°C

Working pressure min./max.

-0.95 bar / 10 bar

Materials:

Screw

nickel-plated

Housing

Polybutyleneterephthalate

Seal

Acrylonitrile Butadiene Rubber

Tooth lock washer

Stainless steel

Release ring

Polyoxymethylene

Release ring holder

Die cast zinc; Brass, nickel-plated

## Technical Remarks

- The series QR1 (plastic) and QR2 (metal) can not be combined
- For further information about assembling and tolerances of adaptable tubing, see the section "Technical information".

## Dimensions

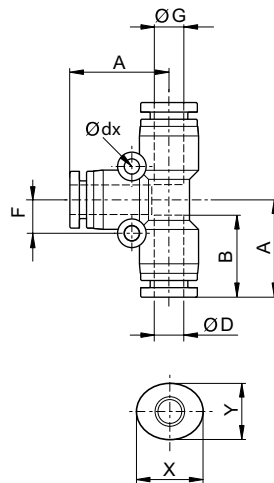

Part No.	Port G	Port D	Ø dx	A	B	F	X	Y	Delivery quantity [Piece]	Weight [kg]
<b>2121104000</b>	Ø 4	Ø 4	2.2	18.5	16	6	12	10	10	0.007
<b>2121106000</b>	Ø 6	Ø 6	3.2	20.4	17	8	14	12	10	0.0094
<b>2121108000</b>	Ø 8	Ø 8	3.2	22.8	18.5	9	16	14	10	0.0126
<b>2121110000</b>	Ø 10	Ø 10	4.2	26.1	21	12	19	17	10	0.0221
<b>2121112000</b>	Ø 12	Ø 12	4.2	29	22.5	14	23	21	10	0.0307
<b>2121114000</b>	Ø 14	Ø 14	-	32.1	24.6	13.5	25	23	5	0.0409
<b>R412005025</b>	Ø16	Ø16	5.3	31.1	22.6	16.6	27	24	5	0.0523