

## Pneumatic connection technologies → Push-In fittings

## Series QR1-S standard

► Blanking plug ► pin bushing ► Ø 4 - Ø16 ► QR1-S-RBS



00136364

Ambient temperature min./max.

+0°C / +60°C

Working pressure min./max.

-0.95 bar / 10 bar

Materials:

Screw

nickel-plated

Housing

Polybutyleneterephthalate

## Technical Remarks

- The series QR1 (plastic) and QR2 (metal) can not be combined
- For further information about assembling and tolerances of adaptable tubing, see the section "Technical information".

## Dimensions

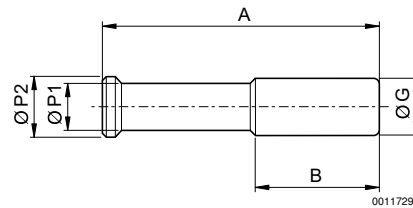

00117291

| Part No.          | Port G | A  | B    | Ø P1 | Ø P2 | Delivery quantity [Piece] | Weight [kg] |  |  |  |  |
|-------------------|--------|----|------|------|------|---------------------------|-------------|--|--|--|--|
| <b>2123204000</b> | Ø 4    | 28 | 16   | 3    | 4    | 20                        | 0.0004      |  |  |  |  |
| <b>2123206000</b> | Ø 6    | 32 | 17   | 4    | 6    | 20                        | 0.0007      |  |  |  |  |
| <b>2123208000</b> | Ø 8    | 39 | 18.5 | 5    | 8    | 20                        | 0.0014      |  |  |  |  |
| <b>2123210000</b> | Ø 10   | 42 | 21   | 8    | 10   | 20                        | 0.002       |  |  |  |  |
| <b>2123212000</b> | Ø 12   | 44 | 22.5 | 8    | 12   | 20                        | 0.0036      |  |  |  |  |
| <b>2123214000</b> | Ø 14   | 45 | 24.6 | 8    | 14   | 10                        | 0.005       |  |  |  |  |
| <b>R412005331</b> | Ø16    | 46 | 24.8 | 10   | 16   | 10                        | 0.004       |  |  |  |  |