

## Pneumatic connection technologies → Push-In fittings

## Series QR1-S standard

► Blanking plug ► pin bushing ► Ø 4 - Ø16 ► QR1-S-RBS



00136364

Ambient temperature min./max.

+0°C / +60°C

Working pressure min./max.

-0.95 bar / 10 bar

Materials:

Screw

nickel-plated

Housing

Polybutyleneterephthalate

## Technical Remarks

- The series QR1 (plastic) and QR2 (metal) can not be combined
- For further information about assembling and tolerances of adaptable tubing, see the section "Technical information".

## Dimensions

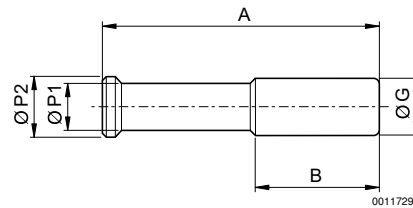

00117291

Part No.	Port G	A	B	Ø P1	Ø P2	Delivery quantity [Piece]	Weight [kg]				
<b>2123204000</b>	Ø 4	28	16	3	4	20	0.0004				
<b>2123206000</b>	Ø 6	32	17	4	6	20	0.0007				
<b>2123208000</b>	Ø 8	39	18.5	5	8	20	0.0014				
<b>2123210000</b>	Ø 10	42	21	8	10	20	0.002				
<b>2123212000</b>	Ø 12	44	22.5	8	12	20	0.0036				
<b>2123214000</b>	Ø 14	45	24.6	8	14	10	0.005				
<b>R412005331</b>	Ø16	46	24.8	10	16	10	0.004				