

Pneumatic connection technologies → Push-In fittings

Series QR1-S standard

► T-union ► external thread ► M5 - G 1/2 ► push-in fitting, 2x ► Ø 4 - Ø16 ► QR1-S-RTT



00117326

00119490

Ambient temperature min./max.
Working pressure min./max.

+0 °C / +60 °C
-0.95 bar / 10 bar

Materials:

Screw
Housing
Seal
Tooth lock washer
Release ring
Release ring holder
Thread

nickel-plated
Polybutyleneterephthalate
Acrylonitrile Butadiene Rubber
Stainless steel
Polyoxymethylene
Die cast zinc; Brass, nickel-plated
Brass, nickel-plated

Technical Remarks

- The series QR1 (plastic) and QR2 (metal) can not be combined
- Thread seal with captive O-ring
- For further information about assembling and tolerances of adaptable tubing, see the section "Technical information".

Dimensions

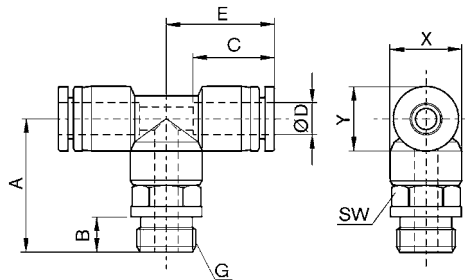

00117275

Part No.	Port G	Port D	A	B	C	E	SW	X	Y	Delivery quantity [Piece]	Weight [kg]
2122204050	M5	Ø 4	20.5	4	16	18.3	10	12	10	10	0.0111
R412005201	M5	Ø 6	21.5	5	17	20.4	12	14	12	10	0.0137
2122204180	G 1/8	Ø 4	21.6	5	16	18.1	10	12	10	10	0.0144
2122206180	G 1/8	Ø 6	21.9	5	17	20.4	12	14	12	10	0.0152
2122208180	G 1/8	Ø 8	22.5	5	18.5	22.7	14	16	14	10	0.0187
R412005205	G 1/8	Ø 10	29	5	21	26.1	17	19	17	10	0.0354
2122204140	G 1/4	Ø 4	22.6	6	16	18.1	17	12	10	10	0.0192
2122206140	G 1/4	Ø 6	23.9	6	17	20.4	17	14	12	10	0.0218
2122208140	G 1/4	Ø 8	24.5	6	18.5	22.7	17	16	14	10	0.0266
2122210140	G 1/4	Ø 10	30	6	21	26.1	17	19	17	10	0.035
R412005206	G 1/4	Ø 12	32	6	22.5	29.3	21	23	21	10	0.0504
R412005203	G 3/8	Ø 6	25.9	7	17	20.4	20	14	12	10	0.0335
2122208380	G 3/8	Ø 8	25.8	7	18.5	22.7	20	16	14	10	0.0341
2122210380	G 3/8	Ø 10	31	7	21	26.1	20	19	17	10	0.0363
2122212380	G 3/8	Ø 12	33	7	22.5	29.3	21	23	21	10	0.0519
2122214380	G 3/8	Ø 14	30.1	7	24.6	32.1	20	25	23	10	0.0507
2122210120	G 1/2	Ø 10	32.5	8.5	21	26.1	24	19	17	10	0.0574
2122212120	G 1/2	Ø 12	34.5	8.5	22.5	29.3	24	23	21	5	0.0519
2122214120	G 1/2	Ø 14	25.6	8.5	24.6	32.1	24	25	23	5	0.0503

Pneumatic connection technologies → Push-In fittings
Series QR1-S standard
► T-union ► external thread ► M5 - G 1/2 ► push-in fitting, 2x ► Ø 4 - Ø16 ► QR1-S-RTT

Part No.	Port G	Port D	A	B	C	E	SW	X	Y	Delivery quantity [Piece]	Weight [kg]
R412005209	G 1/2	Ø16	40.8	8.5	24.8	33.3	24	27	24	5	0.114