

Pneumatic connection technologies → Supplementary products

Series QR1-S standard

► Y-plug connector, reducing ► push-in fitting ► Ø1/4 - Ø5/16 ► push-in fitting, 2x ► Ø5/32 - Ø1/4 ► QR1-S-RYR

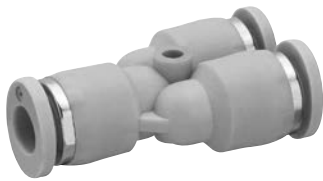

00117317

Ambient temperature min./max.

+0°C / +60°C

Working pressure min./max.

-0.95 bar / 10 bar

Materials:

Screw

nickel-plated

Housing

Polybutyleneterephthalate

Seal

Acrylonitrile Butadiene Rubber

Tooth lock washer

Stainless steel

Release ring

Polyoxymethylene

Release ring holder

Die cast zinc; Brass, nickel-plated

Technical Remarks

- The series QR1 (plastic) and QR2 (metal) can not be combined
- These pneumatic components with NPTF or inch thread dimensions are only available from our US sales organization
- For further information about assembling and tolerances of adaptable tubing, see the section "Technical information".

Dimensions in inches

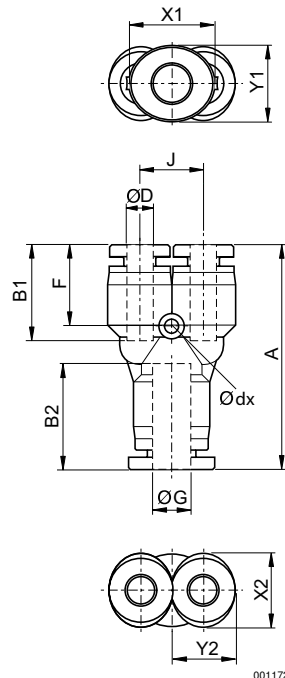

00117251

Dimensions in inches

Part No.	Port G	Port D	A	B1	B2	J	X1	X2	Y1	Y2	Delivery quantity [Piece]	Weight [kg]
R432000273	Ø1/4	Ø5/32	1.45	0.67	0.67	0.42	0.55	0.47	0.47	0.39	10	0.014
R432000276	Ø3/8	Ø5/16	1.95	0.73	0.83	0.55	0.75	0.63	0.67	0.55	10	0.018
R432000271	Ø1/2	Ø3/8	2.12	0.83	0.89	0.71	0.91	0.75	0.83	0.67	10	0.027
R432000272	Ø5/16	Ø1/4	1.6	0.67	0.73	0.47	0.63	0.55	0.55	0.47	10	0.009
R432000274	Ø3/8	Ø1/4	1.95	0.69	0.76	0.71	0.75	0.55	0.67	0.47	10	0.032

Supplementary products

Part numbers marked in bold are available from the central warehouse in Germany, see the shopping basket for more detailed information Pneumatics catalog, online PDF, as of 2013-04-11, © Bosch Rexroth AG, subject to change