

## Pneumatic connection technologies → Supplementary products

## Series QR1-S standard

► Blanking plug ► pin bushing ► Ø5/32 - Ø1/2 ► QR1-S-RBS



00136364

Ambient temperature min./max.

+0°C / +60°C

Working pressure min./max.

-0.95 bar / 10 bar

Materials:

Screw

nickel-plated

Housing

Polybutyleneterephthalate

## Technical Remarks

- The series QR1 (plastic) and QR2 (metal) can not be combined
- These pneumatic components with NPTF or inch thread dimensions are only available from our US sales organization
- For further information about assembling and tolerances of adaptable tubing, see the section "Technical information".

## Dimensions in inches

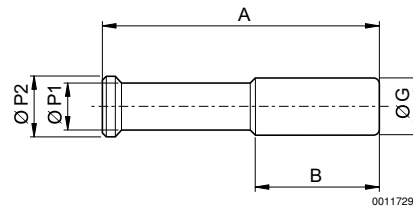

00117291

## Dimensions in inches

Part No.	Port G	A	B	Ø P1	Ø P2	Delivery quantity [Piece]	Weight [kg]				
R432002353	Ø5/32	1.1	0.63	0.12	0.16	20	0.0058				
R432002354	Ø5/16	1.65	0.73	0.28	0.39	20	0.023				
R432000050	Ø3/8	1.66	0.83	0.28	0.37	20	0.005				
R432000049	Ø1/4	1.26	0.67	0.18	0.25	20	0.005				
R432000048	Ø1/2	1.73	0.89	0.34	0.5	20	0.005				

## Supplementary products

Part numbers marked in bold are available from the central warehouse in Germany, see the shopping basket for more detailed information  
Pneumatics catalog, online PDF, as of 2013-04-11, © Bosch Rexroth AG, subject to change