

# Function Fittings, QR1 - Inch

In-line flow control valve

▲ ★ In-line flow control valve, block shape, series QR1-DBS

|                                |  |  |
|--------------------------------|--|--|
| Type                           | Cone choke                                   |  |
| Max. pressure                  | 145 psi                                      |  |
| Opening pressure (check valve) | 7 psi  |  |
| Ambient temperature range      | 32 °F to +140 °F                             |  |
| Medium                         | Compressed air, lubricated or non-lubricated |  |
| Weight                         | See table                                    |  |

|           |                  |                      |
|-----------|------------------|----------------------|
| Materials | Body             | PBT                  |
|           | Seals            | NBR                  |
|           | Throttling screw | Brass, nickel-plated |

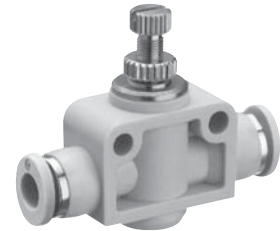

▲ ★ Part no.

|  | Ø D  | Weight [lbs] | Per pack | Part no.   |
|--|------|--------------|----------|------------|
|  | 5/32 | 0.03         | 5        | R432002382 |
|  | 1/4  | 0.06         | 5        | R432002383 |
|  | 5/16 | 0.09         | 5        | R432002384 |
|  | 3/8  | 0.15         | 5        | R432002385 |
|  | 1/2  | 0.24         | 5        | R432002386 |

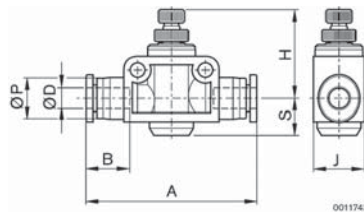

| Part no.   | Ø D  | A     | B     | J     | H     | S     | Ø P   |
|------------|------|-------|-------|-------|-------|-------|-------|
| R432002382 | 5/32 | 1.426 | 0.63  | 0.394 | 0.701 | 0.256 | 0.411 |
| R432002383 | 1/4  | 1.682 | 0.67  | 0.591 | 1.064 | 0.433 | 0.489 |
| R432002384 | 5/16 | 2.041 | 0.729 | 0.709 | 1.123 | 0.473 | 0.567 |
| R432002385 | 3/8  | 2.348 | 0.827 | 0.827 | 1.34  | 0.473 | 0.693 |
| R432002386 | 1/2  | 2.813 | 0.887 | 1.103 | 1.32  | 0.63  | 0.835 |

Dimensions in inches