

3271

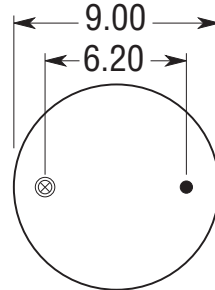

9543/NAD-25424

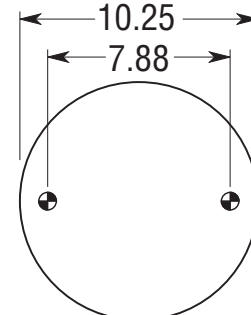

(use)

Order No. WC1-358-9453 (AL)

Hardware Key

● Bolt or Stud 1/2-13 ◐ Threaded Hole 3/8-16 Blind Nut on Bead Plates 1/2-13 in Pistons ⊗ Air Inlet 1/4 N.P.T. ★ See Piston Index ▲ No alignment specified-center stud mounting is standard
 ⊗ Combination Stud/Air Inlet Stud Outside Thread is 3/4-16 Studs Inside Thread (Air Inlet) is 1/4 N.P.T. Exceptions will be noted on Part View as ⊗

TECHNICAL DATA -

Order Number:	W01-358-9394
Bellows #:	1T15M-9
Assembly Weight:	16.5 lbs
Design Height:	15-19 inches
Minimum Jounce Height:	9.2 inches
Maximum Rebound Height:	24.94 inches
Loading Capacity at 20 psig:	1,440 lbsf
Loading Capacity at 60 psig:	4,320 lbsf
Loading Capacity at 90 psig:	6,480 lbsf
Natural Frequency:	Hz
Maximum Diameter:	12.5 inches
Material Type:	Natural Rubber
Operating Temperature:	57C° to -54C°
Remarks:	FRP

TR: C-2988

* REFERENCE DATA ONLY

This information is a general guide to the characteristics of this product. The material was developed through engineering design and development, testing and actual applications and is believed to be reliable and accurate. Firestone, however makes no warranty, express or implied of this information. Anyone making use of this material does so at his own risk and assumes all liability resulting from such use. It is suggested that competent professional assistance be employed for specific applications.
 FRP