

GENUINE GRACO PARTS & ACCESSORIES

238761 Repair Kit

For 1:1 Fast-Ball Pumps



Important Safety Instructions

Read all warnings and instructions in this manual.
Save these instructions.

406345C

- △1 Torque to 10–14 in-lb (1.3–1.6 N•m).
- △2 Torque to 40–60 ft-lb (54–81 N•m).
- △3 Torque to 23 ft-lb (31.2 N•m).
- △4 Torque to 95–105 ft-lb (129–142 N•m).
- △5 Lips face up.
- △6 Lips face down.

* For series B pumps only.
† For series C & D pumps only.

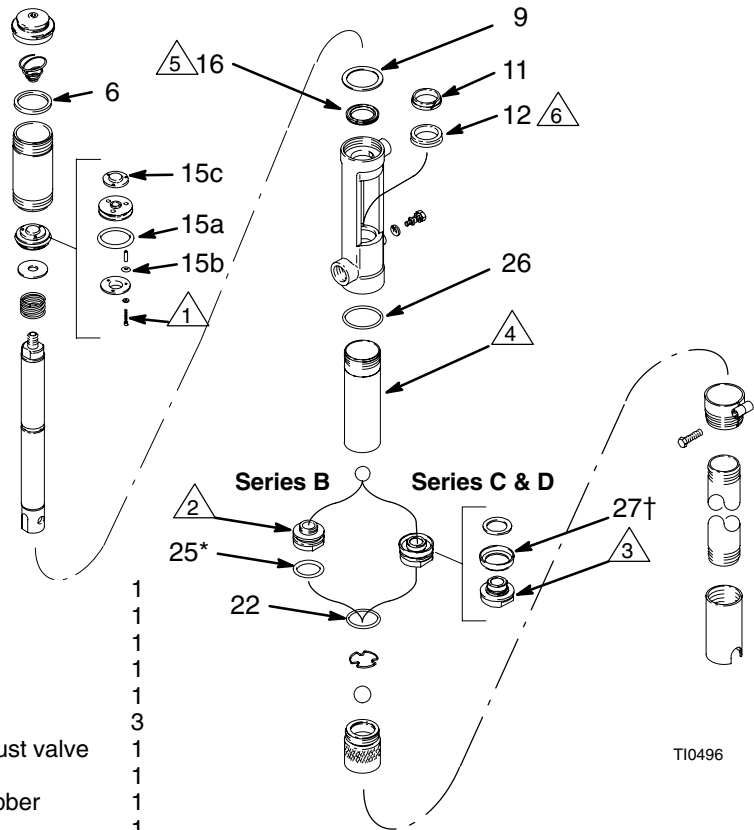

6	162989	GASKET	1
9	158109	GASKET	1
11	185428	RING, wiper	1
12	110247	SEAL	1
15a	108357	. O-RING	1
15b	108358	. O-RING	3
15c	162729	. PLATE, air exhaust valve	1
16	110153	SEAL, shaft	1
22	156633	O-RING; nitrile rubber	1
25*	113423	O-RING, packing	1
26	156641	O-RING; buna-N	1
27†	116152	CUP, piston	1

T10496

GRACO INC. / P.O. BOX 1441 / MINNEAPOLIS, MN 55440-1441
406345 Rev. C 06/2006