

Repair Parts for XP Xtreme™ 58cc Lower

406881E
EN



Important Safety Instructions

Read all warnings and instructions in manual 311762. Save those instructions.

25D241 Full Repair Kit - PTFE
Chemical Resistance and Higher Temperatures

25D252 Full Repair Kit - Graco Formulated UHMWPE/PTFE
Chemical Resistance and Durability in Applications Below 140° F (60° C)

Bulk Pack Replacement Parts

Ref.	Part	Description	Qty.
103*	---	THROAT PACKINGS	1
104*	---	PISTON PACKINGS	5
109*	288067	O-RING, PTFE, top cylinder (10/pack)	1
112*	262485	BALL, piston, (3/pack)	1
116*	244899	BALL, inlet, (3/pack)	1
117	288064	SHIM, inlet, ball guide (9/pack)	2
119*	247393	PLUG, throat seal (10/pack)	1
122*	244895	O-RING, filter; thin, PTFE (10/pack)	1
123	224458	STRAINER, 30 mesh screen (2/pack)	1
	238436	STRAINER, 30 mesh screen (25/pack)	1
125*	262484	O-RING, filter; medium, PTFE (10/pack)	1
127*	288068	O-RING, PTFE (10/pack)	2
132*	262512	O-RING, PTFE, cartridge and cylinder bottom	2
143*	124007	SPRING, foot valve	1
159*	262483	O-RING, filter, thick; PTFE (10 pack)	1

* Included in Full Repair Kits.

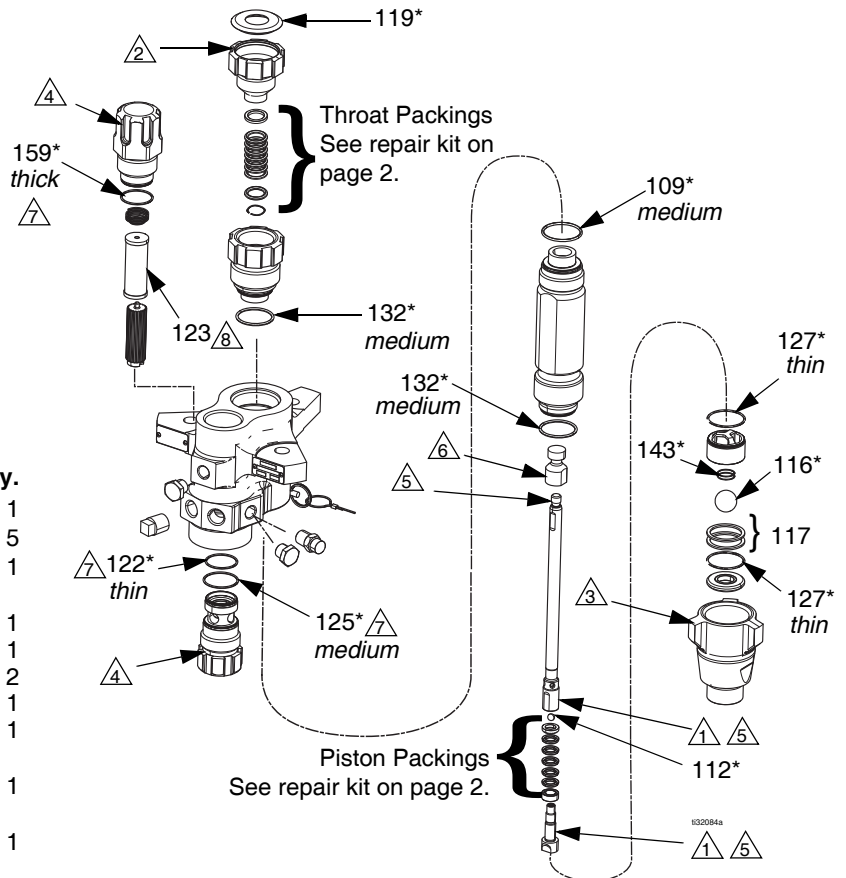

- Ⓐ Torque to 85 ft-lb (115 N•m).
- Ⓑ Torque to 75 ft-lb (101 N•m).
- Ⓒ Torque to 135-150 ft-lb (183-203 N•m).
- Ⓓ Torque to 40-60 ft-lb (52-82 N•m).
- Ⓔ Apply lubricant to threads before assembly.
- Ⓕ Torque to 30-40 ft-lb (40-54 N•m).
- Ⓖ Lubricate.
- Ⓗ Pumps with short filters can be upgraded with kit 24F975.

Full Repair Kit - PTFE - 25D241*

(*Includes items shown on front page)

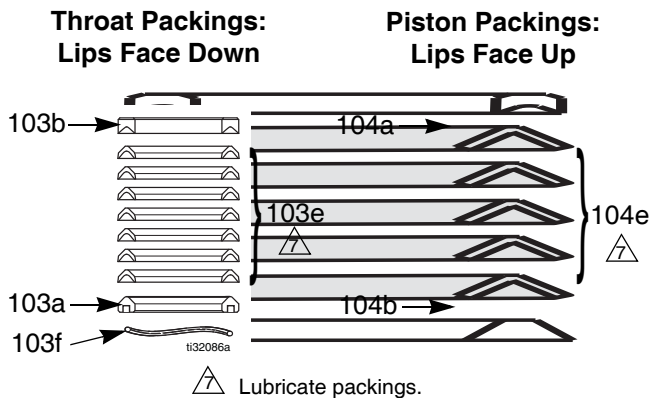

Throat Seal Repair Kit - PTFE - 25D148

Includes:

Ref.	Description	Qty.
103a	GLAND, male, throat	1
103b	GLAND, female, throat	1
103e	V-PACKING, PTFE, throat (white)	7
103f	WAVE SPRING	1

Piston Seal Repair Kit - PTFE - 25D158

Includes:

Ref.	Description	Qty.
104a	GLAND, male, piston	1
104b	GLAND, female, piston	1
104e	V-PACKING, PTFE, piston (white)	5

Full Repair Kit - Graco Formulated UHMWPE/PTFE - 25D252*

(*Includes items shown on front page)

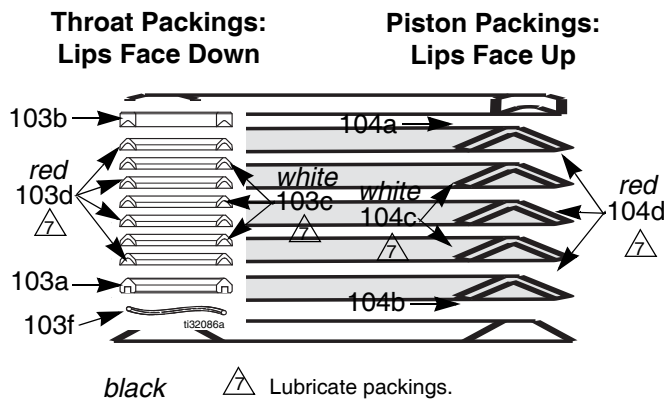

Throat Seal Repair Kit - Graco Formulated UHMWPE/PTFE - 25D169

Includes:

Ref.	Description	Qty.
103a	GLAND, male, throat	1
103b	GLAND, female, throat	1
103c	V-PACKING, PTFE, throat (white)	3
103d	V-PACKING, UHMWPE, throat (red)	4
103f	WAVE SPRING	1

Piston Seal Repair Kit - Graco Formulated UHMWPE/PTFE - 25D183

Includes:

Ref.	Description	Qty.
104a	GLAND, male, piston	1
104b	GLAND, female, piston	1
104c	V-PACKING, PTFE, piston (white)	2
104d	V-PACKING, UHMWPE, piston (red)	3

All written and visual data contained in this document reflects the latest product information available at the time of publication. Graco reserves the right to make changes at any time without notice.

For patent information, see www.graco.com/patents.

Original instructions. This manual contains English. MM 406881

Graco Headquarters: Minneapolis

International Offices: Belgium, China, Japan, Korea

GRACO INC. AND SUBSIDIARIES • P.O. BOX 1441 • MINNEAPOLIS MN 55440-1441 • USA

Copyright 2010, Graco Inc. All Graco manufacturing locations are registered to ISO 9001.

www.graco.com

Revision E, September 2018