



# Merkur<sup>®</sup> Seal Repair Kits

407053B

For High Pressure Merkur X72 Displacement Pump 16U916

EN



**Important Safety Instructions**  
Read all warnings and instructions in manuals Merkur High Pressure Sprayer and Displacement Pump manuals. Save all instructions.

1 Lubricate.

2 Torque to 54-66 ft-lb (73-89 N•m)

3 Torque to 54-66 ft-lb (73-89 N•m)

4 Torque to 90.5-109.5 ft-lb (123-149 N•m)

5 Apply thread lubricant.

See reverse for parts.

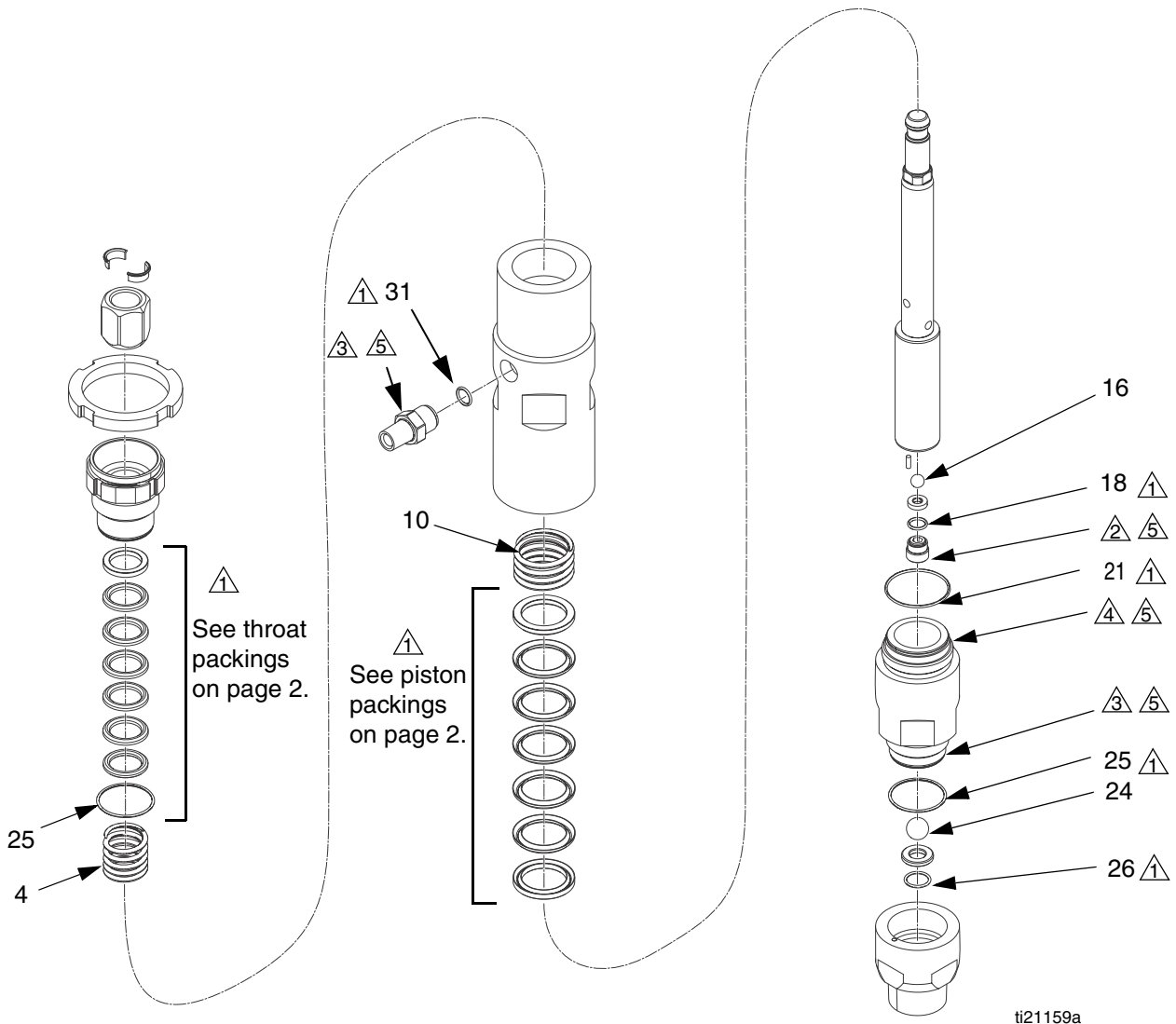

Ref.	Description	Qty.
4	SPRING, throat	1
6	GLAND, male, throat	1
7	PACKING, throat, UHMWPE	3
8	PACKING, throat, PTFE	2
9	GLAND, female, throat	1
10	SPRING, piston	1
11	GLAND, male, piston	1
12	PACKING, piston, UHMWPE	3
13	PACKING, piston, PTFE	2
14	GLAND, female, piston	1
16	BALL, piston valve, sst	1
18	O-RING, piston, 0.57 in. (14.4 mm) OD	1
19	PACKING, throat, reinforced PTFE	5
20	PACKING, piston, reinforced PTFE	5
21	O-RING, lower cylinder, 1.8 in. (46 mm) OD	1
24	BALL, intake valve, sst	1
25	O-RING, lower cylinder, 1.6 in. (41 mm) OD	2
26	O-RING, inlet check, 0.75 in. (19 mm) OD	1
31	O-RING, outlet fitting, 0.59 in. (14.9 mm) OD	1

**TIP:** Some o-rings are close in size. Stack on bench to differentiate.

## Standard Seal Repair Kit 24A252

### Throat Packings: Lips Face Down

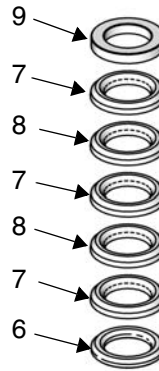

### Piston Packings: Lips Face Up

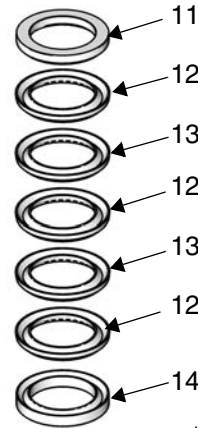

ti17306a

**Lubricate Packings**

## Optional Reinforced PTFE Seal Kit 24J853

Use with materials that cause chemical compatibility concerns with UHMWPE, such as acid catalyst materials.

### Throat Packings: Lips Face Down

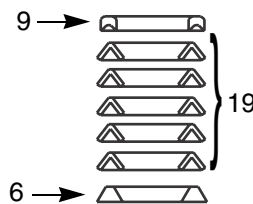

### Piston Packings: Lips Face Up

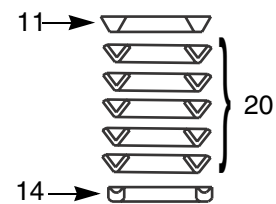

**Lubricate Packings**

All written and visual data contained in this document reflects the latest product information available at the time of publication. Graco reserves the right to make changes at any time without notice.

For patent information, see [www.graco.com/patents](http://www.graco.com/patents).

Original instructions. This manual contains English. MM 407053

**Graco Headquarters:** Minneapolis

**International Offices:** Belgium, China, Japan, Korea

**GRACO INC. AND SUBSIDIARIES • P.O. BOX 1441 • MINNEAPOLIS MN 55440-1441 • USA**  
**Copyright 2013, Graco Inc. All Graco manufacturing locations are registered to ISO 9001.**

[www.graco.com](http://www.graco.com)