

# Low Pressure Fluid Filters

311775G

EN

**For filtering large volumes of industrial paints and other industrial fluids. For professional use only.**

*See page 3 for model numbers.*

*500 psi (3.5 MPa, 35 bar) Maximum Working Pressure.*



**Important Safety Instructions**

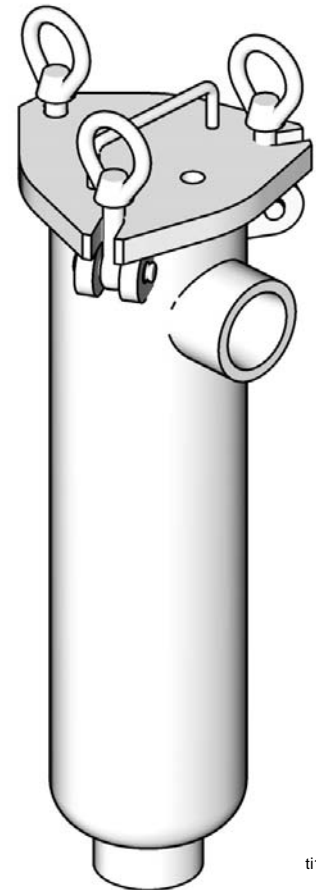

Read all warnings and instructions in this manual.  
Save these instructions.



ti10097a

# Warnings

The following warnings are for the setup, use, grounding, maintenance, and repair of this equipment. The exclamation point symbol alerts you to a general warning and the hazard symbols refer to procedure-specific risks. When these symbols appear in the body of this manual, refer back to these Warnings. Product-specific hazard symbols and warnings not covered in this section may appear throughout the body of this manual where applicable.

 <b>WARNING</b>	
	<p><b>EQUIPMENT MISUSE HAZARD</b></p> <p>Misuse can cause death or serious injury.</p> <ul style="list-style-type: none"> <li>• Do not operate the unit when fatigued or under the influence of drugs or alcohol.</li> <li>• Do not exceed the maximum working pressure or temperature rating of the lowest rated system component. See <b>Technical Data</b> in all equipment manuals.</li> <li>• Use fluids and solvents that are compatible with equipment wetted parts. See <b>Technical Data</b> in all equipment manuals. Read fluid and solvent manufacturer's warnings. For complete information about your material, request MSDS forms from distributor or retailer.</li> <li>• Check equipment daily. Repair or replace worn or damaged parts immediately with genuine manufacturer's replacement parts only.</li> <li>• Do not alter or modify equipment.</li> <li>• Use equipment only for its intended purpose. Call your distributor for information.</li> <li>• Route hoses and cables away from traffic areas, sharp edges, moving parts, and hot surfaces.</li> <li>• Do not kink or over bend hoses or use hoses to pull equipment.</li> <li>• Keep children and animals away from work area.</li> <li>• Comply with all applicable safety regulations.</li> </ul>
	<p><b>PRESSURIZED EQUIPMENT HAZARD</b></p> <p>Fluid from the gun/dispense valve, leaks, or ruptured components can splash in the eyes or on skin and cause serious injury.</p> <ul style="list-style-type: none"> <li>• Follow <b>Pressure Relief Procedure</b> in this manual, when you stop spraying and before cleaning, checking, or servicing equipment.</li> <li>• Tighten all fluid connections before operating the equipment.</li> <li>• Check hoses, tubes, and couplings daily. Replace worn or damaged parts immediately.</li> </ul>

# Models

Part	Model	Filter Area	Inlet/Outlet Fittings	Maximum Delivery gpm (lpm)	Material
916934	6	0.5 sq ft	3/4 npt (f)	15 (57)	Stainless steel
915515	6	0.5 sq ft	1-1/4 npt (f)	15 (57)	Carbon steel
915516*	6	0.5 sq ft	1-1/4 npt (f)	15 (57)	Stainless steel
96A504*	6	0.5 sq ft	1-1/4 npt (f)	15 (57)	Stainless steel
915517	12	1.0 sq ft	1-1/2 npt (f)	30 (114)	Carbon steel
915518*	12	1.0 sq ft	1-1/2 npt (f)	30 (114)	Stainless steel
916366*	12	1.0 sq ft	1-1/2 npt (f)	30 (114)	Stainless steel

\* Waterborne compatible

# Dimensions

Part No.	Width (A)	Length (B)	Threads (C)	Length (D)
916934	4.5 in. 114.3 mm	10.5 in. 266.7 mm	3/4 NPT	(6.0 in.) (152.4 mm)
915515	4.5 in. 114.3 mm	9.5 in. 241.3 mm	1-1/4 NPT	(6.0 in.) (152.4 mm)
915516	4.5 in. 114.3 mm	9.5 in. 241.3 mm	1-1/4 NPT	(6.0 in.) (152.4 mm)
96A504	4.5 in. 114.3 mm	9.5 in. 241.3 mm	1-1/4 NPT	(6.0 in.) (152.4 mm)
915517	4.5 in. 114.3 mm	15.5 in. 393.7 mm	1-1/2 NPT	(6.0 in.) (152.4 mm)
915518	4.5 in. 114.3 mm	15.5 in. 393.7 mm	1-1/2 NPT	(6.0 in.) (152.4 mm)
916366	4.5 in. 114.3 mm	15.5 in. 393.7 mm	1-1/2 NPT	(6.0 in.) (152.4 mm)

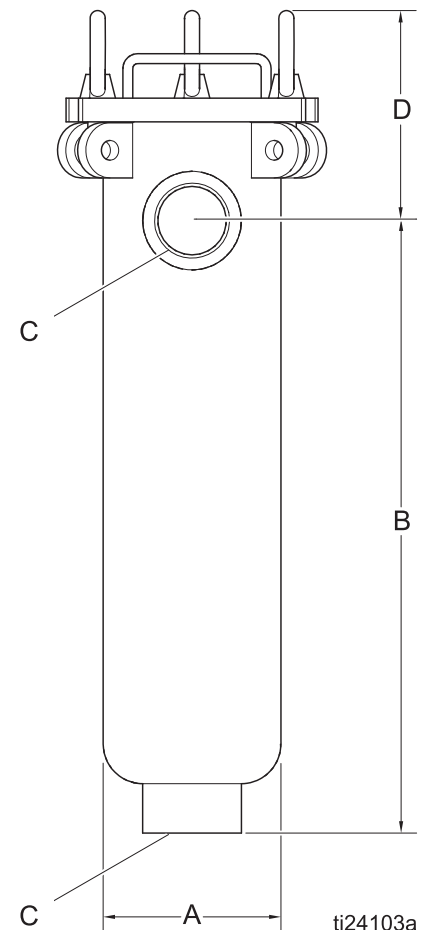

## Installation

**NOTE:** Reference numbers and letters in parentheses in the text refer to the callouts in the parts drawing. (See page 5.)

1. Connect the inlet line to the inlet (A) on the side of the filter.
2. Connect the outlet line to the outlet (B) on the bottom of the filter.

**NOTE:** The 1/4 npt port in the cover of the filter can remain plugged or be used for pressure gauges or special fittings.

3. Some installations require electrical grounding of all equipment. Follow your local electrical code.
4. Remove cover by loosening the cover eye-nuts (3). Loosen the eye-nuts in the slotted corners so the bolts swing down. Loosen the third eye-nut so the top cover can swing open.
5. Put basket (2) into filter housing. Make sure the basket flange is seated firmly on top of the basket collar.
6. Put bag into the bag basket. Be sure the filter bag ring is seated firmly on top of the basket flange. For best results, be sure the filter bag extends to the bottom of the basket.
7. Make sure that the cover gasket groove is clean and free of debris. Put in cover seal gasket (1).

**NOTE:** If the cover has ever been tightened down, the cover seal gasket must be replaced.

8. Close cover and alternately tighten the three clamp assemblies (by small increments) to a recommended torque of 30-45 ft-lb (40-60 N•m).

## Operation

Prior to turning on the flow to the inlet, check the following:

1. Be sure a basket and filter bag (if applicable) are in place. Clean or replace as necessary.
2. Be sure the filter cover is securely fastened to housing.

Slowly open the inlet line to approximately 25% of normal operational flow. When the filter is pressurized and vented, slowly open outlet line valve until completely open. Open inlet line to reach desired flow rate.

### NOTICE

Inlet pressure must not exceed outlet pressure by more than 15 psi (0.1 MPa, 1 bar). Operating the filter with a high differential may cause filter bags to rupture, causing damage to filter system and downstream equipment.

To prevent excessive drop through the filter, regularly inspect the basket and filter bag. Monitor the differential pressure through the filter to determine whether the basket or filter bag needs to be cleaned or replaced.

# Service



## PRESSURIZED EQUIPMENT HAZARD

Before removing, cleaning, or servicing the filter, close the inlet and outlet ball valves and open the fluid drain valve to relieve pressure.

1. Relieve all fluid pressure from the system. See the **Warning** above and your pump/sprayer manual.

**NOTE:** In some applications, closing outlet valve is not required.

2. Drain housing sufficiently to access filter basket (2).
3. Remove cover by loosening the cover eye-nuts (3). Loosen the eye-nuts in the slotted corners so the bolts swing down. Loosen the third eye-nut so the top cover can swing open.
4. Remove filter basket (2) and clean thoroughly.
5. Remove the filter bag (if applicable, not shown) and throw away. (Cleaning and reusing the filter bag is not recommended.)
6. Thoroughly clean the inlet (A) to avoid interference with cover seal or fluid flow.
7. Remove basket seal (if applicable) and inspect. Replace if necessary.
8. Install clean filter basket and filter bag (if applicable). Put basket (2) into filter housing. Make sure the basket flange is seated firmly on top of the basket collar. Put bag into the bag basket. Be sure the filter bag ring is seated firmly on top of the basket flange. For best results, be sure the filter bag extends to the bottom of the basket.
9. Make sure that the cover gasket groove is clean and free of debris. Replace cover seal gasket (1).

**NOTE:** If the cover has ever been tightened down, the cover seal gasket must be replaced.

10. Close cover and alternately tighten the three clamp assemblies (by small increments) to a recommended torque of 30-45 ft-lb (40-60 N•m).

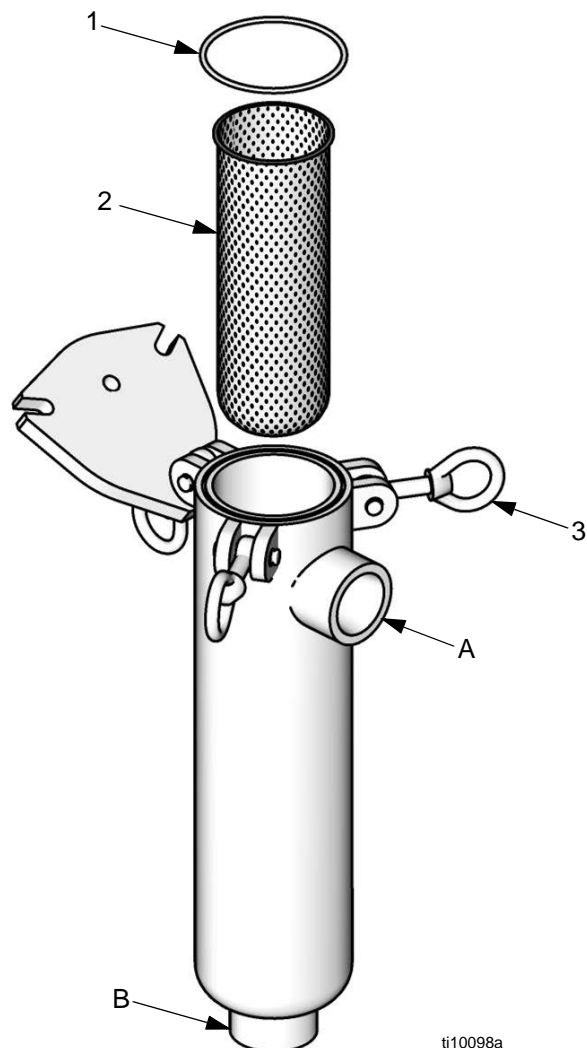

ti10098a

## Replacement Parts

Ref.	Part Number		Description
	Model 6	Model 12	
1	521691	521691	Gasket, PTFE encapsulated fluoroelastomer
2	521268	521276	Bag filter basket, perforated stainless steel, standard with complete assemblies
	521273	521280	Strainer basket, perforated stainless steel with 100 mesh liner
3	521306	521306	Eye-bolt and nut

## Replacement Filter Bags

Part Number		Material	Micron size.
Model 6 (15 gpm)	Model 12 (30 gpm)		
521312	--	Glazed polyester felt without cover	10
521316	--		75
521317	--		100
521183	--	Glazed polyester felt, spun bonded nylon cover	5
521184	--		10
521186	521177		25
521187	521178		50
--	521179		75
--	521180		100
--	521342		Glazed polyester felt, nylon multi-filament mesh cover
--	521344	25	
521335	--	50	
521336	--	75	
521337	--	100	
521212	521240	Glazed polyester felt, nylon mono-filament mesh cover	
521213	--		10
521215	--		25
521216	521244		50
521217	521245		75
521218	521246		100
521226	521254		Nylon monofilament mesh
521227	521255	10	
521228	521256	25	
521229	521257	50	
521230	521258	75	
521231	521259	100	
521232	521260	125	
521233	521261	150	
521234	521262	200	
521235	521263	250	
521236	521264	300	

# Accessories

## Pressure Gauge

2-1/2 in dial bourdon tube pressure gauge; range 0-200 psi (0-1.4 MPa, 1-14 bar); with pulsation dampener and diaphragm seal.

Part Number (Models 6 and 12)	Description
206171	carbon steel, 1/4 npt(f), bottom inlet
208855	stainless steel, 1/4 npt(m), bottom inlet

## Ball Valve

For drain or air blowdown; 500 psi (3.5 MPa, 35 bar)

Part Number (Models 6 and 12)	Description
208390	carbon steel, 1/4 x 1/4 npt (mbe)
208393	carbon steel, 3/8 x 3/8 npt (mbe)
237534	stainless steel, 3/8 x 3/8 npt (m x f)

**NOTE:** To order complete fluid filter assembly, see **Models** on page 3.

# Graco Standard Warranty

Graco warrants all equipment referenced in this document which is manufactured by Graco and bearing its name to be free from defects in material and workmanship on the date of sale to the original purchaser for use. With the exception of any special, extended, or limited warranty published by Graco, Graco will, for a period of twelve months from the date of sale, repair or replace any part of the equipment determined by Graco to be defective. This warranty applies only when the equipment is installed, operated and maintained in accordance with Graco's written recommendations.

This warranty does not cover, and Graco shall not be liable for general wear and tear, or any malfunction, damage or wear caused by faulty installation, misapplication, abrasion, corrosion, inadequate or improper maintenance, negligence, accident, tampering, or substitution of non-Graco component parts. Nor shall Graco be liable for malfunction, damage or wear caused by the incompatibility of Graco equipment with structures, accessories, equipment or materials not supplied by Graco, or the improper design, manufacture, installation, operation or maintenance of structures, accessories, equipment or materials not supplied by Graco.

This warranty is conditioned upon the prepaid return of the equipment claimed to be defective to an authorized Graco distributor for verification of the claimed defect. If the claimed defect is verified, Graco will repair or replace free of charge any defective parts. The equipment will be returned to the original purchaser transportation prepaid. If inspection of the equipment does not disclose any defect in material or workmanship, repairs will be made at a reasonable charge, which charges may include the costs of parts, labor, and transportation.

**THIS WARRANTY IS EXCLUSIVE, AND IS IN LIEU OF ANY OTHER WARRANTIES, EXPRESS OR IMPLIED, INCLUDING BUT NOT LIMITED TO WARRANTY OF MERCHANTABILITY OR WARRANTY OF FITNESS FOR A PARTICULAR PURPOSE.**

Graco's sole obligation and buyer's sole remedy for any breach of warranty shall be as set forth above. The buyer agrees that no other remedy (including, but not limited to, incidental or consequential damages for lost profits, lost sales, injury to person or property, or any other incidental or consequential loss) shall be available. Any action for breach of warranty must be brought within two (2) years of the date of sale.

**GRACO MAKES NO WARRANTY, AND DISCLAIMS ALL IMPLIED WARRANTIES OF MERCHANTABILITY AND FITNESS FOR A PARTICULAR PURPOSE, IN CONNECTION WITH ACCESSORIES, EQUIPMENT, MATERIALS OR COMPONENTS SOLD BUT NOT MANUFACTURED BY GRACO.** These items sold, but not manufactured by Graco (such as electric motors, switches, hose, etc.), are subject to the warranty, if any, of their manufacturer. Graco will provide purchaser with reasonable assistance in making any claim for breach of these warranties.

In no event will Graco be liable for indirect, incidental, special or consequential damages resulting from Graco supplying equipment hereunder, or the furnishing, performance, or use of any products or other goods sold hereto, whether due to a breach of contract, breach of warranty, the negligence of Graco, or otherwise.

## **FOR GRACO CANADA CUSTOMERS**

The Parties acknowledge that they have required that the present document, as well as all documents, notices and legal proceedings entered into, given or instituted pursuant hereto or relating directly or indirectly hereto, be drawn up in English. Les parties reconnaissent avoir convenu que la rédaction du présente document sera en Anglais, ainsi que tous documents, avis et procédures judiciaires exécutés, donnés ou intentés, à la suite de ou en rapport, directement ou indirectement, avec les procédures concernées.

# Graco Information

For the latest information about Graco products, visit [www.graco.com](http://www.graco.com).

For patent information, see [www.graco.com/patents](http://www.graco.com/patents).

**TO PLACE AN ORDER**, contact your Graco distributor or call to identify the nearest distributor.

**Phone:** 612-623-6921 **or Toll Free:** 1-800-328-0211 **Fax:** 612-378-3505

*All written and visual data contained in this document reflects the latest product information available at the time of publication.  
Graco reserves the right to make changes at any time without notice.*

Original instructions. This manual contains English. MM 311775

**Graco Headquarters:** Minneapolis

**International Offices:** Belgium, China, Japan, Korea

**GRACO INC. AND SUBSIDIARIES • P.O. BOX 1441 • MINNEAPOLIS MN 55440-1441 • USA**

**Copyright 2007, Graco Inc. All Graco manufacturing locations are registered to ISO 9001.**

[www.graco.com](http://www.graco.com)

Revision G, July 2016