

Tube and Pipe Fittings

These quality-produced tube and pipe fittings are designed for use with GRACO® lubricating systems. All dimensions are in inches. For millimeter equivalents, convert fraction to a decimal and multiply by 25.4.

STEEL PIPE FITTINGS

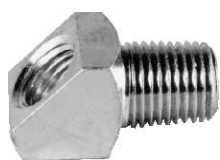

45° STREET ELBOWS - STEEL		
Description	Part No.	Old Part No.
1/8 female, 1/8 male threads	557395	509-111-000
1/4 female, 1/4 male threads	560532	509-114-000



90° STREET ELBOWS - STEEL		
Description	Part No.	Old Part No.
1/8 female, 1/8 male threads	15K783	509-110-000
1/4 female, 1/8 male threads	560530	509-112-000
1/4 female, 1/4 male threads	15M045	509-113-000
1/8 female, 1/4 male threads	560533	509-115-001
1/4 female, 3/8 male threads	Disc.	509-116-000
3/8 female, 3/8 male threads	560534	509-117-000

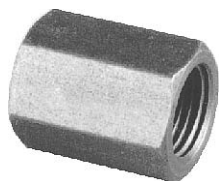

HEXAGON COUPLING - STEEL		
Description	Part No.	Old Part No.
1/8 pipe thread	560528	509-026-000



REDUCING BUSHING - STEEL		
Description	Part No.	Old Part No.
1/4 male, 1/8 female thread	556402	412-170-010



REDUCING ADAPTER - STEEL		
Description	Part No.	Old Part No.
1/4 female, 1/8 male pipe	556416	412-330-200

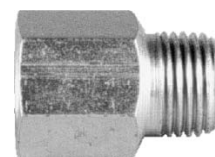

1/8 THREAD PIPE EXTENSION NIPPLES - STEEL		
Description	Part No.	Old Part No.
3/4 overall length	557392	509-027-000
1-1/4 overall length	557393	509-028-000
2-1/4 overall length	563178	509-020-000



HEX SHOULDER NIPPLES - STEEL		
Description	Part No.	Old Part No.
Straight, 1/4 x 1/4 threads	555453	412-230-020
Reducing, 1/4 x 1/8 threads	556408	412-230-030

2-PIECE FLARED TUBE FITTINGS

For use only with copper and steel tubing. Order tube nuts and elbows separately.



37° FLARE MALE ELBOWS - STEEL

Description	Part No.	Old Part No.
1/4 tube size, 1/4 pipe thread	556764	441-080-030
3/8 tube size, 1/4 pipe thread	556765	441-080-050



TUBE NUTS - BRASS

Description	Part No.	Old Part No.
1/4 tube size	-	441-060-020
3/8 tube size	555748	441-060-030

3 - PIECE COMPRESSION TUBE FITTINGS

For use with copper and nylon tubing. Furnished with nut and sleeve.



MALE CONNECTORS - BRASS

Description	Part No.	Old Part No.
3/16 tube size, 1/8 pipe thread	558694	435-360-010
1/4 tube size, 1/8 pipe thread	556632	435-360-020
1/4 tube size, 1/4 pipe thread	556633	435-360-030

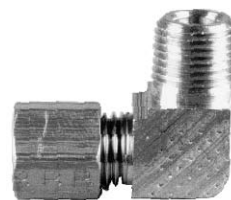

MALE ELBOWS - BRASS

Description	Part No.	Old Part No.
3/16 tube size, 1/8 pipe thread	Disc.	435-370-010
1/4 tube size, 1/8 pipe thread	556634	435-370-020
1/4 tube size, 1/4 pipe thread	555726	435-370-030



STRAIGHT UNION - BRASS

Description	Part No.	Old Part No.
3/16 tube size	Disc.	435-700-230



SPARE SLEEVES - BRASS

Description	Part No.	Old Part No.
3/16 tube size	555727	435-380-010
1/4 tube size	556635	435-380-020

3 - PIECE FLARED TUBE FITTINGS

For use only with copper and steel tubing. Furnished with nuts and sleeves.

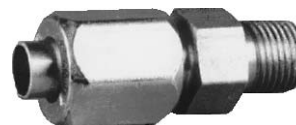

MALE CONNECTOR - STEEL

Description	Part No.	Old Part No.
1/4 tube size, 1/8 pipe size	Disc.	441-010-030

All written and visual data contained in this document are based on the latest product information available at the time of publication. Graco reserves the right to make changes at any time without notice.

Contact us today!

To receive product information or talk with a Graco representative, call 800-533-9655 or visit us online at www.graco.com.

