

# TAC FITTINGS

For Nylon Tubes, Urethane Tubes,  
and Pipe threads

- Compact fitting series for all kinds of compact equipment.
- Wide selection of compact fittings.
- Dedicated nylon tubes are available.

## Types and Specifications

### Common specifications



Media	Air	
Operating pressure range	MPa [psi.]	0~0.9 [0~131] <sup>Note</sup>
Proof pressure	MPa [psi.]	1.35 [196] <sup>Note</sup>



Note: Always check the specifications of tubes used.



Remark: For the SUS and NCU specifications, see p.351.

- The recommended tightening torques for thread sizes M3×0.5 and M5×0.8 are 0.6N·m [5.3in·lbf] and 1.6N·m [14.2in·lbf].

### Fittings for nylon tubes

Name and type		Straight (barb fitting)								
										
Model		BF3.2-M3	BF4-M3	BF3.2	BF4	BF5	BF6	PBF3.2	PBF5	PBF6
Port size		M3×0.5 (male thread)			M5×0.8 (male thread)			R1/8 (male thread)		
Applicable tube O.D.×I.D.mm		3.2×2.4	4×2.5	3.2×2.4	4×2.5	5×3	6×4	3.2×2.4	5×3	6×4
Effective area mm <sup>2</sup>		1.0		1.7		2.0	3.6	1.8	2.2	3.9
Operating temperature range °C [°F]		0~60 [32~140]								
Material		Stainless steel			Brass (nickel plated)					
Mass g [oz.]		0.7 [0.025]		1.3 [0.046]	1.6 [0.056]	1.4 [0.049]	1.5 [0.053]	5.3 [0.187]	5.4 [0.190]	5.5 [0.194]
Remark	Attachment	With 1 gasket						—		
	Sales unit	1 pack (10 pcs.)						1 pack (5 pcs.)		

Name and type		Straight (clamp fitting)								
										
Model		BF3.2N	BF4N	BF5N	BF6N	BF3.2N-01	BF4N-01	BF5N-01	BF6N-01	
Port size		M5×0.8 (male thread)				R1/8 (male thread)				
Applicable tube O.D.×I.D.mm		3.2×2.4	4×2.5	5×3	6×4	3.2×2.4	4×2.5	5×3	6×4	
Effective area mm <sup>2</sup>		1.6	2.0	2.7	3.2	1.6	2.1	2.7	3.6	
Operating temperature range °C [°F]		0~60 [32~140]								
Material		Brass (nickel plated)								
Mass g [oz.]		5.0 [0.176]	4.5 [0.159]	5.0 [0.176]	4.0 [0.141]	10.5 [0.370]	10.0 [0.353]	9.5 [0.335]		
Remark	Attachment	With 1 gasket				—				
	Sales unit	1 pack (10 pcs.)								

Name and type		Universal elbow (barb fitting)						Universal elbow (clamp fitting)		
										
Model		UEF3.2-M3	UEF4-M3	UEF3.2	UEF4	UEF5	UEF6	UEF4N	UEF5N	UEF6N
Port size		M3×0.5 (male thread)		M5×0.8 (male thread)			M5×0.8 (male thread)			
Applicable tube O.D.×I.D.mm		3.2×2.4	4×2.5	3.2×2.4	4×2.5	5×3	6×4	4×2.5	5×3	6×4
Effective area mm <sup>2</sup>		0.5		1.2			1.5	1.3	1.4	1.5
Operating temperature range °C [°F]		0~60 [32~140]								
Material		Body : Brass (nickel plated) Thread : Stainless steel		Brass (nickel plated)			Brass (nickel plated)			
Mass g [oz.]		1.7 [0.060]	1.8 [0.063]	5.4 [0.190]	5.5 [0.194]	5.7 [0.201]	5.9 [0.208]	13.0 [0.459]		
Remark	Attachment	With 2 gaskets						With 2 gaskets		
	Sales unit	1 pack (5 pcs.)						1 pack (5 pcs.)		

# Dimensions (mm)

## Straight

Remark: Models with -HN come without a holder.

### ●BF2BU-M3 (-HN)

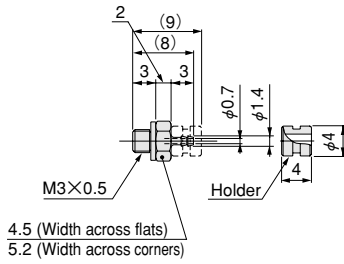

4.5 (Width across flats)  
5.2 (Width across corners)

### ●BF2BU (-HN)

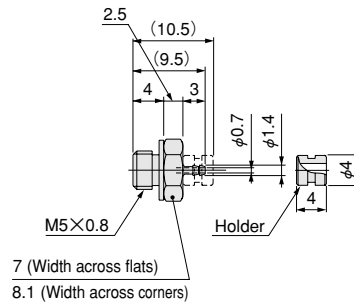

7 (Width across flats)  
8.1 (Width across corners)

## Straight (barb fitting)



### ●BF□-M3

### ●BF□BU-M3

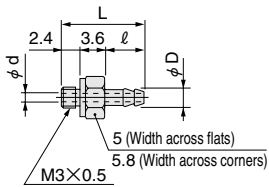

5 (Width across flats)  
5.8 (Width across corners)

Model	D	d	L	l
BF3BU-M3	2.0	0.8	10	4
BF3.2-M3	2.6	1.2	11	5
BF4-M3	2.9	1.2	11	5
BF4BU-M3	3.2	1.2	11	5

### ●BF4

### ●BF□BU

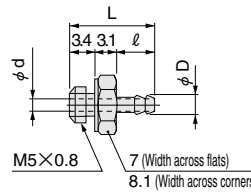

7 (Width across flats)  
8.1 (Width across corners)

Model	D	d	L	l
BF3BU	2.0	0.8	10.5	4
BF4	2.9	1.6	11.5	5
BF4BU	3.2	1.6	11.5	5

### ●BF□

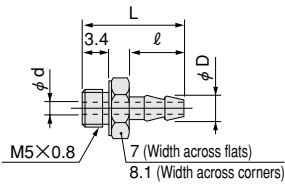

7 (Width across flats)  
8.1 (Width across corners)

Model	D	d	L	l
BF3.2	2.6	1.6	11.5	5
BF5	3.5	1.8	13.5	7
BF6	4.7	2.4	13.5	7

### ●PBF□

### ●PBF□BU

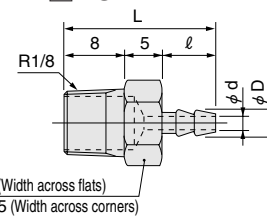

10 (Width across flats)  
11.5 (Width across corners)

Model	D	d	L	l
PBF3BU	2.0	1.6	17	4
PBF3.2	2.6	1.6	18	5
PBF4	2.9	1.6	18	5
PBF4BU	3.2	1.6	18	5
PBF5	3.5	1.8	20	7
PBF6	4.7	2.4	20	7

## Straight (clamp fitting)

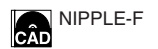

### ●BF□N

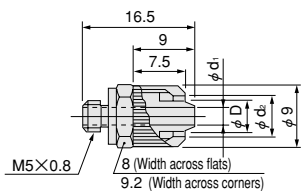

8 (Width across flats)  
9.2 (Width across corners)

### ●BF□U

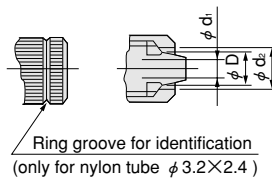

Ring groove for identification  
(only for nylon tube φ 3.2×2.4)

### ●BF□N-01

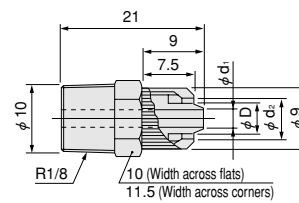

10 (Width across flats)  
11.5 (Width across corners)

### ●BF□U-01

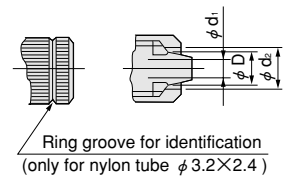

Ring groove for identification  
(only for nylon tube φ 3.2×2.4)

Application	Model	D	d <sub>1</sub>	d <sub>2</sub>
For nylon tube	BF3.2N	2.7	1.6	3.3
	BF4N	3.0	1.8	4.1
	BF5N	3.5	2.1	5.1
	BF6N	4.4	2.4	6.1
For urethane tube	BF4U	3.4	1.8	4.1
	BF6U	5.0	2.4	6.1

Application	Model	D	d <sub>1</sub>	d <sub>2</sub>
For nylon tube	BF3.2N-01	2.7	1.6	3.3
	BF4N-01	3.0	1.8	4.1
	BF5N-01	3.5	2.1	5.1
	BF6N-01	4.4	2.4	6.1
For urethane tube	BF4U-01	3.4	1.8	4.1
	BF6U-01	5.0	2.4	6.1