

### R6LO

Swivel Nut Run Tee  
ORFS / ORFS Swivel / ORFS

SAE 520432

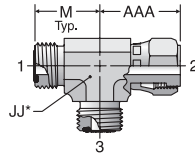

\* JJ – Across Wrench Flats

### R6MLO

Swivel Nut Run Tee – mm Hex  
ORFS / ORFS Swivel / ORFS

ISO 8434-3 SWRT  
SAE 52M0432

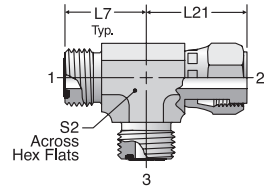

| TUBE FITTING PART # | END SIZE  |           | JJ (in.) | M (in.) | STANDARD Dynamic Pressure (x 1,000 PSI) |     |
|---------------------|-----------|-----------|----------|---------|---|-----|
|                     | 1-3 (in.) | AAA (in.) |          |         | -S                                      | -SS |
|                     | 4 R6LO    | 1/4       |          |         |   |     |
| 6 R6LO              | 3/8       | 1.17      | 3/4      | 0.98    | 9.2                                     |     |
| 8 R6LO              | 1/2       | 1.49      | 3/4      | 1.10    | 9.2                                     |     |
| 10 R6LO             | 5/8       | 1.65      | 1 1/16   | 1.31    | 6.0                                     |     |
| 12 R6LO             | 3/4       | 1.82      | 1 3/16   | 1.47    | 6.0                                     | 6.0 |
| 14 R6LO*            | 7/8       | 2.07      | 1 5/16   | 1.63    |   |     |
| 16 R6LO             | 1         | 2.10      | 1 7/16   | 1.64    | 6.0                                     |     |
| 20 R6LO             | 1 1/4     | 2.29      | 1 5/8    | 1.76    | 5.0                                     |     |
| 24 R6LO             | 1 1/2     | 2.41      | 1 7/8    | 1.92    | 4.0                                     |     |

| TUBE FITTING PART # | END SIZE |       | L7 (mm) | L21 (mm) | S2 (mm) | STANDARD Dynamic Pressure (x 1,000 PSI) |    |
|---------------------|----------|-------|---------|----------|---------|---|----|
|                     | 1-3      |       |         |          |         | S                                       | SS |
|                     | (mm)     | (in.) |         |          |         |   |    |
| 4R6MLO              | 6        | 1/4   | 21.5    | 26.5     | 14      | 9.2                                     |    |
| 6R6MLO              | 8,10     | 3/8   | 25      | 29       | 19      | 9.2                                     |    |
| 8R6MLO              | 12       | 1/2   | 28      | 38       | 19      | 9.2                                     |    |
| 10R6MLO             | 14,15,16 | 5/8   | 33.5    | 41       | 27      | 6.0                                     |    |
| 12R6MLO             | 18,20    | 3/4   | 37.5    | 46.5     | 30      | 6.0                                     |    |
| 16R6MLO             | 22,25    | 1     | 41.5    | 53.5     | 36      | 6.0                                     |    |
| 20R6MLO             | 28,30,32 | 1 1/4 | 44.5    | 58       | 41      | 4.0                                     |    |
| 24R6MLO             | 35,38    | 1 1/2 | 49      | 61       | 50      | 4.0                                     |    |

\* Size 14 is not included in SAE J1453.

### S5OLO

Straight Thread Branch Tee  
ORFS / ORFS / SAE-ORB

SAE 520429

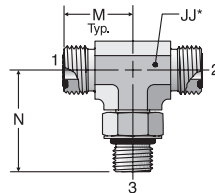

\* JJ – Across Wrench Flats

| TUBE FITTING PART # | END SIZE |         |             | JJ (in.) | M (in.) | N (in.) | STANDARD Dynamic Pressure (x 1,000 PSI) |     |
|---------------------|----------|---------|-------------|----------|---------|---------|---|-----|
|                     | 1 (in.)  | 2 (in.) | 3 UN/UNF-2A |          |         |         | -S                                      | -SS |
|                     | 4 S5OLO  | 1/4     | 1/4         |          |         |         |   |     |
| 4-4-6 S5OLO         | 1/4      | 1/4     | 9/16-18     | 9/16     | 0.92    | 1.45    | 6.0                                     |     |
| 6 S5OLO             | 3/8      | 3/8     | 9/16-18     | 3/4      | 0.98    | 1.45    | 6.0                                     | 6.0 |
| 6-6-4 S5OLO         | 3/8      | 3/8     | 7/16-20     | 3/4      | 0.98    | 1.45    | 6.0                                     |     |
| 6-6-8 S5OLO         | 3/8      | 3/8     | 3/4-16      | 3/4      | 1.04    | 1.60    | 6.0                                     |     |
| 8 S5OLO             | 1/2      | 1/2     | 3/4-16      | 3/4      | 1.10    | 1.60    | 6.0                                     | 6.0 |
| 8-8-10 S5OLO        | 1/2      | 1/2     | 7/8-14      | 1 1/16   | 1.21    | 1.97    | 6.0                                     |     |
| 8-8-12 S5OLO        | 1/2      | 1/2     | 1 1/16-12   | 1 3/16   | 1.32    | 2.17    | 6.0                                     |     |
| 10 S5OLO            | 5/8      | 5/8     | 7/8-14      | 1 1/16   | 1.31    | 1.97    | 6.0                                     |     |
| 10-10-12 S5OLO      | 5/8      | 5/8     | 1 1/16-12   | 1 3/16   | 1.41    | 2.17    | 6.0                                     |     |
| 12 S5OLO            | 3/4      | 3/4     | 1 1/16-12   | 1 3/16   | 1.47    | 2.17    | 6.0                                     | 6.0 |
| 12-12-16 S5OLO      | 3/4      | 3/4     | 1 5/16-12   | 1 7/16   | 1.62    | 2.35    | 5.5                                     |     |
| 16 S5OLO            | 1        | 1       | 1 5/16-12   | 1 7/16   | 1.64    | 2.35    | 5.5                                     |     |
| 16-16-20 S5OLO      | 1        | 1       | 1 5/8-12    | 1 5/8    | 1.76    | 2.45    |   |     |
| 20 S5OLO            | 1 1/4    | 1 1/4   | 1 5/8-12    | 1 5/8    | 1.76    | 2.45    | 4.0                                     |     |
| 24 S5OLO            | 1 1/2    | 1 1/2   | 1 7/8-12    | 1 7/8    | 1.92    | 2.59    | 4.0                                     |     |

Dimensions and pressures for reference only, subject to change.