

WJJMLO

Bulkhead Run Tee – mm Hex
ORFS (all three ends)

ISO 8434-3 BHRT
SAE 52M0958
WJJMLOWLNML - Body with Locknut
(See [page A12](#) for WLNML)

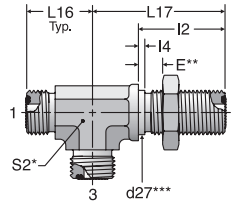

TUBE FITTING PART #	END SIZE		d27 (mm)	E (mm)	I2 (mm)	I4 (mm)	L16 (mm)	L17 (mm)	S2 (mm)	STANDARD Dynamic Pressure (x 1,000 PSI)	
	1-3									S	SS
	(mm)	(in.)									
4WJJMLO	6	1/4	14.3	14	31.5	1.5	22.5	47	14	9.2	
6WJJMLO	8,10	3/8	17.5	14	34	1.5	26	52	19	9.2	
8WJJMLO	12	1/2	20.6	14	36.5	2.5	29	55.5	19	9.2	
10WJJMLO	14,15,16	5/8	25.4	14	40.5	2.5	34.5	63	27	6.0	
12WJJMLO	18,20	3/4	30.2	14	41.5	3	38.5	67	30	6.0	
16WJJMLO	22,25	1	36.5	14	42	3	42.5	71	36	6.0	
20WJJMLO	28,30,32	1 1/4	42.9	14	42	3	45.5	75.5	41		
24WJJMLO	35,38	1 1/2	50.8	14	42	3	49.5	79.5	50		

* S2 – Across wrench flats.

** E – Maximum bulkhead thickness.

***d27 - Bulkhead pilot diameter. Recommended clearance hole is d27 + 0.4 mm.

S6LO

Swivel Nut Branch Tee
ORFS / ORFS / ORFS Swivel

SAE 520433

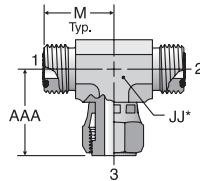

* JJ – Across Wrench Flats

TUBE FITTING PART #	END SIZE		AAA (in.)	JJ (in.)	M (in.)	STANDARD Dynamic Pressure (x 1,000 PSI)	
	1-3					-S	-SS
	(in.)	(in.)					
4 S6LO	1/4	1.07	9/16	0.85	9.2	9.2	
6 S6LO	3/8	1.17	3/4	0.98	9.2	9.2	
8 S6LO	1/2	1.49	3/4	1.10	9.2	9.2	
10 S6LO	5/8	1.65	1 1/16	1.31	6.0	6.0	
12 S6LO	3/4	1.82	1 3/16	1.47	6.0	6.0	
14 S6LO*	7/8	2.07	1 5/16	1.63			
16 S6LO	1	2.10	1 7/16	1.64	6.0		
20 S6LO	1 1/4	2.29	1 5/8	1.76	5.0	5.0	
24 S6LO	1 1/2	2.41	1 7/8	1.92	4.0		

* Size 14 is not included in SAE J1453.

S6MLO

Swivel Nut Branch Tee – mm Hex
ORFS / ORFS / ORFS Swivel

ISO 8434-3 SWBT
SAE 52M0433

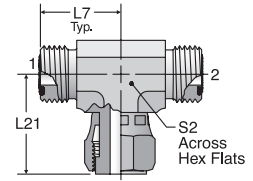

* S2 – Across Wrench Flats

TUBE FITTING PART #	END SIZE		L7 (mm)	L21 (mm)	S2 (mm)	STANDARD Dynamic Pressure (x 1,000 PSI)	
	1-3					S	SS
	(mm)	(in.)					
4S6MLO	6	1/4	21.5	26.5	14		
6S6MLO	8,10	3/8	25	29	19	9.2	
8S6MLO	12	1/2	28	38	19	9.2	
10S6MLO	14,15,16	5/8	33.5	41	27	6.0	
12S6MLO	18,20	3/4	37.5	46.5	30	6.0	
16S6MLO	22,25	1	41.5	53.5	36	6.0	
20S6MLO	28,30,32	1 1/4	44.5	58	41	4.0	
24S6MLO	35,38	1 1/2	49	61	50		

Dimensions and pressures for reference only, subject to change.