

R5OLO

Straight Thread Run Tee
ORFS / SAE-ORB / ORFS

SAE 520428

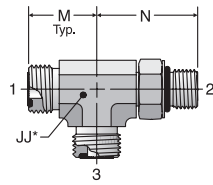

* JJ – Across Wrench Flats

SLO

Male Pipe Tee
ORFS / ORFS / NPTF

SAE 520425

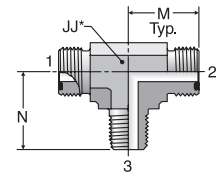

* JJ – Across Wrench Flats

TUBE FITTING PART #	END SIZE			JJ (in.)	M (in.)	N (in.)	STANDARD Dynamic Pressure (x 1,000 PSI)	
	1	2	3				-S	-SS
	(in.)	UN/UNF-2A	(in.)					
4 R5OLO	1/4	7/16-20	1/4	9/16	0.85	1.29	6.0	6.0
4-6-4 R5OLO	1/4	9/16-18	1/4	3/4	0.92	1.45	6.0	
6 R5OLO	3/8	9/16-18	3/8	3/4	0.98	1.45	6.0	6.0
6-8-6 R5OLO	3/8	3/4-16	3/8	3/4	1.04	1.60	6.0	
8 R5OLO	1/2	3/4-16	1/2	3/4	1.10	1.60	6.0	6.0
8-10-8 R5OLO	1/2	7/8-14	1/2	1 1/16	1.21	1.97	6.0	
10 R5OLO	5/8	7/8-14	5/8	1 1/16	1.31	1.97	6.0	6.0
10-12-10 R5OLO	5/8	1 1/16-12	5/8	1 3/16	1.41	2.17	6.0	
12 R5OLO	3/4	1 1/16-12	3/4	1 3/16	1.47	2.17	6.0	6.0
12-16-12 R5OLO	3/4	1 5/16-12	3/4	1 7/16	1.62	2.35	5.5	
16 R5OLO	1	1 5/16-12	1	1 7/16	1.64	2.35	5.5	5.5
16-20-16 R5OLO	1	1 5/8-12	1	1 5/8	1.76	2.45		
20 R5OLO	1 1/4	1 5/8-12	1 1/4	1 5/8	1.76	2.45	4.0	4.0
24 R5OLO	1 1/2	1 7/8-12	1 1/2	1 7/8	1.92	2.59	4.0	

TUBE FITTING PART #	END SIZE		JJ (in.)	M (in.)	N (in.)	STANDARD Dynamic Pressure (x 1,000 PSI)	
	1 & 2	3				-S	-SS
	(in.)	NPTF					
4-4-4 SLO	1/4	1/4-18	9/16	0.85	1.12	6.0	
6 SLO	3/8	1/4-18	3/4	0.98	1.09	6.0	
6-6-6 SLO	3/8	3/8-18	3/4	0.98	1.22	6.0	
8 SLO	1/2	3/8-18	3/4	1.10	1.22	6.0	
8-8-8 SLO	1/2	1/2-14	7/8	1.10	1.47	6.0	
10 SLO	5/8	1/2-14	1 1/16	1.31	1.47		
12 SLO	3/4	3/4-14	1 3/16	1.47	1.59	4.0	
16 SLO	1	1-11 1/2	1 7/16	1.64	1.97	3.0	
20 SLO	1 1/4	1 1/4-11 1/2	1 5/8	1.76	2.38	2.5	

S87OMLO

Metric Straight Thread Branch Tee
ORFS / ORFS / ISO 6149

ISO 8434-3 SDBT
SAE 52M0489

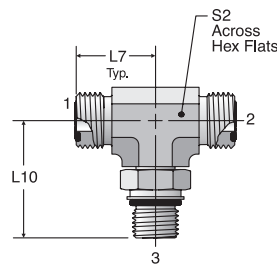

* S2 – Across Hex Flats

TUBE FITTING PART #	END SIZE			L7 (mm)	L10 (mm)	S2 (mm)	STANDARD Dynamic Pressure (x 1,000 PSI)	
	1 & 2	3	S				SS	
	(mm)	(in.) ISO 261						
4M12S87OMLO	6	1/4	M12X1.5	21.5	33	14		
4M14S87OMLO	6	1/4	M14X1.5	24	35.5	19	6.0	
6M14S87OMLO	8,10	3/8	M14X1.5	25	35.5	19	6.0	
6M16S87OMLO	8,10	3/8	M16X1.5	25	37.5	19	6.0	
8M14S87OMLO	12	1/2	M14X1.5	28	36	19		
8M18S87OMLO	12	1/2	M18X1.5	28	41	19	6.0	
8M22S87OMLO	12	1/2	M22X1.5	31	49	27	6.0	
10M22S87OMLO	14,15,16	5/8	M22X1.5	33.5	49	27	6.0	
12M27S87OMLO	18,20	3/4	M27X2	37.5	55.5	30	6.0	
16M33S87OMLO	22,25	1	M33X2	41.5	59.5	36	5.1	
20M42S87OMLO	28,30,32	1 1/4	M42X2	44.5	63	41	4.0	
24M48S87OMLO	35,38	1 1/2	M48X2	49	71.5	50		

Dimensions and pressures for reference only, subject to change.