

## 26 Series Fittings

### Table of Contents

#### 26 Series Fittings Base Part Number with Description

Table of Contents <small>(page 1 of 1)</small>	Page Number
10126 Male NPTF Pipe - Rigid Straight	B-6
10326 Male JIC 37° - Rigid Straight	B-6
10626 Female JIC 37° - Swivel Straight	B-7
13726 Female JIC 37° - Swivel 45° Elbow - Short Drop	B-7
13926 Female JIC 37° - Swivel 90° Elbow - Short Drop	B-8
14126 Female JIC 37° - Swivel 90° Elbow - Long Drop	B-8
10426 Male SAE 45° - Rigid Straight	B-9
10826 Female SAE 45° - Swivel Straight	B-9
17726 Female SAE 45° - Swivel 45° Elbow	B-9
17926 Female SAE 45° - Swivel 90° Elbow	B-10
11526 SAE Code 61 Flange Head - Straight - ISO 12151-3 - S - L	B-10
11926 SAE Code 61 Flange Head - 90° Elbow - ISO 12151-3 - E90S - L (1 Piece: ISO 12151-3 - E90M - L)	B-10
16826 Female JIC 37°/SAE 45° Dual Flare - Swivel - Straight	B-11
13V26 Female JIC 37°/SAE 45° Dual Flare - Swivel - 45° Elbow Short Drop	B-11
13W26 Female JIC 37°/SAE 45° Dual Flare - Swivel - 90° Elbow Short Drop	B-12
1S526 Male Tube-O - Swivel Straight - Short Pilot	B-12
1S526-PR Male Tube-O - Swivel Straight - Short Pilot with Charge Port for R12	B-12
15R26 Male Tube-O - Swivel 45° Elbow - Short Pilot	B-13
15K26 Male Tube-O - Swivel 90° Elbow - Short Pilot	B-13
15K26-PR Male Tube-O - Swivel 90° Elbow - Short Pilot with Charge Port for R12	B-13
14526-PR Male Tube-O - Swivel Straight - Long Pilot with Charge Port for R12	B-14
14526-PT Male Tube-O - Swivel Straight - Long Pilot with Charge Port for R134a	B-14
15M26-PR Male Tube-O - Swivel 90° Elbow - Long Pilot with Charge Port for R12	B-14
15M26-PT Male Tube-O - Swivel 90° Elbow - Long Pilot with Charge Port for R134a	B-15
15M26-PV Male Tube-O - Swivel 90° Elbow - Long Pilot with Charge Port for R134a	B-15
15G26 Male Tube-O - Rigid Straight - Internal Long Pilot (3-Step)	B-15
15G26-PR Male Tube-O - Rigid Straight - Internal Long Pilot (3-Step) with Charge Port for R12	B-16
15S26 Female Tube-O - Swivel Straight - Short Pilot	B-16
15H26 Female Tube-O - Swivel 45° Elbow - Short Pilot	B-16
15T26 Female Tube-O - Swivel 90° Elbow - Short Pilot	B-17
15926-PT Female Tube-O - Swivel Straight - Long Pilot with Charge Port for R134a	B-17
15N26-PT Female Tube-O - Swivel 45° Elbow - Long Pilot with Charge Port for R134a	B-17
15L26-PR Female Tube-O - Swivel 90° Elbow - Long Pilot with Charge Port for R12	B-18
15L26-PT Female Tube-O - Swivel 90° Elbow - Long Pilot with Charge Port for R134a	B-18
15P26-PT Male Tube-O - Swivel 45° Elbow - Long Pilot with Charge Port for R134a	B-19
1JC26 Female Seal-Lok® - Swivel Straight - Short	B-19
1J726 Female Seal-Lok® - Swivel 45° Elbow	B-20
1J926 Female Seal-Lok® - Swivel 90° Elbow - Short Drop	B-20
17B26 Female Air Brake Jounce Line Swivel - Straight	B-21
15V26 Female Compressor - Swivel 45° Elbow	B-21
15W26 Female Compressor - Swivel 90° Elbow	B-21
15Z26 Female Compressor - Swivel 90° Elbow - Block Type	B-22
1RV26 (970237/970239) Compressor Fitting 135° Elbow	B-22
1RV26 (970242) Compressor Fitting 180° Block Type	B-22
1T126 Male Refrigerant Tube Mender Straight (with Nut and Ferrule)	B-23
1T126 Fitting Installation Instructions	B-23

## 26 Series Fittings

Use with 201/261, 206, 213, 221FR  
225, 235, 244, 266, 285, and 293 hose.

Pipe / JIC

### 10126 Male NPTF Pipe - Rigid Straight

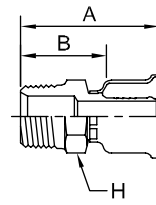

# Part Number	Thread		Hose		A		H		B	
	inch		inch		inch	mm	inch	inch	mm	
	10126-2-4	1/8x27	-2	3/16	-4	1.65	42	7/16	0.78	20
10126-4-4	1/4x18	-4	3/16	-4	1.88	48	9/16	1.01	26	
10126-4-5	1/4x18	-4	1/4	-5	1.88	48	9/16	1.01	26	
10126-4-6	1/4x18	-4	5/16	-6	1.88	48	3/4	1.02	26	
10126-6-6	3/8x18	-6	5/16	-6	1.89	48	11/16	1.03	26	
10126-6-8	3/8x18	-6	13/32	-8	1.89	48	11/16	1.03	26	
10126-8-8	1/2x14	-8	13/32	-8	2.14	54	7/8	1.28	33	
10126-8-10	1/2x14	-8	1/2	-10	2.25	57	7/8	1.30	33	
10126-12-12	3/4x14	-12	5/8	-12	2.32	59	1-1/16	1.37	35	
10126-16-16	1x11-1/2	-16	7/8	-16	2.61	66	1-3/8	1.57	40	
10126-20-20	1-1/4x11-1/2	-20	1-1/8	-20	2.83	72	1-3/4	1.77	45	
10126-24-24	1-1/2x11-1/2	-24	1-3/8	-24	3.01	76	2	1.93	49	
10126-24-32+	1-1/2x11-1/2	-24	1-13/16	-32	3.41	87	2-1/2	2.15	55	
10126-32-32	2x11-1/2	-32	1-13/16	-32	3.44	87	2-1/2	2.18	55	

### 10326 Male JIC 37° - Rigid Straight

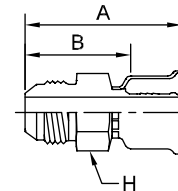

# Part Number	Thread		Hose		A		H		B	
	inch		inch		inch	mm	inch	inch	mm	
	10326-4-4	1/4	7/16x20	-4	3/16	-4	1.97	50	1/2	1.15
10326-6-6	3/8	9/16x18	-6	5/16	-6	2.13	54	3/4	1.26	32
10326-8-8	1/2	3/4x16	-8	13/32	-8	1.94	49	13/16	1.08	27
10326-10-10	5/8	7/8x14	-10	1/2	-10	2.50	64	15/16	1.54	39
10326-16-16	1	1-5/16x12	-16	7/8	-16	2.79	71	1-3/8	1.75	44

+ Non Standard

**26 Series Fittings**

Use with 201/261, 206, 213, 221FR  
225, 235, 244, 266, 285, and 293 hose.

**10626 Female JIC 37° - Swivel Straight**

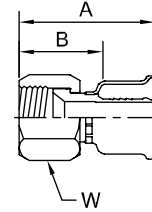

BS - Brass Nut, Brass Nipple, Steel Shell

# Part Number	Thread			Hose		A		W	B	
	inch			inch		inch	mm	inch	inch	mm
10626-6-6	3/8	9/16x18	-6	5/16	-6	1.79	45	11/16	0.92	23
10626-6-6BS	3/8	9/16x18	-6	5/16	-6	1.79	45	11/16	0.92	23
10626-6-8	3/8	9/16x18	-6	13/32	-8	2.05	52	11/16	1.19	30
10626-12-12	3/4	1-1/16x12	-12	5/8	-12	2.29	58	1-1/4	1.35	34
10626-12-12BS	3/4	1-1/16x12	-12	5/8	-12	2.29	58	1-1/4	1.35	34
10626-16-16	1	1-5/16x12	-16	7/8	-16	2.53	64	1-1/2	1.49	38
10626-16-16BS	1	1-5/16x12	-16	7/8	-16	2.53	64	1-1/2	1.49	38
10626-20-20	1-1/4	1-5/8x12	-20	1-1/8	-20	2.56	65	2	1.50	38
10626-24-24	1-1/2	1-7/8x12	-24	1-3/8	-24	2.77	70	2-1/4	1.69	43
10626-24-32+	1-1/2	1-7/8x12	-24	1-13/16	-32	3.73	95	2-1/4	2.47	63
10626-32-32	2	2-1/2x12	-32	1-13/16	-32	3.30	84	2-7/8	2.04	52

**13726 Female JIC 37° - Swivel 45° Elbow - Short Drop**

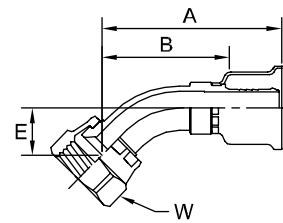

# Part Number	Thread			Hose		A		E		W	B	
	inch			inch		inch	mm	inch	mm	inch	inch	mm
13726-6-6	3/8	9/16x18	-6	5/16	-6	2.45	62	0.43	11	11/16	1.59	40
13726-12-12	3/4	1-1/16x12	-12	5/8	-12	3.02	77	0.79	20	1-1/4	2.08	53
13726-16-16	1	1-5/16x12	-16	7/8	-16	3.34	85	0.90	23	1-1/2	2.30	58
13726-20-20	1-1/4	1-5/8x12	-20	1-1/8	-20	3.74	95	1.18	30	2	2.68	68
13726-24-24	1-1/2	1-7/8x12	-24	1-3/8	-24	3.92	100	1.16	29	2-1/4	2.84	72

+ Non Standard

## 26 Series Fittings

Use with 201/261, 206, 213, 221FR  
225, 235, 244, 266, 285, and 293 hose.

### 13926 Female JIC 37° - Swivel 90° Elbow - Short Drop

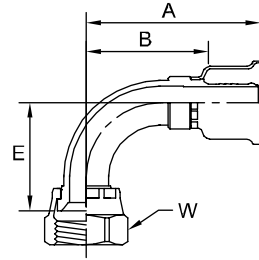

# Part Number	Thread			Hose		A		E		W	B	
	inch			inch		inch	mm	inch	mm	inch	inch	mm
	13926-6-6	3/8	9/16x18	-6	5/16	-6	2.02	51	0.85	22	11/16	1.12
13926-12-12	3/4	1-1/16x12	-12	5/8	-12	2.93	74	1.82	46	1-1/4	1.99	51
13926-16-16+	1	1-5/16x12	-16	7/8	-16	3.30	84	2.14	54	1-1/2	2.26	57
13926-20-20	1-1/4	1-5/8x12	-20	1-1/8	-20	3.60	91	2.57	65	2	2.54	65
13926-24-24	1-1/2	1-7/8x12	-24	1-3/8	-24	3.92	100	2.82	72	2-1/4	2.84	72
13926-32-32+	2	2-1/2x12	-32	1-13/16	-32	4.83	123	3.41	87	2-7/8	3.57	91

### 14126 Female JIC 37° - Swivel 90° Elbow - Long Drop

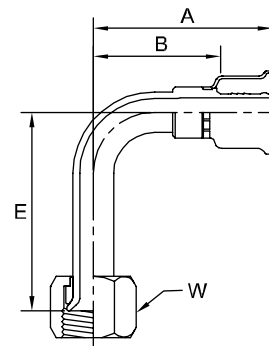

~ These 14126 fittings contain a dual seat that accepts both the JIC (37°) and SAE (45°) male configurations. The other sizes accept the JIC (37°) male configurations only.

# Part Number	Thread			Hose		A		E		W	B	
	inch			inch		inch	mm	inch	mm	inch	inch	mm
	14126-4-4~	1/4	7/16x20	-4	1/4	-4	2.05	52	1.81	46	9/16	1.18
14126-6-6	3/8	9/16x18	-6	5/16	-6	2.12	54	2.13	54	11/16	1.26	32
14126-8-8~	1/2	3/4x16	-8	13/32	-8	2.42	61	2.42	61	7/8	1.56	40
14126-10-10~	5/8	7/8x14	-10	1/2	-10	2.68	68	2.76	70	15/16	1.73	44
14126-12-12	3/4	1-1/16x12	-12	5/8	-12	2.82	72	3.74	95	1-1/4	1.88	48
14126-16-16	1	1-5/16x12	-16	7/8	-16	3.17	81	4.33	110	1-1/2	2.13	54

+ Non Standard

**26 Series Fittings**

Use with 201/261, 206, 213, 221FR  
225, 235, 244, 266, 285, and 293 hose.

### 10426 Male SAE 45° - Rigid Straight

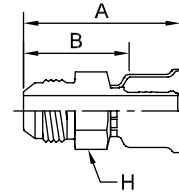

# Part Number	Thread			Hose		A		H	B	
	inch	inch		inch	inch	inch	mm	inch	inch	mm
10426-4-4	1/4	7/16x20	-4	3/16	-4	1.97	50	1/2	1.10	28

### 10826 Female SAE 45° - Swivel Straight

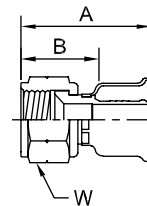

BA - Steel Nut, Brass Nipple, Steel Shell  
Note: Notch in nut for SAE 45° flare.

# Part Number	Thread			Hose		A		W	B	
	inch	inch		inch	inch	inch	mm	inch	inch	mm
10826-6-6	3/8	5/8x18	-6	5/16	-6	1.84	47	3/4	0.98	25
10826-6-6BA	3/8	5/8x18	-6	5/16	-6	1.84	47	3/4	0.98	25
10826-12-8+	3/4	1-1/16x14	-12	13/32	-8	2.33	59	1-1/4	1.47	37
10826-12-12	3/4	1-1/16x14	-12	5/8	-12	2.19	56	1-1/4	1.25	32

### 17726 Female SAE 45° - Swivel 45° Elbow

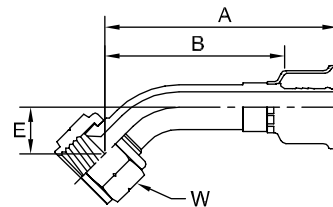

Note: Notch in nut for SAE 45° flare.

# Part Number	Thread			Hose		A		E		W	B	
	inch	inch		inch	inch	inch	mm	inch	mm	inch	inch	mm
17726-6-6	3/8	5/8x18	-6	5/16	-6	2.19	56	0.39	10	11/16	1.33	34
17726-12-12	3/4	1-1/16x14	-12	5/8	-12	3.02	77	0.79	20	1-1/4	2.08	53

+ Non Standard

## 26 Series Fittings

SAE / Flange Head

Use with 201/261, 206, 213, 221FR  
225, 235, 244, 266, 285, and 293 hose.

### 17926 Female SAE 45° - Swivel 90° Elbow

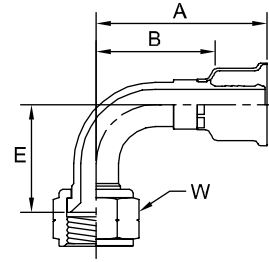

Note: Notch in nut for SAE 45° flare.

# Part Number	Thread			Hose		A		E		W	B	
	inch	inch	-	inch	-	inch	mm	inch	mm	inch	inch	mm
17926-6-6	3/8	5/8x18	-6	5/16	-6	2.09	53	0.85	22	3/4	1.23	31
17926-12-12	3/4	1x1/16-14	-12	5/8	-12	2.93	74	1.82	46	1-1/4	1.99	51

### 11526 SAE Code 61 Flange Head - Straight ISO 12151-3 - S - L

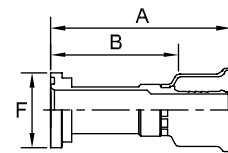

Note: This fitting **MUST** be assembled with a PARKRIMP 4.

# Part Number	Flange		Hose		A		F	B	
	inch	-	inch	-	inch	mm	inch	inch	mm
11526-40-40	2-1/2	-40	2-3/8	-40	4.50	114	3-5/16	3.08	78

### 11926 SAE Code 61 Flange Head - 90° Elbow ISO 12151-3 - E90S - L (1 Piece: ISO 12151-3 - E90M - L)

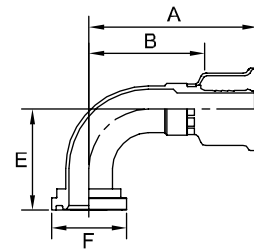

Note: This fitting **MUST** be assembled with a PARKRIMP 4.

# Part Number	Flange		Hose		A		E		F	B	
	inch	-	inch	-	inch	mm	inch	mm	inch	inch	mm
11926-40-40	2-1/2	-40	2-3/8	-40	4.50	114	3.68	93	3-5/16	4.09	104

+ Non Standard

**26 Series Fittings**

Use with 201/261, 206, 213, 221FR  
225, 235, 244, 266, 285, and 293 hose.

**16826 Female JIC 37°/ SAE 45°  
Dual Flare - Swivel - Straight**

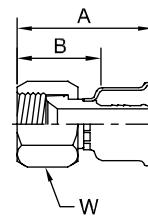

BA - Steel Nut, Brass Nipple, Steel Shell  
BS - Brass Nut, Brass Nipple, Steel Shell

# Part Number	Thread			Hose		A		W		B	
	inch			inch		inch	mm	inch	inch	mm	
	16826-4-4	1/4	7/16x20	-4	3/16	-4	1.67	42	9/16	0.80	20
16826-4-4BA	1/4	7/16x20	-4	3/16	-4	1.67	42	9/16	0.80	20	
16826-4-4BS	1/4	7/16x20	-4	3/16	-4	1.67	42	9/16	0.80	20	
16826-4-5	1/4	7/16x20	-4	1/4	-5	1.90	48	9/16	1.03	26	
16826-4-6	1/4	7/16x20	-4	5/16	-6	1.90	48	9/16	1.03	26	
16826-5-5	5/16	1/2x20	-5	1/4	-5	1.77	45	5/8	0.90	23	
16826-5-5BA	5/16	1/2x20	-5	1/4	-5	1.77	45	5/8	0.90	23	
16826-8-6	1/2	3/4x16	-8	5/16	-6	2.19	56	7/8	1.33	34	
16826-8-8	1/2	3/4x16	-8	13/32	-8	1.91	49	7/8	1.05	27	
16826-8-8BA	1/2	3/4x16	-8	13/32	-8	1.91	49	7/8	1.05	27	
16826-8-10	1/2	3/4x16	-8	1/2	-10	2.36	60	7/8	1.41	36	
16826-10-10	5/8	7/8x14	-10	1/2	-10	2.17	55	1	1.23	31	
16826-10-10BA	5/8	7/8x14	-10	1/2	-10	2.17	55	1	1.23	31	
16826-10-12	5/8	7/8x14	-10	5/8	-12	2.40	61	1	1.46	37	

**13V26 Female JIC 37°/ SAE 45°  
Dual Flare - Swivel - 45° Elbow  
Short Drop**

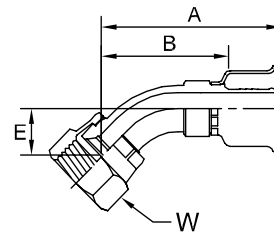

# Part Number	Thread			Hose		A		E		W		B	
	inch			inch		inch	mm	inch	mm	inch	inch	mm	
	13V26-4-4	1/4	7/16x20	-4	3/16	-4	2.01	51	0.39	10	9/16	1.14	29
13V26-5-5+	5/16	1/2x20	-5	1/4	-5	2.53	64	0.36	9	5/8	1.62	41	
13V26-8-8	1/2	3/4x16	-8	13/32	-8	2.37	60	0.59	15	7/8	1.50	38	
13V26-10-10	5/8	7/8x14	-10	1/2	-10	2.70	69	0.65	17	1	1.75	44	
13V26-10-12	5/8	7/8x14	-10	5/8	-12	2.70	69	0.65	17	1	1.76	45	

+ Non Standard

**26 Series Fittings**

Use with 201/261, 206, 213, 221FR  
225, 235, 244, 266, 285, and 293 hose.

**13W26 Female JIC 37°/ SAE 45°  
Dual Flare - Swivel - 90° Elbow  
Short Drop**

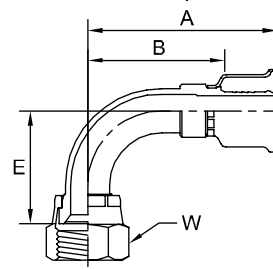

# Part Number	Thread			Hose		A		E		W	B	
	inch			inch		inch	mm	inch	mm	inch	inch	mm
	13W26-4-4	1/4	7/16x20	-4	3/16	-4	1.82	46	0.83	21	9/16	0.95
13W26-5-5+	5/16	1/2x20	-5	1/4	-5	2.09	53	0.77	20	5/8	1.18	30
13W26-8-8	1/2	3/4x16	-8	13/32	-8	2.12	54	1.14	29	7/8	1.26	32
13W26-10-10	5/8	7/8x14	-10	1/2	-10	2.55	65	1.24	31	1	1.60	41
13W26-10-12	5/8	7/8x14	-10	5/8	-12	2.55	65	1.24	31	1	1.61	41

**1S526 Male Tube-O - Swivel  
Straight - Short Pilot**

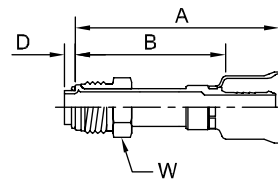

# Part Number	Thread			Hose		A		D		W	B	
	inch			inch		inch	mm	inch	mm	inch	inch	mm
	1S526-6-6	3/8	5/8x18	-6	5/16	-6	2.57	65	0.18	4,7	5/8	1.71
1S526-7-6	11/16	11/16x16	-7	5/16	-6	2.57	65	0.18	4,7	5/8	1.71	43
1S526-8-8	1/2	3/4x18	-8	13/32	-8	2.66	68	0.18	4,7	3/4	1.80	46
1S526-10-10	5/8	7/8x18	-10	1/2	-10	3.04	77	0.18	4,7	7/8	2.09	53
1S526-10-12	5/8	7/8x18	-10	5/8	-12	3.04	77	0.18	4,7	7/8	2.10	53

**1S526-PR Male Tube-O - Swivel  
Straight - Short Pilot with Charge  
Port for R12**

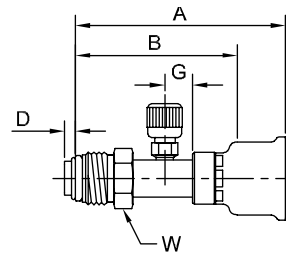

# Part Number	Thread			Hose		A		D		G		W	B	
	inch			inch		inch	mm	inch	mm	inch	mm	inch	inch	mm
	1S526-10-10-PR	5/8	7/8x18	-10	1/2	-10	3.52	89	0.18	4,7	0.47	12	7/8	2.56
1S526-10-12-PR	5/8	7/8x18	-10	5/8	-12	3.51	89	0.18	4,7	0.47	12	7/8	2.57	65

+ Non Standard



## 26 Series Fittings

Tube-O Swivel

Use with 201/261, 206, 213, 221FR  
225, 235, 244, 266, 285, and 293 hose.

### 15R26 Male Tube-O - Swivel 45° Elbow - Short Pilot

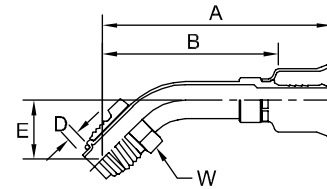

# Part Number	Thread			Hose		A		D		E		W	B	
	inch	inch	-	inch	inch	inch	mm	inch	mm	inch	mm	inch	inch	mm
15R26-6-6	3/8	5/8x18	-6	5/16	-6	2.98	76	0.18	4,7	1.00	25	5/8	2.12	54
15R26-8-8	1/2	3/4x18	-8	13/32	-8	3.03	77	0.18	4,7	1.05	27	3/4	2.17	55
15R26-10-10	5/8	7/8x18	-10	1/2	-10	3.59	91	0.18	4,7	1.25	32	7/8	2.64	67
15R26-10-12	5/8	7/8x18	-10	5/8	-12	3.59	91	0.18	4,7	1.25	32	7/8	2.65	67

### 15K26 Male Tube-O - Swivel 90° Elbow - Short Pilot

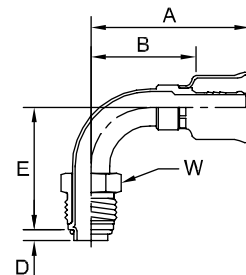

# Part Number	Thread			Hose		A		D		E		W	B	
	inch	inch	-	inch	inch	inch	mm	inch	mm	inch	mm	inch	inch	mm
15K26-6-6	3/8	5/8x18	-6	5/16	-6	2.21	56	0.18	4,7	1.76	45	5/8	1.35	34
15K26-8-8	1/2	3/4x18	-8	13/32	-8	2.88	73	0.18	4,7	1.74	44	3/4	2.02	51
15K26-10-10+	5/8	7/8x18	-10	1/2	-10	2.65	67	0.18	4,7	2.20	56	7/8	1.70	43
15K26-10-12	5/8	7/8x18	-10	5/8	-12	2.63	67	0.18	4,7	2.20	56	7/8	1.69	43

### 15K26-PR Male Tube-O - Swivel 90° Elbow - Short Pilot with Charge Port for R12

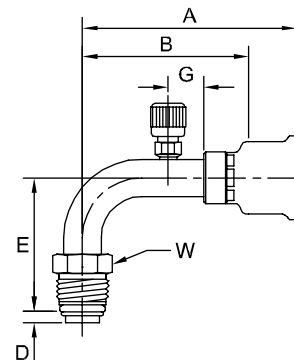

# Part Number	Thread			Hose		A		D		G	E		W	B	
	inch	inch	-	inch	inch	inch	mm	inch	mm	inch	mm	inch	inch	mm	
15K26-10-10-PR	5/8	7/8x18	-10	1/2	-10	3.59	91	0.18	4,7	0.60	15	2.25	57	2.63	67
15K26-10-12-PR	5/8	7/8x18	-10	5/8	-12	3.58	91	0.18	4,7	0.60	15	2.25	57	2.64	67

+ Non Standard

## 26 Series Fittings

Tube-O Swivel

Use with 201/261, 206, 213, 221FR  
225, 235, 244, 266, 285, and 293 hose.

### 14526-PR Male Tube-O - Swivel Straight - Long Pilot with Charge Port for R12

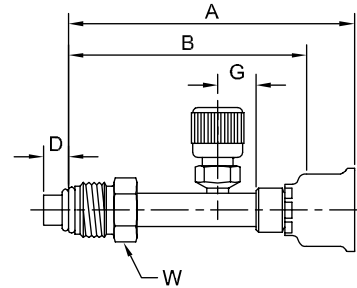

# Part Number	Thread			Hose		A		D		G		W	B	
	inch	inch	-	inch	inch	inch	mm	inch	mm	inch	mm	inch	inch	mm
14526-6-6-PR	3/8	5/8x18	-6	5/16	-6	3.26	83	0.28	7,1	0.50	13	5/8	2.40	61

### 14526-PT Male Tube-O - Swivel Straight - Long Pilot with Charge Port for R134a

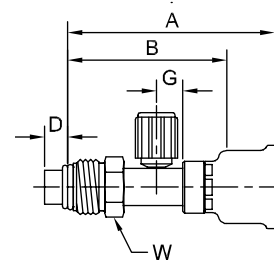

# Part Number	Thread			Hose		A		D		G		W	B	
	inch	inch	-	inch	inch	inch	mm	inch	mm	inch	mm	inch	inch	mm
14526-10-12-PT	5/8	7/8x18	-10	5/8	-12	3.48	88	0.38	9,8	0.44	11	7/8	2.54	65

### 15M26-PR Male Tube-O - Swivel 90° Elbow – Long Pilot with Charge Port for R12

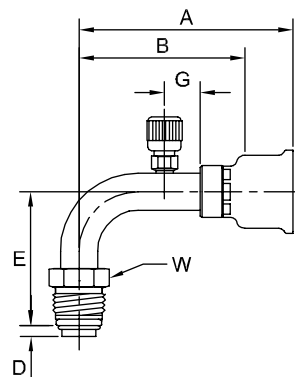

# Part Number	Thread			Hose		A		D		G		E	W	B		
	inch	inch	-	inch	inch	inch	mm	inch	mm	inch	mm	inch	inch	mm		
15M26-6-6-PR	3/8	5/8x18	-6	5/16	-6	3.05	77	0.28	7,1	0.50	13	1.80	46	5/8	2.19	56

+ Non Standard

## 26 Series Fittings

Tube-O Swivel / Tube-O Rigid

Use with 201/261, 206, 213, 221FR  
225, 235, 244, 266, 285, and 293 hose.

### 15M26-PT Male Tube-O - Swivel 90° Elbow – Long Pilot with Charge Port for R134a

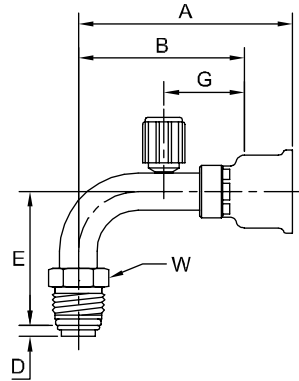

# Part Number	Thread			Hose		A		D		G		E		W		B	
	inch			inch	inch	inch	mm	inch	mm	inch	mm	inch	mm	inch	inch	mm	
15M26-10-12-PT	5/8	7/8x18	-10	5/8	-12	3.58	91	0.38	9,8	0.60	15	2.25	57	7/8	2.64	67	

### 15M26-PV Male Tube-O - Swivel 90° Elbow – Long Pilot with Charge Port for R134a

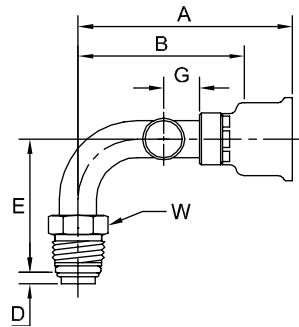

# Part Number	Thread			Hose		A		D		G		E		W		B	
	inch			inch	inch	inch	mm	inch	mm	inch	mm	inch	mm	inch	inch	mm	
15M26-10-12-PV	5/8	7/8x18	-10	5/8	-12	3.58	91	0.38	9,8	0.60	15	2.25	57	7/8	2.64	67	

### 15G26 Male Tube-O - Rigid Straight - Internal Long Pilot (3-Step)

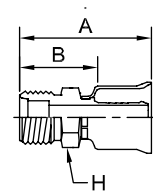

# Part Number	Thread			Hose		A		H		B	
	inch			inch	inch	inch	mm	inch	inch	mm	
15G26-6-6	3/8	5/8x18	-6	3/8	-6	1.78	45	5/8	0.92	23	
15G26-10-10	5/8	7/8x14	-10	1/2	-10	2.20	56	7/8	1.25	32	
15G26-10-12	5/8	7/8x14	-10	5/8	-12	2.19	56	7/8	1.25	32	
15G26-12-12+	3/4	1-1/16x14	-12	5/8	-12	2.37	60	1-1/16	1.43	36	

+ Non Standard

## 26 Series Fittings

Tube-O Rigid / Tube-O Swivel

Use with 201/261, 206, 213, 221FR  
225, 235, 244, 266, 285, and 293 hose.

### 15G26-PR Male Tube-O - Rigid Straight - Internal Long Pilot (3-Step) with Charge Port for R12

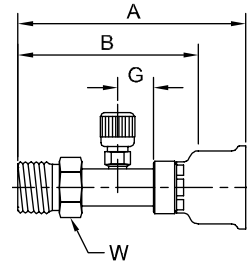

# Part Number	Thread			Hose		A		G		W	B	
	inch			inch		inch	mm	inch	mm	inch	inch	mm
	15G26-10-12-PR	5/8	7/8x14	-10	5/8	-12	3.82	97	0.60	15	7/8	2.88

### 15S26 Female Tube-O - Swivel Straight - Short Pilot

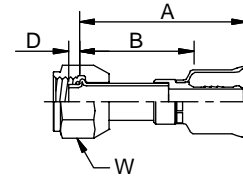

# Part Number	Thread			Hose		A		D		W	B	
	inch			inch		inch	mm	inch	mm	inch	inch	mm
	15S26-6-6	3/8	5/8x18	-6	5/16	-6	2.59	66	0.18	4,7	3/4	1.73
15S26-8-8	1/2	3/4x16	-8	13/32	-8	2.64	67	0.18	4,7	7/8	1.78	45
15S26-10-10	5/8	7/8x14	-10	1/2	-10	2.80	71	0.18	4,7	1-1/16	1.85	47
15S26-10-12	5/8	7/8x14	-10	5/8	-12	2.80	71	0.18	4,7	1-1/16	1.86	47

### 15H26 Female Tube-O - Swivel 45° Elbow – Short Pilot

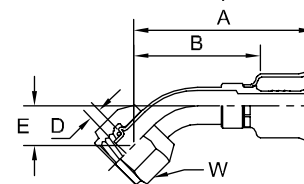

# Part Number	Thread			Hose		A		D		E		W	B	
	inch			inch		inch	mm	inch	mm	inch	mm	inch	inch	mm
	15H26-6-6	3/8	5/8x18	-6	5/16	-6	2.40	61	0.18	4,7	0.54	14	3/4	1.54
15H26-8-8	1/2	3/4x16	-8	13/32	-8	2.54	65	0.18	4,7	0.60	15	7/8	1.68	43
15H26-10-10	5/8	7/8x14	-10	1/2	-10	3.02	77	0.18	4,7	0.67	17	1-1/16	2.07	53
15H26-10-12	5/8	7/8x14	-10	5/8	-12	3.02	77	0.18	4,7	0.67	17	1-1/16	2.08	53

+ Non Standard

## 26 Series Fittings

Tube-O Swivel

Use with 201/261, 206, 213, 221FR  
225, 235, 244, 266, 285, and 293 hose.

### 15T26 Female Tube-O - Swivel 90° Elbow – Short Pilot

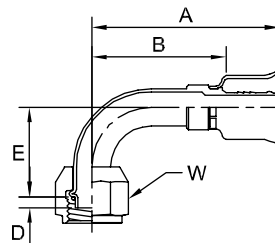

# Part Number	Thread			Hose		A		D		E		W	B	
	inch	inch	-	inch	inch	inch	mm	inch	mm	inch	mm	inch	inch	mm
15T26-6-6	3/8	5/8x18	-6	5/16	-6	2.21	56	0.18	4,7	1.29	33	3/4	1.35	34
15T26-8-8	1/2	3/4x16	-8	13/32	-8	2.48	63	0.18	4,7	1.46	37	7/8	1.62	41
15T26-10-10	5/8	7/8x14	-10	1/2	-10	2.89	73	0.18	4,7	1.75	44	1-1/16	1.94	49
15T26-10-12	5/8	7/8x14	-10	5/8	-12	2.89	73	0.18	4,7	1.75	44	1-1/16	1.95	50

### 15926-PT Female Tube-O - Swivel Straight – Long Pilot with Charge Port for R134a

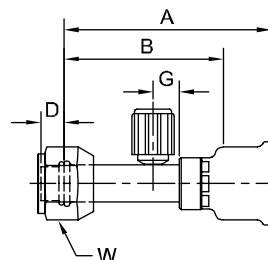

# Part Number	Thread			Hose		A		D		G		W	B	
	inch	inch	-	inch	inch	inch	mm	inch	mm	inch	mm	inch	inch	mm
15926-6-6-PT	3/8	5/8x18	-6	5/16	-6	3.26	83	0.28	7,1	0.50	13	3/4	2.40	61
15926-8-8-PT	1/2	3/4x16	-8	13/32	-8	2.90	74	0.38	9,8	0.50	13	7/8	2.04	52
15926-10-12-PT	5/8	7/8x14	-10	5/8	-12	3.48	88	0.38	9,8	0.60	15	1-1/16	2.54	65

### 15N26-PT Female Tube-O - Swivel 45° Elbow - Long Pilot with Charge Port for R134a

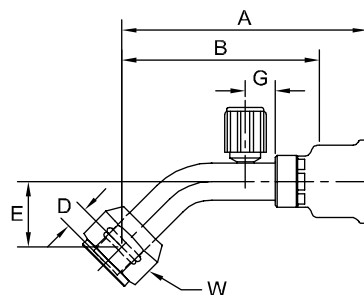

# Part Number	Thread			Hose		A		D		G		E	W	B		
	inch	inch	-	inch	inch	inch	mm	inch	mm	inch	mm	inch	inch	mm		
15N26-8-8-PT	1/2	3/4x16	-8	13/32	-8	3.71	94	0.38	9,8	0.60	15	0.90	23	7/8	2.85	72
15N26-10-12-PT	5/8	7/8x14	-10	5/8	-12	4.13	105	0.38	9,8	0.60	15	1.10	28	1-1/16	3.19	81

+ Non Standard

## 26 Series Fittings

Tube-O Swivel

Use with 201/261, 206, 213, 221FR  
225, 235, 244, 266, 285, and 293 hose.

### 15L26-PR Female Tube-O - Swivel 90° Elbow - Long Pilot with Charge Port for R12

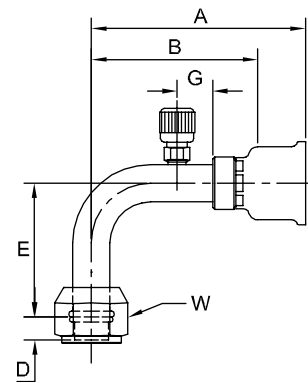

# Part Number	Thread			Hose		A		D		G		E		W	B	
	inch			inch		inch	mm	inch	mm	inch	mm	inch	mm	inch	inch	mm
	inch	mm	mm	inch	mm	inch	mm	inch	mm	inch	mm	inch	mm	inch	inch	mm
15L26-8-8-PR	1/2	3/4x16	-8	13/32	-8	3.23	82	0.38	9,8	0.60	15	1.46	37	7/8	2.37	60
15L26-10-10-PR	5/8	7/8x14	-10	1/2	-10	3.59	91	0.38	9,8	0.60	15	2.25	57	1-1/16	2.63	67
15L26-10-12-PR	5/8	7/8x14	-10	5/8	-12	3.58	91	0.38	9,8	0.60	15	2.25	57	1-1/16	2.64	67

### 15L26-PT Female Tube-O - Swivel 90° Elbow – Long Pilot with Charge Port for R134a

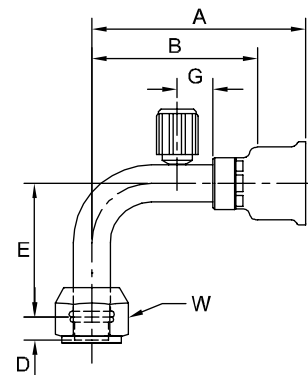

# Part Number	Thread			Hose		A		D		G		E		W	B	
	inch			inch		inch	mm	inch	mm	inch	mm	inch	mm	inch	inch	mm
	inch	mm	mm	inch	mm	inch	mm	inch	mm	inch	mm	inch	mm	inch	inch	mm
15L26-6-6-PT	3/8	5/8x18	-6	5/16	-6	3.05	77	0.28	7.1	0.50	13	1.43	36	3/4	2.19	56
15L26-8-8-PT	1/2	3/4x16	-8	13/32	-8	3.23	82	0.38	9,8	0.60	15	1.46	37	7/8	2.37	60
15L26-10-10-PT	5/8	7/8x14	-10	1/2	-10	3.59	91	0.38	9,8	0.60	15	2.25	57	1-1/16	2.63	67
15L26-10-12-PT	5/8	7/8x14	-10	5/8	-12	3.58	91	0.38	9,8	0.60	15	2.25	57	1-1/16	2.64	67

+ Non Standard

## 26 Series Fittings

Tube-O Swivel / Seal-Lok®

Use with 201/261, 206, 213, 221FR  
225, 235, 244, 266, 285, and 293 hose.

### 15P26-PT Male Tube-O - Swivel 45° Elbow - Long Pilot with Charge Port for R134a

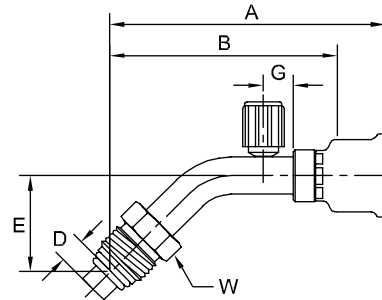

# Part Number	Thread			Hose		A		D		G		E		W		B	
	inch			inch		inch	mm	inch	mm	inch	mm	inch	mm	inch	mm	inch	mm
	15P26-10-12-PT	5/8	7/8x18	-10	5/8	-12	4.03	102	0.38	9,8	0.50	13	1.15	29	7/8	3.09	78

### 1JC26 Female Seal-Lok® - Swivel Straight - Short

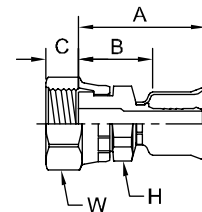

Note: Fittings with an "SM" suffix have a metric hex.  
Note: Seal-Lok® torque table in Section G.  
Note: Seal-Lok® O-Rings are listed in Section F.

# Part Number	Thread			Hose		A		C		H	W	B	
	inch			inch		inch	mm	inch	mm	inch	inch	inch	mm
	1JC26-4-4	1/4	9/16x18	-4	1/4	-4	1.66	42	0.31	8	9/16	11/16	0.79
1JC26-4-4-SM+	1/4	9/16x18	-4	1/4	-4	1.66	42	0.31	8	14 mm	17 mm	0.79	20
1JC26-6-6	3/8	11/16x16	-6	3/8	-6	1.70	43	0.34	9	11/16	13/16	0.84	21
1JC26-6-6-SM+	3/8	11/16x16	-6	3/8	-6	1.70	43	0.34	9	17 mm	22 mm	0.84	21
1JC26-8-8	1/2	13/16x16	-8	1/2	-8	1.76	45	0.43	11	13/16	15/16	0.90	23
1JC26-8-8-SM+	1/2	13/16x16	-8	1/2	-8	1.76	45	0.43	11	22 mm	24 mm	0.90	23
1JC26-10-10	5/8	1x14	-10	5/8	-10	2.00	51	0.48	12	15/16	1-1/8	1.05	27
1JC26-10-10-SM+	5/8	1x14	-10	5/8	-10	2.00	51	0.48	12	24 mm	30 mm	1.05	27
1JC26-12-12	3/4	1-3/16x12	-12	3/4	-12	2.13	54	0.55	14	1-1/8	1-3/8	1.19	30
1JC26-12-12-SM+	3/4	1-3/16x12	-12	3/4	-12	2.13	54	0.55	14	30 mm	36 mm	1.19	30
1JC26-16-16	1	1-7/16x12	-16	1	-16	2.39	61	0.56	14	1-3/8	1-5/8	1.35	34
1JC26-16-16-SM+	1	1-7/16x12	-16	1	-16	2.39	61	0.56	14	36 mm	41 mm	1.35	34
1JC26-20-20	1-1/4	1-11/16x12	-20	1-1/4	-20	2.45	62	0.59	15	1-7/8	1-7/8	1.39	35
1JC26-20-20-SM+	1-1/4	1-11/16x12	-20	1-1/4	-20	2.45	62	0.59	15	50 mm	50 mm	1.39	35
1JC26-24-24-SM+	1-1/2	2x12	-24	1-1/2	-24	2.47	63	0.62	16	60 mm	60 mm	1.39	35

+ Non Standard

## 26 Series Fittings

Use with 201/261, 206, 213, 221FR  
225, 235, 244, 266, 285, and 293 hose.

Seal-Lok®

### 1J726 Female Seal-Lok® - Swivel 45° Elbow

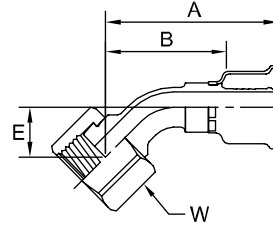

Note: Fittings with an "SM" suffix have a metric hex.  
Note: Seal-Lok® torque table in Section G.  
Note: Seal-Lok® O-Rings are listed in Section F.

# Part Number	Thread			Hose		A		E		W	B	
	inch			inch		inch	mm	inch	mm	inch	inch	mm
	inch	mm	mm	inch	mm	inch	mm	inch	mm	inch	inch	mm
1J726-4-4	1/4	9/16x18	-4	3/16	-4	1.99	51	0.39	10	11/16	1.12	28
1J726-4-4-SM+	1/4	9/16x18	-4	3/16	-4	1.99	51	0.39	10	17 mm	1.12	28
1J726-6-6	3/8	11/16x16	-6	5/16	-6	2.07	53	0.43	11	13/16	1.21	31
1J726-6-6-SM+	3/8	11/16x16	-6	5/16	-6	2.07	53	0.43	11	22 mm	1.21	31
1J726-8-8	1/2	13/16x16	-8	13/32	-8	2.34	59	0.59	15	15/16	1.48	38
1J726-8-8-SM+	1/2	13/16x16	-8	13/32	-8	2.34	59	0.59	15	24 mm	1.48	38
1J726-10-10	5/8	1-3/16x12	-10	1/2	-10	2.80	71	0.65	17	1-3/8	1.84	47
1J726-12-12	3/4	1-3/16x12	-12	5/8	-12	2.89	73	0.81	21	1-3/8	1.95	50
1J726-16-16	1	1-7/16x12	-16	7/8	-16	3.61	92	0.94	24	1-5/8	2.57	65
1J726-20-20	1-1/4	1-11/16x12	-20	1-1/8	-20	3.93	100	1.00	25	1-7/8	2.87	73

### 1J926 Female Seal-Lok® - Swivel 90° Elbow - Short Drop

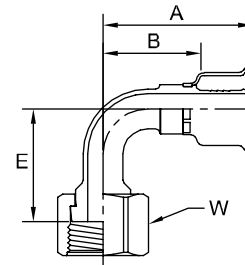

Note: Fittings with an "SM" suffix have a metric hex.  
Note: Seal-Lok® torque table in Section G.  
Note: Seal-Lok® O-Rings are listed in Section F.

# Part Number	Thread			Hose		A		E		W	B	
	inch			inch		inch	mm	inch	mm	inch	inch	mm
	inch	mm	mm	inch	mm	inch	mm	inch	mm	inch	inch	mm
1J926-4-4	1/4	9/16x18	-4	3/16	-4	1.80	46	0.83	21	11/16	0.93	24
1J926-4-4-SM+	1/4	9/16x18	-4	3/16	-4	1.80	46	0.83	21	17 mm	0.93	24
1J926-6-6	3/8	11/16x16	-6	5/16	-6	1.89	48	0.91	23	13/16	1.03	26
1J926-6-6-SM+	3/8	11/16x16	-6	5/16	-6	1.89	48	0.91	23	22 mm	1.03	26
1J926-8-8	1/2	13/16x16	-8	13/32	-8	2.05	52	1.14	29	15/16	1.19	30
1J926-8-8-SM+	1/2	13/16x16	-8	13/32	-8	2.05	52	1.14	29	24 mm	1.19	30
1J926-10-10	5/8	1x14	-10	1/2	-10	2.51	64	1.27	32	1-1/8	1.56	40
1J926-12-12	3/4	1-3/16x12	-12	5/8	-12	3.16	80	1.85	47	1-3/8	2.22	56
1J926-16-16	1	1-7/16x12	-16	7/8	-16	3.56	90	2.21	56	1-5/8	2.52	64
1J926-20-20	1-1/4	1-11/16x12	-20	1-1/8	-20	4.05	103	2.51	64	1-7/8	2.99	76

+ Non Standard



## 26 Series Fittings

Jounce Line / Compressor

Use with 201/261, 206, 213, 221FR  
225, 235, 244, 266, 285, and 293 hose.

### 17B26 Female Air Brake Jounce Line Swivel - Straight

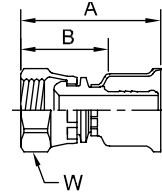

BA - Steel Nut, Brass Nipple, Steel Shell

# Part Number	Thread			Hose		A		W	B	
	inch	inch	-	inch	inch	inch	mm	inch	inch	mm
17B26-8-6BA	1/2	3/4x20	-8	5/16	-6	1.75	44	11/16	0.89	23
17B26-8-8BA	1/2	3/4x20	-8	13/32	-8	1.75	44	11/16	0.89	23

### 15V26 Female Compressor - Swivel 45° Elbow

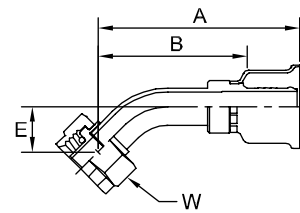

Note: O-Rings are listed in Section F.

# Part Number	Thread			Hose		A		E	W	B	
	inch	inch	-	inch	inch	inch	mm	inch	mm	inch	mm
15V26-12-8	1x14	-12	13/32	-8	3.26	83	0.75	19	1-1/8	2.40	61
15V26-12-12	1x14	-12	5/8	-12	3.39	86	0.76	19	1-1/8	2.45	62

### 15W26 Female Compressor - Swivel 90° Elbow

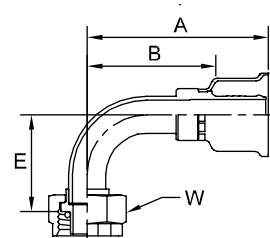

Note: O-Rings are listed in Section F.

# Part Number	Thread			Hose		A		E	W	B	
	inch	inch	-	inch	inch	inch	mm	inch	mm	inch	mm
15W26-12-8	1x14	-12	13/32	-8	2.86	73	1.50	38	1-1/8	2.00	51
15W26-12-12	1x14	-12	5/8	-12	3.04	77	1.63	41	1-1/8	2.10	53

+ Non Standard

**26 Series Fittings**

Use with 201/261, 206, 213, 221FR  
225, 235, 244, 266, 285, and 293 hose.

### 15Z26 Female Compressor - Swivel 90° Elbow - Block Type

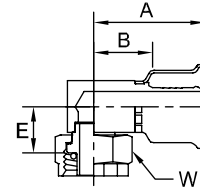

Note: O-Rings are listed in Section F.

# Part Number	Thread		Hose		A		E		W	B	
	inch		inch		inch	mm	inch	mm	inch	inch	mm
	15Z26-12-8	1x14	-12	13/32	-8	1.79	45	0.80	20	1-1/8	0.93
15Z26-12-12	1x14	-12	5/8	-12	1.87	47	0.80	20	1-1/8	0.93	24

### 1RV26 (970237/970239) Compressor Fitting 135° Elbow

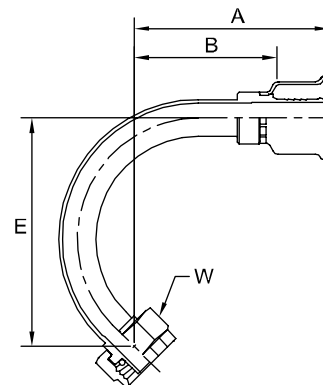

Note: O-Rings are listed in Section F.

# Part Number	Thread		Hose		A		E		W	B	
	inch		inch		inch	mm	inch	mm	inch	inch	mm
	1RV26-12-8	1x14	-12	13/32	-8	3.18	81	3.21	82	1-1/8	2.32
1RV26-12-12	1x14	-12	5/8	-12	3.09	78	3.21	82	1-1/8	2.15	55

### 1RZ26 (970242) Compressor Fitting 180° Block Type

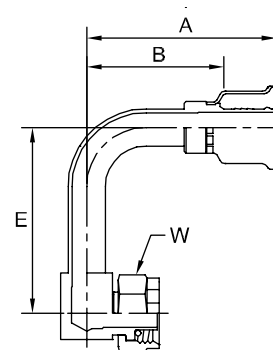

Note: O-Rings are listed in Section F.

# Part Number	Thread		Hose		A		E		W	B	
	inch		inch		inch	mm	inch	mm	inch	inch	mm
	1RZ26-12-12	1x14	-12	5/8	-12	3.18	81	3.13	80	1-1/8	2.24

+ Non Standard

## 26 Series Fittings

Use with 201/261, 206, 213, 221FR  
225, 235, 244, 266, 285, and 293 hose.

### 1T126 Male Refrigerant Tube Mender Straight (with Nut and Ferrule)

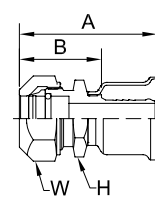

Note: This Parker fitting makes it possible to salvage a steel, stainless steel or aluminum bent tube section from a hose assembly for quick, easy, on the job repairs.

# Part Number	Thread			Hose		A		H	B	
	inch	inch	inch	inch	inch	inch	mm	inch	inch	mm
1T126-6-6	3/8	5/8x18	-6	5/16	-6	1.96	50	11/16	1.10	28
1T126-8-8	1/2	3/4x16	-8	13/32	-8	2.07	53	13/16	1.21	31
1T126-10-10	5/8	7/8x14	-10	1/2	-10	2.28	58	15/16	1.33	34
1T126-10-12	5/8	7/8x14	-10	5/8	-12	2.27	58	15/16	1.33	34
1T126-12-12	3/4	1-16x14	-12	5/8	-12	2.33	59	1-1/8	1.39	35

### 1T126 Fitting Installation Instructions

- Cut the tube off squarely next to the hose fitting. At least 7/8" straight length is required and the outside diameter of the tube should be smooth and free from deep lengthwise scratches.
- To prevent cutting the inside of the O-ring, smoothly chamfer the outside diameter of the cut end 15° to 30°. Deburr the inside diameter.
- Remove the nut, compression sleeve, and O-ring from the fitting and lubricate the O-ring with a lubricant that is compatible with the refrigerant used in the system.
- Place the lubricated O-ring in the counterbore of the fitting.
- Slip the compression sleeve, small end, into the nut and assemble the nut on the fitting fingertight. Make sure the compression sleeve is not cocked in the nut. Back the nut off 1/6 to 1/3 turn (one to two hex flats).
- Insert the chamfered tube end through the nut into the fitting. If high resistance is felt when the end of the tube contacts the O-ring, remove the tube. The end of the tube may require a larger chamfer and/or the O-ring may require more lubrication on the inside diameter. Repeat the previous steps.
- Make sure the tube is bottomed in the fitting
  - tighten the nut finger tight
  - mark the fitting and nut hex indicating the starting point (see illustration) and
  - wrench tighten the nut 1 to 1-1/6 turns (6 to 7 hex flats).
- Later, if it is ever necessary to loosen the connection, re-assemble the nut 1/6 turn (one hex flat) after finger tight.

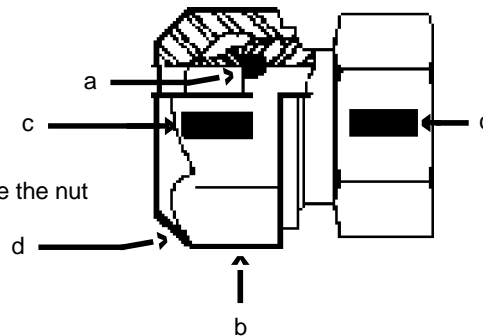

+ Non Standard

## Hose Fittings 26 series

Use with [201-261](#), [206](#), [213](#), [221FR](#), [225](#), [235](#), [244](#), [266](#), [285](#), [293](#), [SS23CG](#) hoses.

### 16726 Male Inverted SAE 45° - Swivel - 45° Elbow

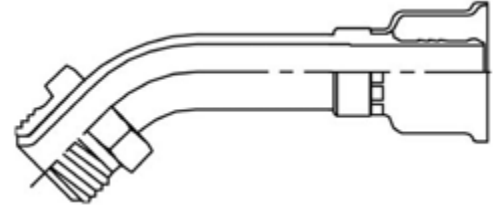

#	Thread		Hose Size	A		E		W	B	
	inch	inch		inch	mm	inch	mm		inch	inch
16726-4-4	1/4	7/16x24	3/16	2.2	56	0.63	16	7/16	1.33	34
16726-5-5	5/16	1/2x20	1/4	2.3	58	0.7	18	1/2	1.43	36
16726-6-6	3/8	5/8x18	5/16	2.75	70	0.94	24	5/8	1.89	48
16726-8-8	1/2	3/4x18	13/32	2.6	66	1.09	28	3/4	1.74	44

+ Non-standard

## Hose Fittings 26 series

Use with [201-261](#), [206](#), [213](#), [221FR](#), [225](#), [235](#), [244](#), [266](#), [285](#), [293](#), [SS23CG](#) hoses.

### 16926 Male Inverted SAE 45° - Swivel - 90° Elbow

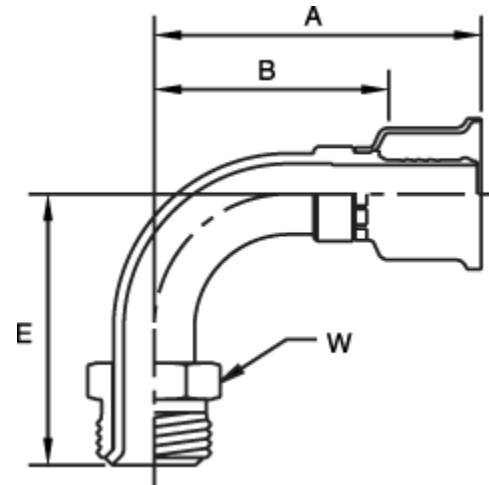

#	Thread			Hose Size		A		E		W	B	
	inch			inch		inch	mm	inch	mm	inch	inch	mm
16926-4-4	1/4	7/16x24	-4	3/16	-4	2.27	58	1.56	40	7/16	1.4	36
16926-5-5	5/16	1/2x20	-5	1/4	-5	2.39	61	1.65	42	1/2	1.52	39
16926-6-6	3/8	5/8x18	-6	5/16	-6	2.41	61	1.69	43	5/8	1.55	39
16926-8-8	1/2	3/4x18	-8	13/32	-8	2.25	57	1.88	48	3/4	1.39	35
16926-10-10	5/8	7/8x18	-10	1/2	-10	3.02	77	2.17	55	7/8	2.07	53

+ Non-standard

## Hose Fittings 26 series

Use with 201-261, 206, 213, 221FR, 225, 235, 244, 266, 285, 293, SS23CG hoses.

### 12826 Male Inverted SAE 45° - Swivel - Straight

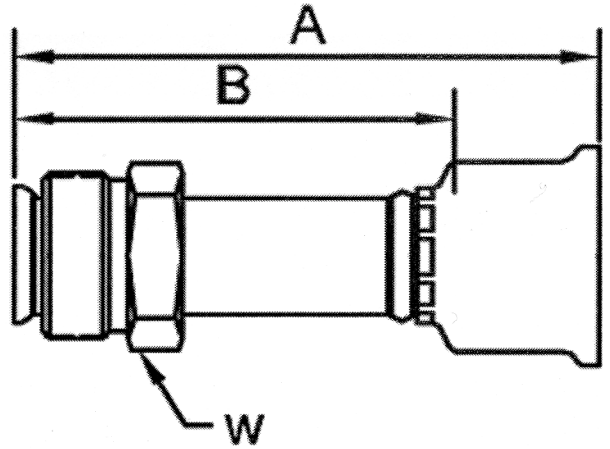

#	Thread			Hose Size		A		W	B	
	inch			inch		inch	mm	inch	inch	mm
12826-4-4	1/4	7/16x24	-4	3/16	-4	2.43	62	7/16	1.56	40
12826-5-5	5/16	1/2x20	-5	1/4	-5	2.56	65	1/2	1.69	43
12826-6-6	3/8	5/8x18	-6	5/16	-6	2.68	68	5/8	1.82	46
12826-8-8	1/2	3/4x18	-8	13/32	-8	3.00	76	3/4	2.14	54
12826-10-10	5/8	7/8x18	-10	1/2	-10	3.01	76	7/8	2.06	52

+ Non-standard