

## 43 Series Fittings

### Table of Contents

#### 43 Series Fittings Base Part Number with Description

#### Table of Contents (page 1 of 2) ..... Page Number

<b>10143</b> Male NPTF Pipe - Rigid Straight .....	B-27
<b>11343</b> Male NPTF Pipe - Swivel - Straight .....	B-28
<b>11L43</b> Male NPTF Pipe - Swivel - 90° Elbow .....	B-28
<b>10243</b> Female NPTF Pipe - Rigid Straight .....	B-29
<b>10743</b> Female NPSM Pipe - Swivel Straight (60° Cone) .....	B-29
<b>1S243</b> Female NPTF Pipe - Swivel - Straight .....	B-30
<b>10543</b> Male SAE Straight Thread with O-Ring Rigid - Straight .....	B-30
<b>10G43</b> Male SAE Straight Thread with O-Ring Swivel - Straight .....	B-31
<b>10L43</b> Male SAE Straight Thread with O-Ring Swivel - 90° Elbow .....	B-31
<b>10343</b> Male JIC 37° - Rigid Straight .....	B-32
<b>1LB43</b> Male JIC 37° Bulkhead without Locknut Straight .....	B-33
<b>WLN</b> Bulkhead Locknut .....	B-33
<b>10643</b> Female JIC 37° - Swivel - Straight .....	B-34—B-35
<b>13743</b> Female JIC 37° - Swivel 45° Elbow - Short Drop .....	B-35
<b>1L743</b> Female JIC 37° - Swivel 45° Elbow - Medium Drop .....	B-36
<b>13943</b> Female JIC 37° - Swivel 90° Elbow - Short Drop .....	B-36—B-37
<b>1L943</b> Female JIC 37° - Swivel 90° Elbow - Medium Drop .....	B-37
<b>14143</b> Female JIC 37° - Swivel 90° Elbow - Long Drop .....	B-38
<b>14V43</b> Female JIC 37° - Swivel 150° Elbow .....	B-39
<b>10443</b> Male SAE 45° - Rigid Straight .....	B-39
<b>10843</b> Female SAE 45° - Swivel Straight .....	B-39
<b>17743</b> Female SAE 45° - Swivel 45° Elbow .....	B-40
<b>17943</b> Female SAE 45° - Swivel 90° Elbow .....	B-40
<b>11143</b> Male Ferulok Flareless - Rigid Straight (24° Cone with Nut and Ferrule) .....	B-41
<b>1GJ43</b> Female Grease Connection Special PTF Taper Thread - Rigid Straight .....	B-41
<b>11243</b> Female Ferulok Flareless - Swivel Straight (24° Cone) .....	B-42
<b>12843</b> Male Inverted SAE 45° - Swivel Straight .....	B-42
<b>16743</b> Male Inverted SAE 45° - Swivel 45° Elbow .....	B-43
<b>16943</b> Male Inverted SAE 45° - Swivel 90° Elbow .....	B-43
<b>1S043</b> Male Hydra-Clip - Rigid Straight .....	B-44
<b>11543</b> SAE Code 61 Flange Head - Straight ISO 12151-3 - S - L .....	B-44
<b>11643</b> SAE Code 61 Flange Head - 22½° Elbow ISO 12151-3 - E22M - L .....	B-45
<b>12643</b> SAE Code 61 Flange Head - 30° Elbow ISO 12151-3 - E30S - L (1 Piece: ISO 12151-3 - E30M - L) .....	B-45
<b>11743</b> SAE Code 61 Flange Head - 45° Elbow ISO 12151-3 - E45S - L (1 Piece: ISO: 12151-3 - E45M - L) .....	B-46
<b>12743</b> SAE Code 61 Flange Head - 60° Elbow ISO 12151-3 - E60S - L (1 Piece: ISO 12151-3 - E60M - L) .....	B-46
<b>11843</b> SAE Code 61 Flange Head - 67½° Elbow ISO 12151-3 - E67S - L (1 Piece: ISO 12151-3 - E67M - L) .....	B-47
<b>11943</b> SAE Code 61 Flange Head - 90° Elbow ISO 12151-3 - E90S - L (1 Piece: ISO 12151-3 - E90M - L) .....	B-47
<b>1J043</b> Male Seal-Lok® - Rigid Straight (with O-Ring) .....	B-48
<b>1JB43</b> Male Seal-Lok® Bulkhead w/o Locknut Straight (w/o O-Ring) .....	B-49

## 43 Series Fittings

### Table of Contents

#### 43 Series Fittings Base Part Number with Description

#### Table of Contents (page 2 of 2) ..... Page Number

<b>WLNL Seal-Lok® Bulkhead Locknut</b> .....	B-49
<b>1JS43 Female Seal-Lok® - Swivel Straight - Long</b> .....	B-50
<b>1JC43 Female Seal-Lok® - Swivel Straight - Short</b> .....	B-51
<b>1J643 Female Seal-Lok® - Swivel 22½° Elbow</b> .....	B-52
<b>1J743 Female Seal-Lok® - Swivel 45° Elbow</b> .....	B-52—B-53
<b>1J943 Female Seal-Lok® - Swivel 90° Elbow - Short Drop</b> .....	B-54
<b>1J543 Female Seal-Lok® - Swivel 90° Elbow - Medium Drop</b> .....	B-55
<b>1J143 Female Seal-Lok® - Swivel 90° Elbow - Long Drop</b> .....	B-56
<b>11D43 Male Standpipe Metric L - Rigid Straight</b> .....	B-57
<b>1D043 Male Metric L - Rigid Straight (24° Cone)</b> .....	B-57
<b>1C043 Female Metric - Swivel Straight (Ball Nose)</b> .....	B-58
<b>1C343 Female Metric L - Swivel Straight (Ball Nose)</b> .....	B-58
<b>1C443 Female Metric L - Swivel 45° Elbow (Ball Nose)</b> .....	B-59
<b>1C543 Female Metric L - Swivel 90° Elbow (Ball Nose)</b> .....	B-59
<b>1CA43 Female Metric L - Swivel Straight (24° Cone with O-Ring)</b> .....	B-60
<b>1CE43 Female Metric L - Swivel 45° Elbow (24° Cone with O-Ring)</b> .....	B-60
<b>1CF43 Female Metric L - Swivel 90° Elbow (24° Cone with O-Ring)</b> .....	B-61
<b>13D43 Male Standpipe Metric S - Rigid Straight</b> .....	B-61
<b>1D243 Male Metric S - Rigid Straight (24° Cone)</b> .....	B-62
<b>1C643 Female Metric S - Swivel Straight (Ball Nose)</b> .....	B-62
<b>1C943 Female Metric S - Swivel Straight (24° Cone with O-Ring)</b> .....	B-63
<b>10C43 Female Metric S - Swivel 45° Elbow (24° Cone with O-Ring)</b> .....	B-63
<b>11C43 Female Metric S - Swivel 90° Elbow (24° Cone with O-Ring)</b> .....	B-64
<b>1D943 Male BSP Parallel Pipe - Rigid Straight (60° Cone)</b> .....	B-64
<b>19243 Female BSP Parallel Pipe - Swivel Straight (60° Cone)</b> .....	B-65
<b>1B143 Female BSP Parallel Pipe - Swivel 45° Elbow (60° Cone)</b> .....	B-65
<b>1B243 Female BSP Parallel Pipe - Swivel 90° Elbow (60° Cone)</b> .....	B-66
<b>1B443 Female BSP Parallel Pipe - Swivel 90° Elbow - Block Type (60° Cone)</b> .....	B-66
<b>1B543 Female BSP Parallel Pipe - Swivel Straight (Flat Seat)</b> .....	B-67
<b>1F443 Female French Gaz Series - Swivel Straight (Ball Nose)</b> .....	B-67
<b>14943 DIN Metric Banjo Straight</b> .....	B-68
<b>1UT43 Male BSP Taper Pipe - Rigid Straight (60° Cone)</b> .....	B-68
<b>AM Banjo Bolt with DIN Metric Thread</b> .....	B-68
<b>1FU43 Female BSP Parallel Pipe - Swivel Straight (30° Flare)</b> .....	B-69
<b>1GU43 Female BSP Parallel Pipe - Swivel Straight (60° Cone)</b> .....	B-69
<b>1MU43 Female Metric - Swivel Straight (30° Flare)</b> .....	B-70
<b>1XU43 Female Metric - Swivel Straight (30° Flare)</b> .....	B-70

**43 Series Fittings**

Use with 301, 301LT, 304, 341, 381, 421, 421HT, 421WC, 424, 431, 436, 451TC, 471, 471ST, 481, 601, 604, and 881 hoses.

## 10143 Male NPTF Pipe - Rigid Straight

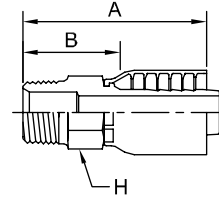

Note: "C" - Stainless Steel Fitting. Must be crimped with Karrykrimp 2, PHastkrimp, Superkrimp, or Parkrimp 2.

Note: Fittings with an "SM" suffix have a metric hex.

# Part Number	Thread		Hose		A		H		B	
	inch		inch		inch	mm	inch	inch	mm	
10143-2-4	1/8x27	-2	1/4	-4	1.80	46	9/16	1.05	27	
10143-2-4C+	1/8x27	-2	1/4	-4	1.80	46	9/16	1.05	27	
10143-4-4	1/4x18	-4	1/4	-4	2.02	51	9/16	1.27	32	
10143-4-4C	1/4x18	-4	1/4	-4	2.02	51	9/16	1.27	32	
10143-4-4-SM+	1/4x18	-4	1/4	-4	1.87	47	17mm	1.12	28	
10143-4-5	1/4x18	-4	5/16	-5	1.95	50	11/16	1.20	30	
10143-4-5C+	1/4x18	-4	5/16	-5	1.95	50	11/16	1.20	30	
10143-4-6	1/4x18	-4	3/8	-6	2.26	57	3/4	1.25	32	
10143-4-6C+	1/4x18	-4	3/8	-6	2.26	57	3/4	1.25	32	
10143-6-4	3/8x18	-6	1/4	-4	1.87	47	11/16	1.12	28	
10143-6-4C+	3/8x18	-6	1/4	-4	1.87	47	11/16	1.12	28	
10143-6-5	3/8x18	-6	5/16	-5	1.95	50	11/16	1.20	30	
10143-6-6	3/8x18	-6	3/8	-6	2.26	57	3/4	1.25	32	
10143-6-6C	3/8x18	-6	3/8	-6	2.26	57	3/4	1.25	32	
10143-6-8	3/8x18	-6	1/2	-8	2.37	60	7/8	1.37	35	
10143-6-10	3/8x18	-6	5/8	-10	2.59	66	15/16	1.18	30	
10143-6-12+	3/8x18	-6	3/4	-12	2.83	72	1-1/16	1.41	36	
10143-8-4	1/2x14	-8	1/4	-4	2.14	54	7/8	1.39	35	
10143-8-6	1/2x14	-8	3/8	-6	2.37	60	7/8	1.37	35	
10143-8-6C+	1/2x14	-8	3/8	-6	2.37	60	7/8	1.37	35	
10143-8-8	1/2x14	-8	1/2	-8	2.63	67	7/8	1.38	35	
10143-8-8C	1/2x14	-8	1/2	-8	2.63	67	7/8	1.38	35	
10143-8-10	1/2x14	-8	5/8	-10	2.59	66	15/16	1.18	30	
10143-8-12	1/2x14	-8	3/4	-12	2.85	72	1-1/16	1.44	37	
10143-12-8	3/4x14	-12	1/2	-8	2.68	68	1-1/16	1.43	36	
10143-12-8C+	3/4x14	-12	1/2	-8	2.68	68	1-1/16	1.43	36	
10143-12-10	3/4x14	-12	5/8	-10	3.01	76	15/16	1.60	41	
10143-12-12	3/4x14	-12	3/4	-12	3.08	78	1-1/16	1.65	42	
10143-12-12C	3/4x14	-12	3/4	-12	3.08	78	1-1/16	1.65	42	
10143-12-16	3/4x14	-12	1	-16	3.38	86	1-3/8	1.79	45	
10143-16-8+	1x11-1/2	-16	1/2	-8	3.07	78	1-3/8	1.82	46	
10143-16-12	1x11-1/2	-16	3/4	-12	3.08	78	1-3/8	1.65	42	
10143-16-16	1x11-1/2	-16	1	-16	3.62	92	1-3/8	2.03	52	
10143-16-16C	1x11-1/2	-16	1	-16	3.62	92	1-3/8	2.03	52	
10143-16-20+	1x11-1/2	-16	1	-20	3.68	93	1-3/4	2.03	52	
10143-16-20C+	1x11-1/2	-16	1	-20	3.68	93	1-3/4	2.03	52	
10143-20-20	1-1/4x11-1/2	-20	1-1/4	-20	4.04	103	1-3/4	2.39	61	
10143-20-20C	1-1/4x11-1/2	-20	1-1/4	-20	4.04	103	1-3/4	2.39	61	
10143-24-20+	1-1/2x11-1/2	-24	1-1/4	-20	4.03	102	2	2.38	60	
10143-24-24	1-1/2x11-1/2	-24	1-1/2	-24	3.78	96	2	2.38	60	
10143-24-24C+	1-1/2x11-1/2	-24	1-1/2	-24	3.78	96	2	2.38	60	
10143-32-32	2x11-1/2	-32	2	-32	4.33	110	2-1/2	2.42	61	
10143-32-32C+	2x11-1/2	-32	2	-32	4.33	110	2-1/2	2.42	61	

+ Non-standard

### 43 Series Fittings

Use with 301, 301LT, 304, 341, 381, 421, 421HT, 421WC, 424, 431, 436, 451TC, 471, 471ST, 481, 601, 604, and 881 hoses.

## 11343 Male NPTF Pipe - Swivel Straight

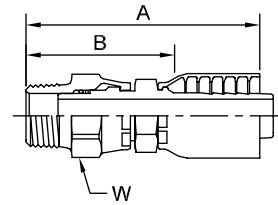

Note: The fitting allows minor movements under pressure to relieve stress on hose. It is **not** to be used for continuous or extensive swiveling.

Note: O-Ring not compatible with Phosphate Ester Fluids.

Note: See Section G – Hose Assemblies – for pressure limitations.

Note: "C" - Stainless Steel Fitting. Must be crimped with Karrykrimp 2, PHastkrimp, Superkrimp, or Parkrimp 2.

# Part Number	Thread		Hose		A		W	B	
	inch		inch		inch	mm	inch	inch	mm
11343-2-4	1/8x27	-2	1/4	-4	3.11	79	5/8	2.36	60
11343-4-4	1/4x18	-4	1/4	-4	2.68	68	5/8	1.93	49
11343-4-6	1/4x18	-4	3/8	-6	2.98	76	5/8	1.98	50
11343-4-6C+	1/4x18	-4	3/8	-6	2.97	75	5/8	1.94	49
11343-6-4	3/8x18	-6	1/4	-4	2.93	74	3/4	2.18	55
11343-6-6	3/8x18	-6	3/8	-6	3.03	77	3/4	2.03	52
11343-6-8	3/8x18	-6	1/2	-8	3.30	84	3/4	2.04	52
11343-8-6	1/2x14	-8	3/8	-6	3.35	85	7/8	2.35	60
11343-8-8	1/2x14	-8	1/2	-8	3.50	89	7/8	2.25	57
11343-8-8C+	1/2x14	-8	1/2	-8	3.50	89	7/8	2.24	57
11343-12-8+	3/4x14	-12	1/2	-8	3.74	95	1-1/4	2.50	63
11343-12-10+	3/4x14	-12	5/8	-10	3.89	99	1-1/4	2.50	63
11343-12-12	3/4x14	-12	3/4	-12	3.91	99	1-1/4	2.50	63
11343-16-16	1x11-1/2	-16	1	-16	4.50	114	1-1/2	2.90	74
11343-16-16C+	1x11-1/2	-16	1	-16	4.50	114	1-1/2	2.90	74

## 11L43 Male NPTF Pipe - Swivel 90° Elbow

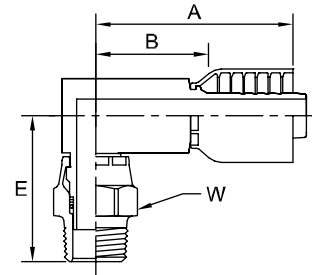

Note: The fitting allows minor movements under pressure to relieve stress on hose. It is **not** to be used for continuous or extensive swiveling.

Note: O-Ring not compatible with Phosphate Ester Fluids.

Note: See Section G – Hose Assemblies – for pressure limitations.

Note: "C" - Stainless Steel Fitting. Must be crimped with Karrykrimp 2, PHastkrimp, Superkrimp, or Parkrimp 2.

# Part Number	Thread		Hose		A		E		W	B	
	inch		inch		inch	mm	inch	mm	inch	inch	mm
11L43-4-4	1/4x18	-4	1/4	-4	2.24	57	1.80	46	5/8	1.49	38
11L43-4-6	1/4x18	-4	3/8	-6	2.53	64	1.86	47	5/8	1.53	39
11L43-6-4+	3/8x18	-6	1/4	-4	2.27	58	1.91	49	3/4	1.52	39
11L43-6-6	3/8x18	-6	3/8	-6	2.51	64	1.91	49	3/4	1.51	38
11L43-6-6C+	3/8x18	-6	3/8	-6	2.51	64	1.91	49	3/4	1.51	38
11L43-8-6	1/2x14	-8	3/8	-6	2.63	67	2.16	55	7/8	1.63	41
11L43-8-8	1/2x14	-8	1/2	-8	2.96	75	2.16	55	7/8	1.71	43
11L43-12-12	3/4x14	-12	3/4	-12	3.88	99	2.45	62	1-1/4	2.36	60
11L43-16-16+	1x11-1/2	-16	1	-16	3.86	98	3.09	78	1-1/2	2.26	57

+ Non-standard

**43 Series Fittings**

Use with 301, 301LT, 304, 341, 381, 421, 421HT, 421WC, 424, 431, 436, 451TC, 471, 471ST, 481, 601, 604, and 881 hoses.

## 10243 Female NPTF Pipe - Rigid Straight

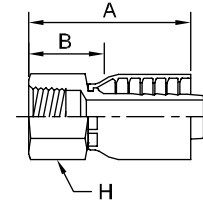

# Part Number	Thread		Hose		A		H	B	
	inch		inch		inch	mm	inch	inch	mm
10243-2-4	1/8x27	-2	1/4	-4	1.69	43	5/8	0.94	24
10243-4-4	1/4x18	-4	1/4	-4	1.79	45	11/16	1.04	26
10243-4-6	1/4x18	-4	3/8	-6	2.03	52	3/4	1.03	26
10243-6-4	3/8x18	-6	1/4	-4	2.06	52	7/8	1.31	33
10243-6-6	3/8x18	-6	3/8	-6	2.30	58	7/8	1.30	33
10243-8-6	1/2x14	-8	3/8	-6	2.38	60	1-1/8	1.38	35
10243-8-8	1/2x14	-8	1/2	-8	2.62	67	1-1/8	1.37	35
10243-12-12	3/4x14	-12	3/4	-12	2.70	69	1-1/4	1.27	32

## 10743 Female NPSM Pipe - Swivel Straight (60° Cone)

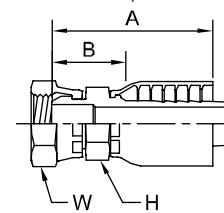

Note: "C" - Stainless Steel Fitting. Must be crimped with Karrykrimp 2, PHastkrimp, Superkrimp, or Parkrimp 2.  
Note: Fittings with an "SM" suffix have a metric hex.

# Part Number	Thread		Hose		A		H	W	B	
	inch		inch		inch	mm	inch	inch	inch	mm
10743-2-4	1/8x27	-2	1/4	-4	1.70	43	9/16	9/16	0.95	24
10743-2-4C+	1/8x27	-2	1/4	-4	2.04	52	9/16	9/16	1.31	33
10743-4-4	1/4x18	-4	1/4	-4	1.74	44	9/16	11/16	0.99	25
10743-6-4+	3/8x18	-6	1/4	-4	1.83	46	11/16	7/8	1.08	27
10743-6-6	3/8x18	-6	3/8	-6	2.27	58	11/16	7/8	1.27	32
10743-6-8+	3/8x18	-6	1/2	-8	2.30	58	15/16	7/8	1.04	26
10743-6-8-SM+	3/8x18	-6	1/2	-8	2.30	58	22 mm	22 mm	1.04	26
10743-8-6+	1/2x14	-8	3/8	-6	2.14	54	15/16	1	1.11	28
10743-8-6-SM+	1/2x14	-8	3/8	-6	2.14	54	22 mm	27 mm	1.11	28
10743-8-8	1/2x14	-8	1/2	-8	2.60	66	15/16	1	1.35	34
10743-12-8+	3/4x14	-12	1/2	-8	2.85	72	1-1/16	1-1/4	1.59	40
10743-12-12	3/4x14	-12	3/4	-12	3.03	77	1-1/16	1-1/4	1.60	41
10743-16-16	1x11-1/2	-16	1	-16	3.44	87	1-3/8	1-1/2	1.85	47
10743-20-20	1-1/4x11-1/2	-20	1-1/4	-20	3.63	92	1-7/8	1-7/8	1.98	50

+ Non-standard

### 43 Series Fittings

Pipe / Straight Thread

Use with 301, 301LT, 304, 341, 381, 421, 421HT, 421WC, 424, 431, 436, 451TC, 471, 471ST, 481, 601, 604, and 881 hoses.

### 1S243 Female NPTF Pipe - Swivel - Straight

Note: The fitting allows minor movements under pressure to relieve stress on hose but is not to be used for continuous or extensive swiveling.

Note: O-Ring not compatible with Phosphate Ester Fluids.

Note: See Section G – Hose Assemblies – for pressure limitations.

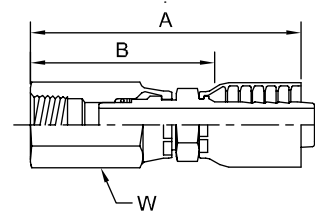

# Part Number	Thread			Hose		A		W	B	
	inch			inch		inch	mm	inch	inch	mm
1S243-4-4	1/4x18		-4	1/4	-4	3.34	85	3/4	2.59	66
1S243-6-4+	3/8x18		-6	1/4	-4	3.46	88	7/8	2.71	69

### 10543 Male SAE Straight Thread with O-Ring Rigid - Straight

Note: O-Ring not compatible with Phosphate Ester Fluids.

Note: "C" - Stainless Steel Fitting. Must be crimped with Karykrimp 2, PHastkrimp, Superkrimp, or Parkrimp 2.

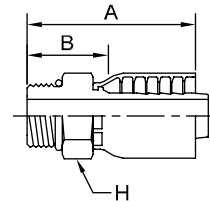

# Part Number	Thread			Hose		A		H	B	
	inch			inch		inch	mm	inch	inch	mm
10543-4-4	1/4	7/16x20	-4	1/4	-4	1.65	42	9/16	0.90	23
10543-4-4C+	1/4	7/16x20	-4	1/4	-4	1.65	42	9/16	0.90	23
10543-5-4	5/16	1/2x20	-5	1/4	-4	1.81	46	5/8	1.06	27
10543-6-4	3/8	9/16x18	-6	1/4	-4	1.68	43	11/16	0.93	24
10543-6-6	3/8	9/16x18	-6	3/8	-6	2.08	53	11/16	1.08	27
10543-6-8	3/8	9/16x18	-6	1/2	-8	2.32	59	13/16	1.07	27
10543-8-6	1/2	3/4x16	-8	3/8	-6	2.09	53	7/8	1.09	28
10543-8-8	1/2	3/4x16	-8	1/2	-8	2.45	62	7/8	1.20	30
10543-8-8C+	1/2	3/4x16	-8	1/2	-8	2.45	62	7/8	1.20	30
10543-8-10+	1/2	3/4x16	-8	5/8	-10	2.63	67	1	1.19	30
10543-10-6	5/8	7/8x14	-10	3/8	-6	2.11	54	1	1.11	28
10543-10-8	5/8	7/8x14	-10	1/2	-8	2.35	60	1	1.10	28
10543-10-8C+	5/8	7/8x14	-10	1/2	-8	2.35	60	1	1.10	28
10543-10-10	5/8	7/8x14	-10	5/8	-10	2.71	69	1	1.30	33
10543-10-12+	5/8	7/8x14	-10	3/4	-12	2.76	70	1-1/4	1.34	34
10543-12-8	3/4	1-1/16x12	-12	1/2	-8	2.61	66	1-1/4	1.36	35
10543-12-10	3/4	1-1/16x12	-12	5/8	-10	2.78	71	1-1/4	1.37	35
10543-12-12	3/4	1-1/16x12	-12	3/4	-12	2.79	71	1-1/4	1.36	35
10543-12-12C+	3/4	1-1/16x12	-12	3/4	-12	2.79	71	1-1/4	1.36	35
10543-16-12	1	1-5/16x12	-16	3/4	-12	2.79	71	1-1/2	1.36	35
10543-16-16	1	1-5/16x12	-16	1	-16	3.35	85	1-1/2	1.76	45
10543-16-16C+	1	1-5/16x12	-16	1	-16	3.35	85	1-1/2	1.76	45
10543-20-20	1-1/4	1-5/8x12	-20	1-1/4	-20	3.65	93	1-7/8	2.00	51
10543-20-20C+	1-1/4	1-5/8x12	-20	1-1/4	-20	3.65	93	1-7/8	2.00	51
10543-24-24+	1-1/2	1-7/8x12	-24	1-1/2	-24	3.12	79	2-1/8	1.79	45
10543-32-32+	2	2-1/2x12	-32	2	-32	3.62	92	1-7/8	1.84	47

+ Non-standard

### 43 Series Fittings

Straight Thread

Use with 301, 301LT, 304, 341, 381, 421, 421HT, 421WC, 424, 431, 436, 451TC, 471, 471ST, 481, 601, 604, and 881 hoses.

## 10G43 Male SAE Straight Thread with O-Ring Swivel - Straight

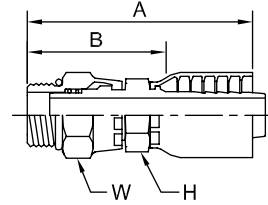

Note: The fitting allows minor movements under pressure to relieve stress on hose. It is not to be used for continuous or extensive swiveling.

Note: O-Ring not compatible with Phosphate Ester Fluids.

Note: See Section G – Hose Assemblies – for pressure limitations.

# Part Number	Thread			Hose		A		H	W	B	
	inch	inch	inch	inch	inch	inch	mm	inch	inch	inch	mm
10G43-5-4	5/16	1/2x20	-5	1/4	-4	3.07	78	-	3/4	2.32	59
10G43-6-4	3/8	9/16x18	-6	1/4	-4	3.10	79	-	3/4	2.35	60
10G43-6-6	3/8	9/16x18	-6	3/8	-6	3.14	80	-	3/4	2.14	54
10G43-8-6	1/2	3/4x16	-8	3/8	-6	3.06	78	11/16	7/8	2.06	52
10G43-8-8	1/2	3/4x16	-8	1/2	-8	3.19	81	-	7/8	1.94	49
10G43-8-10+	1/2	3/4x16	-8	5/8	-10	3.42	87	15/16	7/8	2.08	53
10G43-10-6	5/8	7/8x14	-10	3/8	-6	3.01	76	11/16	1	2.01	51
10G43-10-8	5/8	7/8x14	-10	1/2	-8	3.31	84	-	1	2.06	52
10G43-12-12	3/4	1-1/16x12	-12	3/4	-12	3.62	92	1-1/16	1-1/4	2.19	56

## 10L43 Male SAE Straight Thread with O-Ring Swivel - 90° Elbow

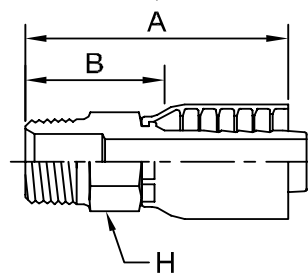

Note: The fitting allows minor movements under pressure to relieve stress on hose. It is not to be used for continuous or extensive swiveling.

Note: O-Ring not compatible with Phosphate Ester Fluids.

Note: See Section G – Hose Assemblies – for pressure limitations.

Note: "C" - Stainless Steel Fitting. Must be crimped with Karykrimp 2, PHastkrimp, Superkrimp, or Parkrimp 2.

# Part Number	Thread			Hose		A		E		W	B	
	inch	inch	inch	inch	inch	inch	mm	inch	mm	inch	inch	mm
10L43-4-4+	1/4	7/16x20	-4	1/4	-4	2.33	59	1.96	50	5/8	1.48	38
10L43-6-4+	3/8	9/16x18	-6	1/4	-4	2.27	58	2.43	62	3/4	1.52	39
10L43-6-6	3/8	9/16x18	-6	3/8	-6	2.51	64	2.08	53	3/4	1.50	38
10L43-8-6	1/2	3/4x16	-8	3/8	-6	2.64	67	1.86	47	7/8	1.64	42
10L43-8-8	1/2	3/4x16	-8	1/2	-8	2.96	75	1.86	47	7/8	1.71	43
10L43-8-8C+	1/2	3/4x16	-8	1/2	-8	2.96	75	1.86	47	7/8	1.71	43
10L43-8-12+	1/2	3/4x16	-8	3/4	-12	3.30	84	2.01	51	7/8	1.88	48
10L43-10-8	5/8	7/8x14	-10	1/2	-8	2.96	75	1.92	49	1	1.71	43
10L43-12-12	3/4	1-1/16x12	-12	3/4	-12	3.15	80	2.46	62	1-1/4	1.87	47

+ Non-standard

**43 Series Fittings**

Use with 301, 301LT, 304, 341, 381, 421, 421HT, 421WC, 424, 431, 436, 451TC, 471, 471ST, 481, 601, 604, and 881 hoses.

**10343 Male JIC 37° - Rigid Straight**

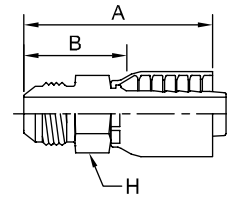

^ Must use Parkrimp 2 or Superkrimp and Die Part No. 83C-A20H.  
 Note: "C" - Stainless Steel Fitting. Must be crimped with Karrykrimp 2, PHastkrimp, Superkrimp, or Parkrimp 2.

Fittings  
43 Series

**B**

# Part Number	Thread			Hose		A		H	B	
	inch			inch		inch	mm	inch	inch	mm
	1/4	7/16x20	-4	1/4	-4					
10343-4-4	1/4	7/16x20	-4	1/4	-4	2.00	51	9/16	1.25	32
10343-4-4C+	1/4	7/16x20	-4	1/4	-4	1.97	50	9/16	1.24	31
10343-4-6+	1/4	7/16x20	-4	3/8	-6	2.23	57	3/4	1.23	31
10343-5-4	5/16	1/2x20	-5	1/4	-4	1.84	47	9/16	1.09	28
10343-5-5+	5/16	1/2x20	-5	5/16	-5	1.92	49	9/16	1.17	30
10343-5-6	5/16	1/2x20	-5	3/8	-6	2.24	57	3/4	1.24	31
10343-5-8+	5/16	1/2x20	-5	1/2	-8	2.57	65	7/8	1.31	33
10343-6-4	3/8	9/16x18	-6	1/4	-4	1.85	47	11/16	1.10	28
10343-6-5+	3/8	9/16x18	-6	5/16	-5	2.18	55	3/4	1.43	36
10343-6-6	3/8	9/16x18	-6	3/8	-6	2.38	60	3/4	1.38	35
10343-6-8+	3/8	9/16x18	-6	1/2	-8	2.58	66	7/8	1.32	34
10343-8-6	1/2	3/4x16	-8	3/8	-6	2.28	58	7/8	1.28	33
10343-8-8	1/2	3/4x16	-8	1/2	-8	2.68	68	7/8	1.43	36
10343-8-8C+	1/2	3/4x16	-8	1/2	-8	2.68	68	7/8	1.43	36
10343-8-10	1/2	3/4x16	-8	5/8	-10	3.01	76	15/16	1.60	41
10343-10-6	5/8	7/8x14	-10	3/8	-6	2.38	60	15/16	1.38	35
10343-10-8	5/8	7/8x14	-10	1/2	-8	2.62	67	15/16	1.37	35
10343-10-10	5/8	7/8x14	-10	5/8	-10	2.85	72	7/8	1.41	36
10343-10-12+	5/8	7/8x14	-10	3/4	-12	3.04	77	1-1/8	1.56	40
10343-12-8	3/4	1-1/16x12	-12	1/2	-8	2.76	70	1-1/8	1.51	38
10343-12-10	3/4	1-1/16x12	-12	5/8	-10	3.05	77	1-1/8	1.64	42
10343-12-12	3/4	1-1/16x12	-12	3/4	-12	3.17	81	1-1/8	1.75	44
10343-12-12C+	3/4	1-1/16x12	-12	3/4	-12	3.17	81	1-1/8	1.75	44
10343-14-12	7/8	1-3/16x12	-14	3/4	-12	3.09	78	1-1/4	1.66	42
10343-16-12	1	1-5/16x12	-16	3/4	-12	3.02	77	1-3/8	1.59	40
10343-16-16	1	1-5/16x12	-16	1	-16	3.63	92	1-3/8	1.74	44
10343-20-12+	1-1/4	1-5/8x12	-20	3/4	-12	3.12	79	1-7/8	1.70	43
10343-20-20	1-1/4	1-5/8x12	-20	1-1/4	-20	3.96	101	1-7/8	2.27	58
10343-20-20C+	1-1/4	1-5/8x12	-20	1-1/4	-20	3.92	100	1-7/8	2.27	58
10343-24-20^	1-1/2	1-7/8x12	-24	1-1/4	-20	3.67	93	2	2.02	51
10343-24-24+	1-1/2	1-7/8x12	-24	1-1/2	-24	3.34	85	2	1.97	50
10343-32-32+	2	2-1/2x12	-32	2	-32	4.30	109	2-5/8	2.52	64

+ Non-standard



### 43 Series Fittings

Use with 301, 301LT, 304, 341, 381, 421, 421HT, 421WC, 424, 431, 436, 451TC, 471, 471ST, 481, 601, 604, and 881 hoses.

## 1LB43 Male JIC 37° Bulkhead without Locknut Straight

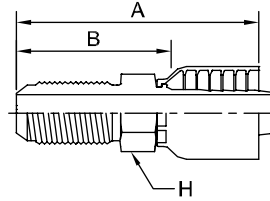

Note: These fittings are stocked minus the locknut (part no. WLN). Locknuts are manufactured by the Tube Fittings Division of Parker Hannifin and must be ordered separately.

# Part Number	Thread			Hose		A		H	B	
	inch			inch		inch	mm	inch	inch	mm
1LB43-4-4	1/4	7/16x20	-4	1/4	-4	2.65	67	9/16	1.90	48
1LB43-6-6	3/8	9/16x18	-6	3/8	-6	3.08	78	3/4	2.05	52
1LB43-8-6+	1/2	3/4x16	-8	3/8	-6	3.24	82	7/8	2.21	56
1LB43-8-8	1/2	3/4x16	-8	1/2	-8	3.46	88	7/8	2.20	56
1LB43-10-10	5/8	7/8x14	-10	5/8	-10	3.85	98	15/16	2.41	61
1LB43-12-12	3/4	1-1/16x12	-12	3/4	-12	4.08	104	1-1/8	2.64	67

## WLN Bulkhead Locknut

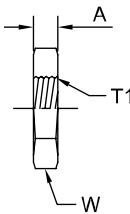

# TFD Part Number	T1 Thread		A		W
			inch	mm	
4 WLN-S	1/4	7/16x20	0.25	6	11/16
6 WLN-S	3/8	9/16x18	0.27	7	13/16
8 WLN-S	1/2	3/4x16	0.31	8	1
10 WLN-S	5/8	7/8x14	0.36	9	1-1/8
12 WLN-S	3/4	1-1/16x12	0.41	10	1-3/8

+ Non-standard

**43 Series Fittings**

Use with 301, 301LT, 304, 341, 381, 421, 421HT, 421WC, 424, 431, 436, 451TC, 471, 471ST, 481, 601, 604, and 881 hoses.

**10643 Female JIC 37° - Swivel Straight**

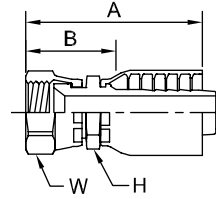

~ These 10643 fittings contain a dual seat that accepts both the JIC (37 deg.) and SAE (45 deg.) male configurations. The -6 and -12 SAE 45 deg. swivel fittings are shown under part number 10843.

Note: "C" - Stainless Steel Fitting. Must be crimped with Karykrimp 2, PHastkrimp, Superkrimp, or Parkrimp 2.

# Part Number	Thread			Hose		A		H	W	B	
	inch	mm	inch	inch	inch	inch	mm	inch	inch	inch	mm
10643-4-4~	1/4	7/16x20	-4	1/4	-4	1.94	49	9/16	9/16	1.19	30
10643-4-4C~	1/4	7/16x20	-4	1/4	-4	1.94	49	9/16	9/16	1.19	30
10643-4-5+~	1/4	7/16X20	-4	5/16	-5	2.02	50	11/16	9/16	1.27	30
10643-4-6~	1/4	7/16x20	-4	3/8	-6	2.20	56	11/16	9/16	1.17	30
10643-4-6C~+	1/4	7/16x20	-4	3/8	-6	2.20	56	11/16	9/16	1.17	30
10643-5-4~	5/16	1/2x20	-5	1/4	-4	2.03	52	9/16	5/8	1.28	33
10643-5-5~	5/16	1/2x20	-5	5/16	-5	2.08	53	11/16	5/8	1.33	34
10643-5-6~	5/16	1/2x20	-5	3/8	-6	2.26	57	11/16	5/8	1.23	31
10643-5-6C~+	5/16	1/2x20	-5	3/8	-6	2.26	57	11/16	5/8	1.23	31
10643-6-4	3/8	9/16x18	-6	1/4	-4	2.05	52	9/16	11/16	1.30	33
10643-6-4C+	3/8	9/16x18	-6	1/4	-4	2.05	52	9/16	11/16	1.30	33
10643-6-5	3/8	9/16x18	-6	5/16	-5	2.10	53	11/16	11/16	1.35	34
10643-6-6	3/8	9/16x18	-6	3/8	-6	2.29	58	11/16	11/16	1.26	32
10643-6-6C	3/8	9/16x18	-6	3/8	-6	2.29	58	11/16	11/16	1.26	32
10643-6-8	3/8	9/16x18	-6	1/2	-8	2.51	64	13/16	11/16	1.25	32
10643-8-4~+	1/2	3/4x16	-8	1/4	-4	2.22	56	11/16	7/8	1.47	37
10643-8-6~	1/2	3/4x16	-8	3/8	-6	2.49	63	11/16	7/8	1.46	37
10643-8-8~	1/2	3/4x16	-8	1/2	-8	2.63	67	13/16	7/8	1.37	35
10643-8-8C~	1/2	3/4x16	-8	1/2	-8	2.63	67	13/16	7/8	1.37	35
10643-8-10~	1/2	3/4x16	-8	5/8	-10	2.82	72	15/16	7/8	1.38	35
10643-8-12~	1/2	3/4x16	-8	3/4	-12	2.83	72	1-1/16	7/8	1.39	35
10643-8-12C~+	1/2	3/4x16	-8	3/4	-12	2.83	72	1-1/16	7/8	1.39	35
10643-8-16~+	1/2	3/4x16	-8	1	-16	3.27	82	1-1/4	7/8	1.65	41
10643-10-6~	5/8	7/8x14	-10	3/8	-6	2.51	64	7/8	1	1.48	38
10643-10-6C~+	5/8	7/8x14	-10	3/8	-6	2.51	64	7/8	1	1.48	38
10643-10-8~	5/8	7/8x14	-10	1/2	-8	2.85	72	7/8	1	1.59	40
10643-10-8C~+	5/8	7/8x14	-10	1/2	-8	2.85	72	7/8	1	1.59	40
10643-10-10~	5/8	7/8x14	-10	5/8	-10	2.93	74	15/16	1	1.49	38
10643-10-10C~	5/8	7/8x14	-10	5/8	-10	2.93	74	15/16	1	1.49	38
10643-10-12~	5/8	7/8x14	-10	3/4	-12	2.93	74	1-1/16	1	1.49	38
10643-12-8	3/4	1-1/16x12	-12	1/2	-8	2.78	71	1-1/16	1-1/4	1.52	39
10643-12-10	3/4	1-1/16x12	-12	5/8	-10	3.10	79	1-1/16	1-1/4	1.66	42
10643-12-12	3/4	1-1/16x12	-12	3/4	-12	3.17	81	1-1/16	1-1/4	1.73	44
10643-12-12C	3/4	1-1/16x12	-12	3/4	-12	3.17	81	1-1/16	1-1/4	1.73	44
10643-12-16	3/4	1-1/16x12	-12	1	-16	3.29	84	1-3/8	1-1/4	1.67	42
10643-12-16C+	3/4	1-1/16x12	-12	1	-16	3.29	84	1-3/8	1-1/4	1.67	42
10643-14-12	7/8	1-3/16x12	-14	3/4	-12	3.18	81	1-1/4	1-3/8	1.74	44
10643-16-12	1	1-5/16x12	-16	3/4	-12	3.31	84	1-1/4	1-1/2	1.87	47
10643-16-12C+	1	1-5/16X12	-16	3/4	-12	3.31	83	1-1/4	1-1/2	1.87	47
10643-16-16	1	1-5/16x12	-16	1	-16	3.62	92	1-3/8	1-1/2	2.00	51
10643-16-16C	1	1-5/16x12	-16	1	-16	3.62	92	1-3/8	1-1/2	2.00	51
10643-16-20+	1	1-5/16x12	-16	1-1/4	-20	3.81	97	1-7/8	1-1/2	2.12	54

Note: More sizes of this fitting are located on the following page.

+ Non-standard

### 43 Series Fittings

Use with 301, 301LT, 304, 341, 381, 421, 421HT, 421WC, 424, 431, 436, 451TC, 471, 471ST, 481, 601, 604, and 881 hoses.

## 10643 Female JIC 37° - Swivel Straight

Note: More sizes of this fitting are located on the previous page.

# Part Number	Thread			Hose		A		H	W	B	
	inch			inch		inch	mm	inch	inch	inch	mm
	inch	mm	UNF	inch	mm	inch	mm	inch	inch	inch	mm
10643-20-16	1-1/4	1-5/8x12	-20	1	-16	3.81	97	1-5/8	2	2.19	56
10643-20-20	1-1/4	1-5/8x12	-20	1-1/4	-20	3.94	100	1-7/8	2	2.25	57
10643-20-20C	1-1/4	1-5/8x12	-20	1-1/4	-20	3.94	100	1-7/8	2	2.25	57
10643-20-24+	1-1/4	1-5/8x12	-20	1-1/4	-20	3.65	91	2	2	2.28	58
10643-24-20C+	1-1/2	1-7/8x12	-24	1-1/4	-20	4.13	105	2-1/8	2-1/4	2.44	62
10643-24-24	1-1/2	1-7/8x12	-24	1-1/2	-24	3.84	98	2-1/8	2-1/4	2.47	63
10643-24-24C+	1-1/2	1-7/8x12	-24	1-1/2	-24	3.84	98	2-1/8	2-1/4	2.47	63
10643-32-20+	2	2-1/2x12	-32	1-1/4	-20	4.62	117	2-1/2	2-7/8	2.93	74
10643-32-32	2	2-1/2x12	-32	2	-32	4.74	120	2-1/2	2-7/8	2.96	75
10643-32-32C+	2	2-1/2x12	-32	2	-32	4.74	120	2-1/2	2-7/8	2.96	75

## 13743 Female JIC 37° - Swivel 45° Elbow - Short Drop

~ These 13743 fittings contain a dual seat that accepts both the JIC (37°) and SAE (45°) male configurations. The other sizes accept the JIC (37°) male configurations only.

Note: "C" - Stainless Steel Fitting. Must be crimped with Karrykrimp 2, PHastkrimp, Superkrimp, or Parkrimp 2.

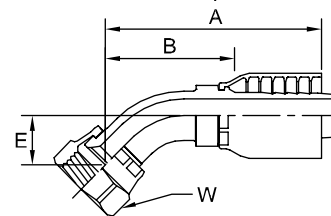

# Part Number	Thread			Hose		A		E		W	B	
	inch			inch		inch	mm	inch	mm	inch	inch	mm
	inch	mm	UNF	inch	mm	inch	mm	inch	mm	inch	inch	mm
13743-4-4~	1/4	7/16x20	-4	1/4	-4	1.96	50	0.39	10	9/16	1.21	31
13743-4-4C~+	1/4	7/16x20	-4	1/4	-4	1.96	50	0.33	8	9/16	1.21	31
13743-5-4~	5/16	1/2x20	-5	1/4	-4	2.19	56	0.39	10	5/8	1.44	37
13743-6-4	3/8	9/16x18	-6	1/4	-4	2.23	57	0.39	10	11/16	1.48	38
13743-6-5+	3/8	9/16x18	-6	5/16	-5	2.32	59	0.39	10	11/16	1.57	40
13743-6-6	3/8	9/16x18	-6	3/8	-6	2.39	61	0.39	10	11/16	1.39	35
13743-6-6C+	3/8	9/16x18	-6	3/8	-6	2.35	60	0.39	10	11/16	1.32	34
13743-6-8+	3/8	9/16x18	-6	1/2	-8	2.58	66	0.39	10	11/16	1.33	34
13743-8-5~+	1/2	3/4x16	-8	5/16	-5	2.56	65	0.55	14	7/8	1.75	44
13743-8-6~	1/2	3/4x16	-8	3/8	-6	2.74	70	0.55	14	7/8	1.74	44
13743-8-8~	1/2	3/4x16	-8	1/2	-8	2.88	73	0.55	14	7/8	1.63	41
13743-10-8~	5/8	7/8x14	-10	1/2	-8	2.97	75	0.63	16	1	1.71	43
13743-10-10~	5/8	7/8x14	-10	5/8	-10	3.17	81	0.63	16	1	1.73	44
13743-10-10C~+	5/8	7/8x14	-10	5/8	-10	3.29	84	0.64	16	1	1.88	48
13743-12-8+	3/4	1-1/16x12	-12	1/2	-8	3.08	78	0.70	18	1-1/4	1.83	46
13743-12-10	3/4	1-1/16x12	-12	5/8	-10	3.62	92	0.83	21	1-1/4	2.08	53
13743-12-12	3/4	1-1/16x12	-12	3/4	-12	3.57	91	0.78	20	1-1/4	2.14	54
13743-14-12+	7/8	1-3/16x12	-14	3/4	-12	3.65	93	0.86	22	1-3/8	2.21	56
13743-16-16	1	1-5/16x12	-16	1	-16	4.08	104	0.90	23	1-1/2	2.49	63
13743-20-16+	1-1/4	1-5/8x12	-20	1	-16	4.17	106	1.01	26	2	2.57	65
13743-20-20	1-1/4	1-5/8x12	-20	1-1/4	-20	4.59	117	1.19	30	2	2.82	72
13743-20-20C+	1-1/4	1-5/8x12	-20	1-1/4	-20	4.59	117	1.19	30	2	2.90	74
13743-24-24+	1-1/2	1-7/8x12	-24	1-1/2	-24	5.50	140	1.47	37	2-1/4	4.18	106
13743-32-32+	2	2-1/2x12	-32	2	-32	7.34	186	2.08	53	2-7/8	5.56	141

+ Non-standard

### 43 Series Fittings

Use with 301, 301LT, 304, 341, 381, 421, 421HT, 421WC, 424, 431, 436, 451TC, 471, 471ST, 481, 601, 604, and 881 hoses.

## 1L743 Female JIC 37° - Swivel 45° Elbow - Medium Drop

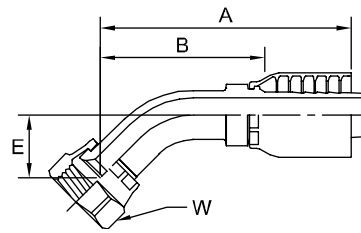

~ These 1L743 fittings contain a dual seat that accepts both the JIC (37°) and SAE (45°) male configurations. The other sizes accept the JIC (37°) male configurations only.

# Part Number	Thread			Hose		A		E		W	B	
	inch			inch		inch	mm	inch	mm	inch	inch	mm
	1L743-6-6	3/8	9/16x18	-6	3/8	-6	2.66	62	0.59	15	11/16	1.66
1L743-8-8~	1/2	3/4x16	-8	1/2	-8	3.18	81	0.72	19	7/8	1.93	49
1L743-12-12	3/4	1-1/16x12	-12	3/4	-12	4.23	105	1.06	27	1-1/4	2.71	69
1L743-16-16	1	1-5/16x12	-16	1	-16	4.52	115	1.10	28	1-1/2	2.93	74

## 13943 Female JIC 37° - Swivel 90° Elbow - Short Drop

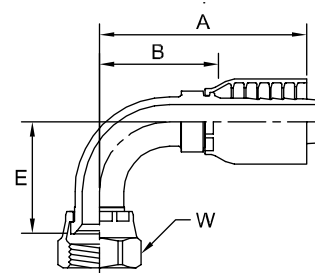

~ These 13943 fittings contain a dual seat that accepts both the JIC (37°) and SAE (45°) male configurations. The other sizes accept the JIC (37°) male configurations only.

Note: "C" - Stainless Steel Fitting. Must be crimped with Karrykrimp 2, PHastkrimp, Superkrimp, or Parkrimp 2.

# Part Number	Thread			Hose		A		E		W	B	
	inch			inch		inch	mm	inch	mm	inch	inch	mm
	13943-4-4~	1/4	7/16x20	-4	1/4	-4	1.79	45	0.83	21	9/16	1.04
13943-4-4C~+	1/4	7/16x20	-4	1/4	-4	1.78	45	0.83	21	9/16	1.03	26
13943-4-6~	1/4	7/16x20	-4	3/8	-6	2.11	54	0.83	21	9/16	1.08	27
13943-5-4~	5/16	1/2x20	-5	1/4	-4	2.18	55	0.83	21	5/8	1.43	36
13943-5-5~	5/16	1/2x20	-5	5/16	-5	2.27	58	0.83	21	5/8	1.52	39
13943-5-6~+	5/16	1/2x20	-5	3/8	-6	2.28	58	0.77	20	5/8	1.28	33
13943-6-4	3/8	9/16x18	-6	1/4	-4	2.13	54	0.85	22	11/16	1.38	35
13943-6-5+	3/8	9/16x18	-6	5/16	-5	2.22	56	0.85	22	11/16	1.47	37
13943-6-6	3/8	9/16x18	-6	3/8	-6	2.28	58	0.85	22	11/16	1.28	33
13943-6-6C+	3/8	9/16x18	-6	3/8	-6	2.28	58	0.85	22	11/16	1.28	33
13943-6-8	3/8	9/16x18	-6	1/2	-8	2.52	64	0.85	22	11/16	1.27	32
13943-8-6~	1/2	3/4x16	-8	3/8	-6	2.50	64	1.09	28	7/8	1.50	38
13943-8-6C~+	1/2	3/4x16	-8	3/8	-6	2.50	64	1.09	28	7/8	1.50	38
13943-8-8~	1/2	3/4x16	-8	1/2	-8	2.65	67	1.09	28	7/8	1.40	36
13943-10-8~	5/8	7/8x14	-10	1/2	-8	2.78	71	1.26	32	1	1.52	39
13943-10-10~	5/8	7/8x14	-10	5/8	-10	3.09	78	1.24	31	1	1.58	40
13943-10-12~+	5/8	7/8x14	-10	3/4	-12	3.10	79	1.24	31	1	1.66	42
13943-12-8	3/4	1-1/16x12	-12	1/2	-8	3.17	81	1.81	46	1-1/4	1.92	49
13943-12-10	3/4	1-1/16x12	-12	5/8	-10	3.49	89	1.89	48	1-1/4	2.05	52
13943-12-12	3/4	1-1/16x12	-12	3/4	-12	3.51	89	1.81	46	1-1/4	2.07	53
13943-12-12C+	3/4	1-1/16x12	-12	3/4	-12	3.51	89	1.81	46	1-1/4	2.07	53

Note: More sizes of this fitting are located on the following page.

+ Non-standard

### 43 Series Fittings

Use with 301, 301LT, 304, 341, 381, 421, 421HT, 421WC, 424, 431, 436, 451TC, 471, 471ST, 481, 601, 604, and 881 hoses.

## 13943 Female JIC 37° - Swivel 90° Elbow - Short Drop

Note: More sizes of this fitting are located on the previous page.

# Part Number	Thread			Hose		A		E		W	B	
	inch	inch	inch	inch	inch	inch	mm	inch	mm	inch	inch	mm
13943-16-12	1	1-5/16x12	-16	3/4	-12	3.47	88	2.00	51	1-1/2	2.05	52
13943-16-16	1	1-5/16x12	-16	1	-16	4.05	103	2.14	54	1-1/2	2.46	62
13943-16-16C+	1	1-5/16x12	-16	1	-16	4.32	110	2.43	62	1-1/2	2.70	69
13943-20-16+	1-1/4	1-5/8x12	-20	1	-16	1.00	25	2.44	62	2	2.28	58
13943-20-20	1-1/4	1-5/8x12	-20	1-1/4	-20	4.38	111	2.59	66	2	2.73	69
13943-24-24+	1-1/2	1-7/8x12	-24	1-1/2	-24	5.46	139	3.18	81	2-1/4	4.17	106
13943-32-32+	2	2-1/2x12	-32	2	-32	6.50	165	4.61	117	2-7/8	4.97	126

## 1L943 Female JIC 37° - Swivel 90° Elbow - Medium Drop

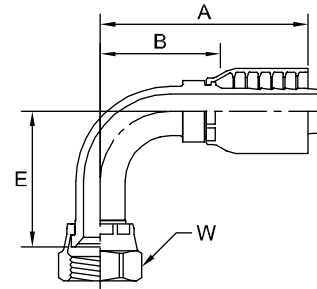

~ These 1L943 fittings contain a dual seat that accepts both the JIC (37°) and SAE (45°) male configurations. The other sizes accept the JIC (37°) male configurations only.

# Part Number	Thread			Hose		A		E		W	B	
	inch	inch	inch	inch	inch	inch	mm	inch	mm	inch	inch	mm
1L943-4-4~	1/4	7/16x20	-4	1/4	-4	1.85	47	1.26	32	9/16	1.10	28
1L943-6-4+	3/8	9/16x18	-6	1/4	-4	2.13	54	1.12	28	11/16	1.38	35
1L943-6-6	3/8	9/16x18	-6	3/8	-6	2.28	58	1.12	28	11/16	1.28	33
1L943-8-6~	1/2	3/4x16	-8	3/8	-6	2.50	64	1.38	35	7/8	1.50	38
1L943-8-8~	1/2	3/4x16	-8	1/2	-8	2.65	67	1.38	35	7/8	1.40	36
1L943-10-8~	5/8	7/8x14	-10	1/2	-8	3.25	83	1.75	44	1	2.00	51
1L943-12-12	3/4	1-1/16x12	-12	3/4	-12	3.50	89	2.28	58	1-1/4	2.22	56
1L943-16-16	1	1-5/16x12	-16	1	-16	4.42	112	2.50	64	1-1/2	2.83	72

+ Non-standard



**43 Series Fittings**

Use with 301, 301LT, 304, 341, 381, 421, 421HT, 421WC, 424, 431, 436, 451TC, 471, 471ST, 481, 601, 604, and 881 hoses.

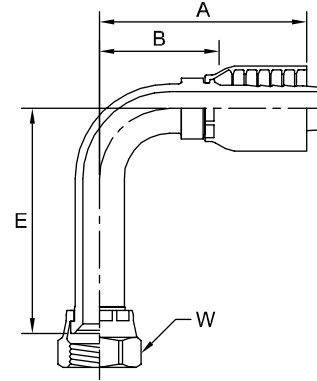
**14143 Female JIC 37° - Swivel  
90° Elbow - Long Drop**



~ These 14143 fittings contain a dual seat that accepts both the JIC (37°) and SAE (45°) male configurations. The other sizes accept the JIC (37°) male configurations only.  
Note: "C" - Stainless Steel Fitting. Must be crimped with Karrykrimp 2, PHastkrimp, Superkrimp, or Parkrimp 2.

# Part Number	 Thread			 Hose		A		E		W	B	
	inch			inch		inch	mm	inch	mm	inch	inch	mm
14143-4-4~	1/4	7/16x20	-4	1/4	-4	1.96	50	1.81	46	9/16	1.21	31
14143-5-4~	5/16	1/2x20	-5	1/4	-4	1.93	49	1.80	46	5/8	1.18	30
14143-6-4+	3/8	9/16x18	-6	1/4	-4	2.12	54	2.18	55	11/16	1.37	35
14143-6-6	3/8	9/16x18	-6	3/8	-6	2.27	58	2.18	55	11/16	1.27	32
14143-6-8+	3/8	9/16x18	-6	1/2	-8	2.50	64	2.13	54	11/16	1.24	31
14143-8-6~	1/2	3/4x16	-8	3/8	-6	2.56	65	2.43	62	7/8	1.56	40
14143-8-8~	1/2	3/4x16	-8	1/2	-8	2.72	69	2.43	62	7/8	1.47	37
14143-8-8C~+	1/2	3/4x16	-8	1/2	-8	2.67	68	2.43	62	7/8	1.41	36
14143-10-8~	5/8	7/8x14	-10	1/2	-8	2.78	71	2.76	70	1	1.52	39
14143-10-10~	5/8	7/8x14	-10	5/8	-10	3.16	80	2.58	66	1	1.75	44
14143-12-10+	3/4	1-1/16x12	-12	5/8	-10	3.38	86	3.74	95	1-1/4	1.93	49
14143-12-12	3/4	1-1/16x12	-12	3/4	-12	3.38	86	3.74	95	1-1/4	1.95	50
14143-12-12C+	3/4	1-1/16x12	-12	3/4	-12	3.38	86	3.74	95	1-1/4	1.95	50
14143-14-12	7/8	1-3/16x12	-14	3/4	-12	3.38	86	3.93	100	1-3/8	1.95	50
14143-16-12+	1	1-5/16x12	-16	3/4	-12	3.36	85	3.92	100	1-1/2	1.94	49
14143-16-16	1	1-5/16x12	-16	1	-16	3.90	99	4.32	110	1-1/2	2.31	59
14143-16-16C+	1	1-5/16x12	-16	1	-16	3.90	99	4.32	110	1-1/2	2.30	58
14143-20-20	1-1/4	1-5/8x12	-20	1-1/4	-20	4.39	112	5.28	134	2	2.73	69
14143-20-20C+	1-1/4	1-5/8x12	-20	1-1/4	-20	4.81	122	5.24	133	2	3.12	79
14143-32-32+	2	2-1/2x12	-32	2	-32	6.75	171	8.74	222	2-7/8	4.97	126

B Fittings 43 Series

+ Non-standard

### 43 Series Fittings

JIC / SAE

Use with 301, 301LT, 304, 341, 381, 421, 421HT, 421WC, 424, 431, 436, 451TC, 471, 471ST, 481, 601, 604, and 881 hoses.

### 14V43 Female JIC 37° - Swivel 150° Elbow

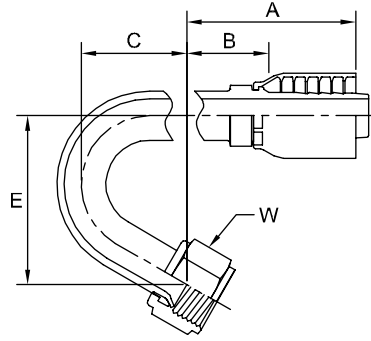

~ These 14V43 fittings contain a dual seat that accepts both the JIC (37°) and SAE (45°) male configurations. The other sizes accept the JIC (37°) male configurations only.

# Part Number	Thread			Hose		A		E		C	W	B	
	inch	inch	inch	inch	inch	inch	mm	inch	mm	inch	inch	inch	mm
14V43-4-4~+	1/4	7/16X20	-4	1/4	-4	2.65	67	1.37	35	0.68	9/16	1.92	49
14V43-6-4	3/8	9/16x18	-6	1/4	-4	2.89	73	1.97	50	1.36	11/16	2.16	55

### 10443 Male SAE 45° - Rigid Straight

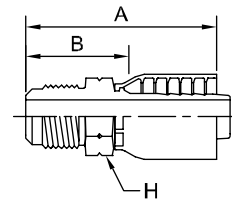

# Part Number	Thread			Hose		A		H	B	
	inch	inch	inch	inch	inch	inch	mm	inch	inch	mm
10443-6-6	3/8	5/8x18	-6	3/8	-6	2.21	56	3/4	1.21	31
10443-8-8+	1/2	3/4x16	-8	1/2	-8	2.72	69	3/4	1.46	37
10443-12-12	3/4	1-1/16x14	-12	3/4	-12	3.20	81	1-1/8	1.77	45

### 10843 Female SAE 45° - Swivel Straight

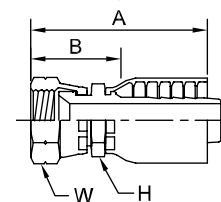

Note: Notch in nut for SAE 45° flare. See 10643 for additional sizes.

# Part Number	Thread			Hose		A		H	W	B	
	inch	inch	inch	inch	inch	inch	mm	inch	inch	inch	mm
10843-6-4	3/8	5/8x18	-6	1/4	-4	1.68	43	3/4	3/4	0.93	24
10843-6-6	3/8	5/8x18	-6	3/8	-6	2.40	61	3/4	3/4	1.40	36
10843-6-8+	3/8	5/8x18	-6	1/2	-8	2.66	68	3/4	3/4	1.40	36
10843-12-8+	3/4	1-1/16x14	-12	1/2	-8	2.77	70	1-1/16	1-1/4	1.52	39
10843-12-12	3/4	1-1/16x14	-12	3/4	-12	2.96	75	1-1/16	1-1/4	1.53	39

+ Non-standard

**43 Series Fittings**

Use with 301, 301LT, 304, 341, 381, 421, 421HT, 421WC, 424, 431, 436, 451TC, 471, 471ST, 481, 601, 604, and 881 hoses.

### 17743 Female SAE 45° - Swivel 45° Elbow

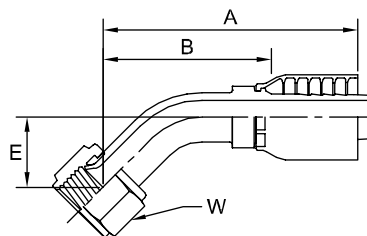

Note: Notch in nut for SAE 45° flare.

# Part Number	Thread			Hose		A		E		W	B	
	inch			inch		inch	mm	inch	mm	inch	inch	mm
17743-4-6	1/4	7/16x20	-4	3/8	-6	2.02	51	0.33	8	9/16	1.02	26

### 17943 Female SAE 45° - Swivel 90° Elbow

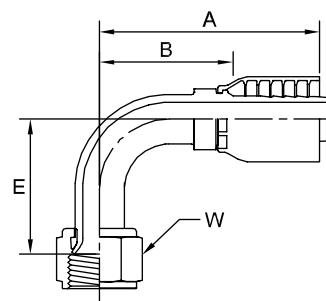

Note: Notch in nut for SAE 45° flare.

# Part Number	Thread			Hose		A		E		W	B	
	inch			inch		inch	mm	inch	mm	inch	inch	mm
17943-6-6	3/8	5/8x18	-6	3/8	-6	2.13	54	0.85	22	3/4	1.13	29
17943-8-8+	1/2	3/4x16	-8	1/2	-8	2.63	67	1.09	28	7/8	1.37	35

+ Non-standard



### 43 Series Fittings

Ferulok / Grease

Use with 301, 301LT, 304, 341, 381, 421, 421HT, 421WC, 424, 431, 436, 451TC, 471, 471ST, 481, 601, 604, and 881 hoses.

## 11143 Male Ferulok Flareless - Rigid Straight (24° Cone with Nut and Ferrule)

Note: "C" - Stainless Steel Fitting. Must be crimped with Karrykrimp 2, PHastkrimp, Superkrimp, or Parkrimp 2.

Note: The Parker Ferrule-Fix fitting makes it possible to salvage the bent tube section from a hose assembly for quick, easy on-the-job repairs. For additional information see Ferrule-Fix installation instructions in Section G.

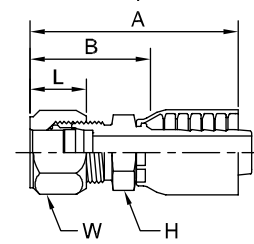

# Part Number	Thread			Hose		A		L		H	W	B	
	inch			inch		inch	mm	inch	mm	inch	inch	inch	mm
11143-4-4	1/4	7/16x20	-4	1/4	-4	2.13	54	0.64	16	9/16	9/16	1.40	36
11143-4-6	1/4	7/16x20	-4	3/8	-6	2.44	62	0.64	16	3/4	9/16	1.44	37
11143-5-4	5/16	1/2x20	-5	1/4	-4	2.13	54	0.67	17	9/16	5/8	1.40	36
11143-5-5+	5/16	1/2x20	-5	5/16	-5	2.25	57	0.67	17	9/16	5/8	1.44	37
11143-5-6	5/16	1/2x20	-5	3/8	-6	2.44	62	0.67	17	3/4	5/8	1.44	37
11143-6-5+	3/8	9/16x18	-6	5/16	-5	1.89	48	0.74	19	3/4	11/16	1.14	29
11143-6-6	3/8	9/16x18	-6	3/8	-6	2.50	64	0.74	19	3/4	11/16	1.50	38
11143-8-8	1/2	3/4x16	-8	1/2	-8	2.93	74	0.85	22	7/8	7/8	1.68	43
11143-8-8C+	1/2	3/4x16	-8	1/2	-8	2.93	74	0.85	22	7/8	7/8	1.68	43
11143-10-8	5/8	7/8x14	-10	1/2	-8	3.07	78	0.90	23	15/16	1	1.82	46
11143-10-10+	5/8	7/8x14	-10	5/8	-10	3.17	81	0.90	23	15/16	1	1.76	45
11143-12-12	3/4	1-1/16x12	-12	3/4	-12	3.39	86	0.98	25	1-1/8	1-1/4	1.96	50
11143-12-12C+	3/4	1-1/16x12	-12	3/4	-12	3.39	86	0.98	25	1-1/8	1-1/4	1.96	50
11143-16-16	1	1-5/16x12	-16	1	-16	3.80	97	1.09	28	1-3/8	1-1/2	2.18	55

## 1GJ43 Female Grease Connection Special PTF Taper Thread - Rigid Straight

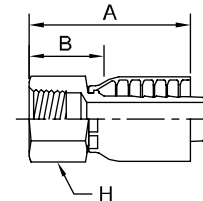

# Part Number	Thread		Hose		A		H	B	
	inch		inch		inch	mm	inch	inch	mm
1GJ43-4-4	1/2x27	-4	1/4	-4	1.79	45	3/4	1.04	26
1GJ43-4-6	1/2x27	-4	3/8	-6	2.05	52	3/4	1.02	26

+ Non-standard

### 43 Series Fittings

Ferulok / Inverted SAE

Use with 301, 301LT, 304, 341, 381, 421, 421HT, 421WC, 424, 431, 436, 451TC, 471, 471ST, 481, 601, 604, and 881 hoses.

### 11243 Female Ferulok Flareless - Swivel Straight (24° Cone)

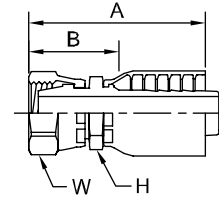

# Part Number	Thread			Hose		A		H	W	B	
	inch	inch	inch	inch	inch	inch	mm	inch	inch	inch	mm
11243-6-6	3/8	9/16x18	-6	3/8	-6	2.29	58	11/16	11/16	1.29	33
11243-8-6	1/2	3/4x16	-8	3/8	-6	2.40	61	7/8	7/8	1.40	36
11243-8-8	1/2	3/4x16	-8	1/2	-8	2.64	67	7/8	7/8	1.39	35
11243-16-16+	1	1-5/16x12	-16	1	-16	3.60	91	1-3/8	1-1/2	1.98	50
11243-20-20+	1-1/4	1-5/8x12	-20	1-1/4	-20	3.86	98	1-7/8	2	2.21	56
11243-24-24+	1-1/2	1-7/8x12	-24	1-1/2	-24	3.84	98	1-7/8	2-1/4	2.47	63

### 12843 Male Inverted SAE 45° - Swivel Straight

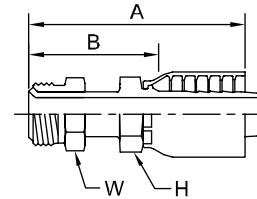

# Part Number	Thread			Hose		A		H	W	B	
	inch	inch	inch	inch	inch	inch	mm	inch	inch	inch	mm
12843-3-4+	3/16	3/8x24	-3	1/4	-4	2.35	60	9/16	3/8	1.60	41
12843-4-4	1/4	7/16x24	-4	1/4	-4	2.33	59	9/16	7/16	1.58	40
12843-4-6	1/4	7/16x24	-4	3/8	-6	2.62	67	11/16	7/16	1.62	41
12843-5-4	5/16	1/2x20	-5	1/4	-4	2.61	66	9/16	1/2	1.86	47
12843-5-6	5/16	1/2x20	-5	3/8	-6	2.72	69	11/16	1/2	1.72	44
12843-6-4+	3/8	5/8x18	-6	1/4	-4	2.73	69	9/16	5/8	1.98	50
12843-6-6	3/8	5/8x18	-6	3/8	-6	2.85	72	11/16	5/8	1.83	46
12843-6-8+	3/8	5/8x18	-6	1/2	-8	3.10	79	13/16	5/8	1.88	48
12843-7-6	7/16	11/16x18	-7	3/8	-6	2.94	75	11/16	11/16	1.94	49
12843-8-8	1/2	3/4x18	-8	1/2	-8	3.10	79	13/16	3/4	1.85	47
12843-10-8+	5/8	7/8x18	-10	1/2	-8	3.34	85	13/16	3/4	2.09	53
12843-10-10	5/8	7/8x18	-10	5/8	-10	3.54	90	3/4	7/8	2.13	54

+ Non-standard

### 43 Series Fittings

Inverted SAE

Use with 301, 301LT, 304, 341, 381, 421, 421HT, 421WC, 424, 431, 436, 451TC, 471, 471ST, 481, 601, 604, and 881 hoses.

### 16743 Male Inverted SAE 45° - Swivel 45° Elbow

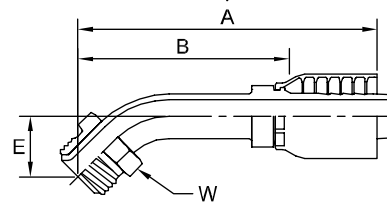

# Part Number	Thread			Hose		A		E		W	B	
	inch			inch		inch	mm	inch	mm	inch	inch	mm
	inch			inch								
16743-4-4	1/4	7/16x24	-4	1/4	-4	2.10	53	0.63	16	7/16	1.35	34
16743-4-6	1/4	7/16x24	-4	3/8	-6	2.44	62	0.62	16	7/16	1.39	35
16743-5-4	5/16	1/2x20	-5	1/4	-4	2.35	60	0.70	18	1/2	1.60	41
16743-5-6	5/16	1/2x20	-5	3/8	-6	2.39	61	0.70	18	1/2	1.38	35
16743-6-4+	3/8	5/8x18	-6	1/4	-4	2.80	70	0.94	24	5/8	2.05	52
16743-6-6	3/8	5/8x18	-6	3/8	-6	2.90	74	0.94	24	5/8	1.90	48
16743-7-6+	7/16	11/16x18	-7	3/8	-6	3.01	76	1.02	26	11/16	1.98	50
16743-8-8	1/2	3/4x18	-8	1/2	-8	3.22	82	1.09	28	3/4	1.97	50

### 16943 Male Inverted SAE 45° - Swivel 90° Elbow

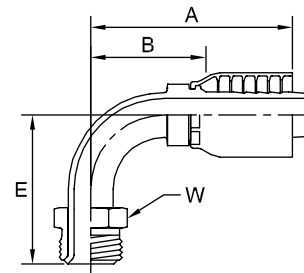

# Part Number	Thread			Hose		A		E		W	B	
	inch			inch		inch	mm	inch	mm	inch	inch	mm
	inch			inch								
16943-3-4+	3/16	3/8x24	-3	1/4	-4	1.96	50	1.20	30	3/8	1.21	31
16943-4-4	1/4	7/16x24	-4	1/4	-4	2.17	55	1.56	40	7/16	1.42	36
16943-4-6	1/4	7/16x24	-4	3/8	-6	2.49	63	1.56	40	7/16	1.49	38
16943-5-4	5/16	1/2x20	-5	1/4	-4	2.42	61	1.62	41	1/2	1.67	42
16943-5-6	5/16	1/2x20	-5	3/8	-6	2.59	66	1.65	42	1/2	1.55	39
16943-6-6	3/8	5/8x18	-6	3/8	-6	2.59	66	1.69	43	5/8	1.59	40
16943-6-8+	3/8	5/8x18	-6	1/2	-8	2.81	71	1.69	43	5/8	1.59	40
16943-7-6	7/16	11/16x18	-7	3/8	-6	2.52	64	1.72	44	11/16	1.52	39
16943-8-8	1/2	3/4x18	-8	1/2	-8	2.83	72	1.88	48	3/4	1.48	38
16943-12-12+	3/4	1-1/16x16	-12	3/4	-12	3.60	91	2.51	64	1-1/16	2.16	55

+ Non-standard

### 43 Series Fittings

Hydra-Clip / Flange Head

Use with 301, 301LT, 304, 341, 381, 421, 421HT, 421WC, 424, 431, 436, 451TC, 471, 471ST, 481, 601, 604, and 881 hoses.

## 1S043 Male Hydra-Clip - Rigid Straight

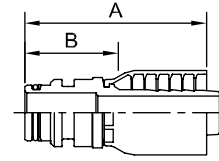

Note: O-Ring not compatible with Phosphate Ester Fluids.

# Part Number	Thread		Hose		A		B	
	inch		inch		inch	mm	inch	mm
1S043-4-4	1/4	-4	1/4	-4	2.33	59	1.58	39
1S043-6-6	3/8	-6	3/8	-6	2.55	65	1.55	39
1S043-8-8	1/2	-8	1/2	-8	2.80	71	1.55	39
1S043-12-12	3/4	-12	3/4	-12	2.98	76	1.55	39
1S043-16-16	1	-16	1	-16	3.52	89	1.93	49
1S043-20-20+	1-1/4	-20	1-1/4	-20	3.63	92	1.98	50

## 11543 SAE Code 61 Flange Head - Straight ISO 12151-3 - S - L

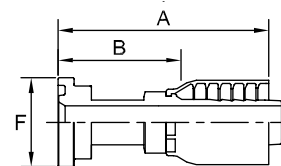

^ Must use Parkrimp 2 or Superkrimp and Die Part No. 83C-A20H.

Note: Flange kits and O-Rings listed in Section F.

# Part Number	Flange		Hose		A		F	B	
	inch		inch		inch	mm	inch	inch	mm
11543-8-6+	1/2	-8	3/8	-6	2.13	54	1-3/16	1.10	28
11543-8-8	1/2	-8	1/2	-8	3.48	88	1-3/16	2.22	56
11543-8-8C+	1/2	-8	1/2	-8	3.48	88	1-3/16	2.22	56
11543-10-8+	5/8	-10	1/2	-8	4.45	113	1-11/32	3.20	81
11543-10-10	5/8	-10	5/8	-10	4.66	118	1-11/32	3.22	82
11543-12-8	3/4	-12	1/2	-8	3.41	87	1-1/2	2.16	55
11543-12-10+	3/4	-12	5/8	-10	2.73	69	1-1/2	1.29	33
11543-12-12	3/4	-12	3/4	-12	3.56	90	1-1/2	2.13	54
11543-12-12C+	3/4	-12	3/4	-12	3.86	98	1-1/2	2.42	61
11543-16-12	1	-16	3/4	-12	2.74	70	1-3/4	1.60	41
11543-16-12C+	1	-16	3/4	-12	2.74	70	1-3/4	1.60	41
11543-16-16	1	-16	1	-16	3.87	98	1-3/4	2.28	58
11543-16-16C+	1	-16	1	-16	4.25	108	1-3/4	2.63	67
11543-16-24+	1	-16	1-1/2	-24	4.42	112	1-3/4	3.05	77
11543-20-16	1-1/4	-20	1	-16	3.19	81	2	1.57	40
11543-20-20	1-1/4	-20	1-1/4	-20	4.70	119	2	3.01	76
11543-20-20C+	1-1/4	-20	1-1/4	-20	4.79	122	2	3.10	79
11543-20-24+	1-1/4	-20	1-1/2	-24	4.38	111	2	3.05	77
11543-24-16C+	1-1/2	-24	1	-16	4.35	110	2-3/8	2.75	70
11543-24-20^	1-1/2	-24	1-1/4	-20	4.76	121	2-3/8	3.11	79
11543-24-24	1-1/2	-24	1-1/2	-24	4.58	116	2-3/8	3.21	82
11543-24-32	1-1/2	-24	2	-32	5.07	129	2-3/8	3.29	84
11543-32-20^	2	-32	1-1/4	-20	4.75	121	2-13/16	3.10	79
11543-32-24	2	-32	1-1/2	-24	3.13	80	2-13/16	1.76	45
11543-32-32	2	-32	2	-32	4.99	127	2-13/16	3.21	82
11543-40-32+	2-1/2	-40	2	-32	3.83	97	3-5/16	2.05	52

+ Non-standard

### 43 Series Fittings

Flange Head

Use with 301, 301LT, 304, 341, 381, 421, 421HT, 421WC, 424, 431, 436, 451TC, 471, 471ST, 481, 601, 604, and 881 hoses.

### 11643 SAE Code 61 Flange Head - 22½° Elbow ISO 12151-3 - E22M - L

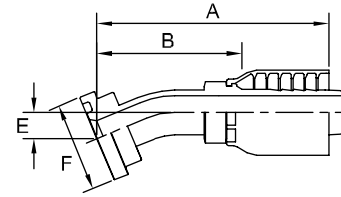

^ Must use Parkrimp 2 or Superkrimp and Die Part No. 83C-A20H.  
Note: Flange kits and O-Rings listed in Section F.

# Part Number	Flange		Hose		A		E		F	B	
	inch		inch		inch	mm	inch	mm	inch	inch	mm
11643-8-8+	1/2	-8	1/2	-8	3.25	83	0.35	9	1-3/16	2.00	51
11643-12-12	3/4	-12	3/4	-12	3.90	99	0.44	11	1-1/2	2.47	63
11643-16-12	1	-16	3/4	-12	3.89	99	0.44	11	1-3/4	2.46	62
11643-16-16	1	-16	1	-16	4.25	108	0.44	11	1-3/4	2.66	68
11643-20-16	1-1/4	-20	1	-16	4.25	108	0.44	11	2	2.66	68
11643-20-20	1-1/4	-20	1-1/4	-20	4.65	118	0.50	13	2	3.00	76
11643-24-20^	1-1/2	-24	1-1/4	-20	4.66	118	0.51	13	2-3/8	3.01	76

### 12643 SAE Code 61 Flange Head - 30° Elbow ISO 12151-3 - E30S - L (1 Piece: ISO 12151-3 - E30M - L)

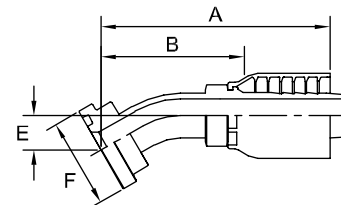

Note: Flange kits and O-Rings listed in Section F.

# Part Number	Flange		Hose		A		E		F	B	
	inch		inch		inch	mm	inch	mm	inch	inch	mm
12643-12-12	3/4	-12	3/4	-12	3.85	98	0.58	15	1-1/2	2.42	61
12643-16-16	1	-16	1	-16	4.36	111	0.62	16	1-3/4	2.77	70
12643-20-16	1-1/4	-20	1	-16	4.36	111	0.62	16	2	2.77	70
12643-20-20	1-1/4	-20	1-1/4	-20	4.39	112	0.72	18	2	2.69	68

+ Non-standard

### 43 Series Fittings

Flange Head

Use with 301, 301LT, 304, 341, 381, 421, 421HT, 421WC, 424, 431, 436, 451TC, 471, 471ST, 481, 601, 604, and 881 hoses.

### 11743 SAE Code 61 Flange Head - 45° Elbow

ISO 12151-3 - E45S - L

(1 Piece: ISO: 12151-3 - E45M - L)

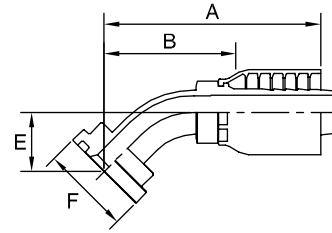

^ Must use Parkrimp 2 or Superkrimp and Die Part No. 83C-A20H.

Note: Flange kits and O-Rings listed in Section F.

# Part Number	Flange		Hose		A		E		F		B	
	inch		inch		inch	mm	inch	mm	inch	inch	mm	
11743-8-6+	1/2	-8	3/8	-6	3.14	80	0.77	20	1-3/16	2.26	57	
11743-8-8	1/2	-8	1/2	-8	3.31	84	0.78	20	1-3/16	2.05	52	
11743-10-8+	5/8	-10	1/2	-8	3.24	82	0.75	19	1-11/32	1.98	50	
11743-10-10	5/8	-10	5/8	-10	4.63	118	0.94	24	1-11/32	3.19	81	
11743-12-8	3/4	-12	1/2	-8	3.33	85	0.84	21	1-1/2	2.08	53	
11743-12-12	3/4	-12	3/4	-12	3.64	92	1.00	25	1-1/2	2.21	56	
11743-16-12	1	-16	3/4	-12	4.12	105	1.00	25	1-3/4	2.60	66	
11743-16-16	1	-16	1	-16	4.10	104	1.06	27	1-3/4	2.51	64	
11743-20-12+	1-1/4	-20	3/4	-12	3.62	92	0.98	25	2	2.18	55	
11743-20-16	1-1/4	-20	1	-16	4.10	104	1.06	27	2	2.51	64	
11743-20-20	1-1/4	-20	1-1/4	-20	4.48	114	1.13	29	2	2.83	72	
11743-20-24	1-1/4	-20	1-1/2	-24	5.41	137	1.38	35	2	4.09	104	
11743-24-20^	1-1/2	-24	1-1/4	-20	5.07	129	1.20	30	2-3/8	3.37	86	
11743-24-24	1-1/2	-24	1-1/2	-24	5.46	139	1.43	36	2-3/8	4.14	105	
11743-24-32+	1-1/2	-24	2	-32	5.96	151	1.43	36	2-3/8	4.18	106	
11743-32-24	2	-32	1-1/2	-24	5.45	138	1.43	36	2-13/16	4.13	105	
11743-32-32	2	-32	2	-32	7.23	184	1.98	50	2-13/16	5.45	138	
11743-40-32+	2-1/2	-40	2	-32	7.29	185	2.03	52	3-5/16	5.51	140	

### 12743 SAE Code 61 Flange Head - 60° Elbow

ISO 12151-3 - E60S - L

(1 Piece: ISO 12151-3 - E60M - L)

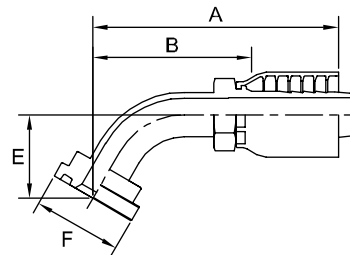

Note: Flange kits and O-Rings listed in Section F.

# Part Number	Flange		Hose		A		E		F		B	
	inch		inch		inch	mm	inch	mm	inch	inch	mm	
12743-12-12	3/4	-12	3/4	-12	4.13	105	1.41	36	1-1/2	2.70	69	
12743-16-12	1	-16	3/4	-12	4.13	105	1.39	35	1-3/4	2.70	69	
12743-16-16	1	-16	1	-16	4.67	119	1.50	38	1-3/4	2.95	75	
12743-20-20	1-1/4	-20	1-1/4	-20	5.06	129	1.69	43	2	3.41	87	
12743-24-24+	1-1/2	-24	1-1/2	-24	5.67	144	1.97	50	2-3/8	4.30	109	

+ Non-standard

### 43 Series Fittings

### Flange Head

Use with 301, 301LT, 304, 341, 381, 421, 421HT, 421WC, 424, 431, 436, 451TC, 471, 471ST, 481, 601, 604, and 881 hoses.

## 11843 SAE Code 61 Flange Head - 67½° Elbow ISO 12151-3 - E67S - L (1 Piece: ISO 12151-3 - E67M - L)

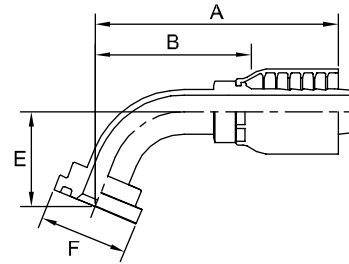

^ Must use Parkrimp 2 or Superkrimp and Die Part No. 83C-A20H.  
Note: Flange kits and O-Rings listed in Section F.

# Part Number	Flange		Hose		A		E		F		B	
	inch		inch		inch	mm	inch	mm	inch	inch	inch	mm
11843-8-8+	1/2	-8	1/2	-8	3.73	95	1.25	32	1-3/16	2.38	60	
11843-12-12	3/4	-12	3/4	-12	4.09	104	1.60	41	1-1/2	2.66	68	
11843-16-16	1	-16	1	-16	4.66	118	1.75	44	1-3/4	3.07	78	
11843-20-20	1-1/4	-20	1-1/4	-20	5.04	128	1.94	49	2	3.37	86	
11843-24-20^+	1-1/2	-24	1-1/4	-20	5.05	128	1.95	50	2-3/8	3.40	86	
11843-24-24+	1-1/2	-24	1-1/2	-24	5.56	141	2.53	64	2-3/8	4.24	108	

## 11943 SAE Code 61 Flange Head - 90° Elbow ISO 12151-3 - E90S - L (1 Piece: ISO 12151-3 - E90M - L)

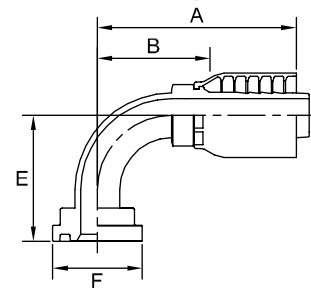

^ Must use Parkrimp 2 or Superkrimp and Die Part No. 83C-A20H.  
Note: Flange kits and O-Rings listed in Section F.

# Part Number	Flange		Hose		A		E		F		B	
	inch		inch		inch	mm	inch	mm	inch	inch	inch	mm
11943-8-6+	1/2	-8	3/8	-6	2.78	71	1.60	41	1-3/16	1.78	45	
11943-8-8	1/2	-8	1/2	-8	2.62	67	1.62	41	1-3/16	1.37	35	
11943-8-8C+	1/2	-8	1/2	-8	2.93	74	1.60	41	1-3/16	1.67	42	
11943-10-8+	5/8	-10	1/2	-8	4.30	109	1.58	40	1-11/32	3.04	77	
11943-10-10	5/8	-10	5/8	-10	3.71	94	2.10	53	1-11/32	2.27	58	
11943-12-8	3/4	-12	1/2	-8	2.69	68	1.68	43	1-1/2	1.44	37	
11943-12-10	3/4	-12	5/8	-10	3.34	85	2.12	54	1-1/2	1.93	49	
11943-12-12	3/4	-12	3/4	-12	3.34	85	2.13	54	1-1/2	1.91	49	
11943-12-12C+	3/4	-12	3/4	-12	3.34	85	2.13	54	1-1/2	1.91	49	
11943-16-8	1	-16	1/2	-8	2.91	74	2.03	52	1-3/4	1.43	36	
11943-16-12	1	-16	3/4	-12	3.34	85	2.13	54	1-3/4	1.91	49	
11943-16-16	1	-16	1	-16	3.90	99	2.38	60	1-3/4	2.31	59	
11943-16-20+	1	-16	1-1/4	-20	4.12	105	2.35	60	1-3/4	2.47	63	
11943-16-24+	1	-16	1-1/2	-24	4.18	106	2.49	63	1-3/4	2.65	67	
11943-20-16	1-1/4	-20	1	-16	3.90	99	2.38	60	2	2.31	59	
11943-20-16C+	1-1/4	-20	1	-16	4.22	107	2.38	60	2	2.60	66	
11943-20-20	1-1/4	-20	1-1/4	-20	4.38	111	2.62	67	2	2.73	69	
11943-20-24	1-1/4	-20	1-1/2	-24	4.19	106	2.62	67	2	2.83	72	
11943-24-20^	1-1/2	-24	1-1/4	-20	4.80	122	2.64	67	2-3/8	3.11	79	
11943-24-24	1-1/2	-24	1-1/2	-24	5.46	139	3.11	79	2-3/8	4.14	105	
11943-24-32+	1-1/2	-24	2	-32	5.97	152	3.11	79	2-3/8	4.19	106	
11943-32-24	2	-32	1-1/2	-24	5.44	138	3.10	79	2-13/16	4.12	105	
11943-32-32	2	-32	2	-32	6.75	171	4.47	114	2-13/16	4.97	126	
11943-40-32+	2-1/2	-40	2	-32	6.75	171	4.55	116	3-5/16	4.97	126	

+ Non-standard

## 43 Series Fittings

Seal Lok®

Use with 301, 301LT, 304, 341, 381, 421, 421HT, 421WC, 424, 431, 436, 451TC, 471, 471ST, 481, 601, 604, and 881 hoses.

### 1J043 Male Seal-Lok® - Rigid Straight (with O-Ring)

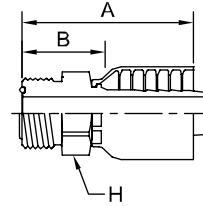

- Note: Seal-Lok® torque table in Section G.  
 Note: Seal-Lok® O-Rings are listed in Section F.  
 Note: Fittings with an "SM" suffix have a metric hex.  
**Note: Part Number 1J043 is 1JM43 boxed with Nitrile O-Ring**

# Part Number	Thread			Hose		A		H	B	
	inch			inch		inch	mm	inch	inch	mm
1J043-4-4	1/4	9/16x18	-4	1/4	-4	1.71	43	5/8	0.99	25
1J043-6-6	3/8	11/16x16	-6	3/8	-6	2.06	52	3/4	1.06	27
1J043-8-6	1/2	13/16x16	-8	3/8	-6	2.18	55	7/8	1.18	30
1J043-8-8	1/2	13/16x16	-8	1/2	-8	2.42	61	7/8	1.17	30
1J043-8-8-SM	1/2	13/16x16	-8	1/2	-8	2.42	61	22 mm	1.17	30
1J043-10-8	5/8	1x14	-10	1/2	-8	2.61	66	1-1/16	1.35	34
1J043-10-10	5/8	1x14	-10	5/8	-10	2.76	70	1-1/16	1.35	34
1J043-12-10	3/4	1-3/16x12	-12	5/8	-10	2.89	73	1-1/4	1.45	37
1J043-12-12	3/4	1-3/16x12	-12	3/4	-12	2.88	73	1-1/4	1.45	37
1J043-12-12-SM	3/4	1-3/16x12	-12	3/4	-12	2.88	73	32 mm	1.45	37
1J043-16-12	1	1-7/16x12	-16	3/4	-12	2.91	74	1-1/2	1.48	38
1J043-16-16	1	1-7/16x12	-16	1	-16	3.26	83	1-1/2	1.67	42
1J043-20-20	1-1/4	1-11/16x12	-20	1-1/4	-20	3.31	84	1-3/4	1.66	42

+ Non-standard



### 43 Series Fittings

Use with 301, 301LT, 304, 341, 381, 421, 421HT, 421WC, 424, 431, 436, 451TC, 471, 471ST, 481, 601, 604, and 881 hoses.

### 1JB43 Male Seal-Lok® Bulkhead w/o Locknut Straight (w/o O-Ring)

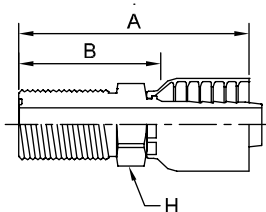

# Part Number	Thread		Hose		A		H	B		
	inch		inch		inch	mm	inch	inch	mm	
1JB43-4-4	1/4	9/16x18	-4	1/4	-4	2.58	66	5/8	1.84	47
1JB43-6-6	3/8	11/16x16	-6	3/8	-6	2.98	76	3/4	1.95	50
1JB43-8-6	1/2	13/16x16	-8	3/8	-6	3.14	80	7/8	2.11	54
1JB43-8-8	1/2	13/16x16	-8	1/2	-8	3.36	85	7/8	2.10	53
1JB43-10-8	5/8	1x14	-10	1/2	-8	3.58	91	1-1/16	2.32	59
1JB43-10-10	5/8	1x14	-10	5/8	-10	3.77	96	1-1/16	2.33	59
1JB43-12-12	3/4	1-3/16x12	-12	3/4	-12	3.87	98	1-1/4	2.43	62

Note: These fittings are stocked minus the locknut (part no. WLNL).  
Locknuts are manufactured by the Tube Fittings Division of Parker Hannifin and must be ordered separately.  
Note: Seal-Lok® torque table in Section G.  
Note: Seal-Lok® O-Rings are listed in Section F.

### WLNL Seal-Lok® Bulkhead Locknut

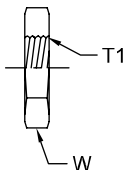

# TFD Part Number	T1 Thread		W
4 WLNL-S	1/4	9/16x18	13/16
6 WLNL-S	3/8	11/16x16	1
8 WLNL-S	1/2	13/16x16	1-1/8
10 WLNL-S	5/8	1x14	1-5/16
12 WLNL-S	3/4	1-3/16x12	1-1/2

+ Non-standard

## 43 Series Fittings



Seal Lok®

Use with 301, 301LT, 304, 341, 381, 421, 421HT, 421WC, 424, 431, 436, 451TC, 471, 471ST, 481, 601, 604, and 881 hoses.

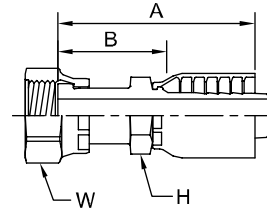
### 1JS43 Female Seal-Lok® - Swivel Straight - Long

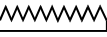

- ^ Must use Parkrimp 2 or Superkrimp and Die Part No. 83C-A20H.
- Note: Seal-Lok® torque table in Section G.
- Note: Seal-Lok® O-Rings are listed in Section F.
- Note: "C" - Stainless Steel Fitting. Must be crimped with Karrykrimp 2, PHastkrimp, Superkrimp, or Parkrimp 2.

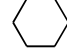
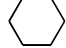
# Part Number						A						B	
	Thread			Hose		inch	mm	inch	inch	inch	inch	inch	mm
	inch			inch									
1JS43-4-4	1/4	9/16x18	-4	1/4	-4	2.08	53	9/16	11/16	1.33	34		
1JS43-4-6	1/4	9/16x18	-4	3/8	-6	2.19	56	11/16	11/16	1.18	30		
1JS43-6-4	3/8	11/16x16	-6	1/4	-4	2.15	55	9/16	13/16	1.40	36		
1JS43-6-6	3/8	11/16x16	-6	3/8	-6	2.26	57	11/16	13/16	1.26	32		
1JS43-6-8	3/8	11/16x16	-6	1/2	-8	2.50	64	13/16	13/16	1.25	32		
1JS43-8-4	1/2	13/16x16	-8	1/4	-4	2.27	58	11/16	15/16	1.52	39		
1JS43-8-6	1/2	13/16x16	-8	3/8	-6	2.51	64	11/16	15/16	1.51	38		
1JS43-8-8	1/2	13/16x16	-8	1/2	-8	2.65	67	13/16	15/16	1.40	36		
1JS43-8-10	1/2	13/16x16	-8	5/8	-10	2.90	74	15/16	15/16	1.46	37		
1JS43-8-12+	1/2	13/16x16	-8	3/4	-12	2.94	75	1-1/16	15/16	1.51	38		
1JS43-10-6	5/8	1x14	-10	3/8	-6	2.63	67	11/16	1-1/8	1.62	41		
1JS43-10-8	5/8	1x14	-10	1/2	-8	2.89	73	13/16	1-1/8	1.64	42		
1JS43-10-10	5/8	1x14	-10	5/8	-10	3.07	78	15/16	1-1/8	1.66	42		
1JS43-10-12	5/8	1x14	-10	3/4	-12	3.08	78	1-1/16	1-1/8	1.65	42		
1JS43-12-8	3/4	1-3/16x12	-12	1/2	-8	2.89	73	15/16	1-3/8	1.64	42		
1JS43-12-10	3/4	1-3/16x12	-12	5/8	-10	3.19	81	1	1-3/8	1.75	44		
1JS43-12-12	3/4	1-3/16x12	-12	3/4	-12	3.29	84	1-1/16	1-3/8	1.86	47		
1JS43-12-12C+	3/4	1-3/16x12	-12	3/4	-12	3.31	84	1-1/16	1-3/8	1.87	47		
1JS43-12-16	3/4	1-3/16x12	-12	1	-16	3.51	89	1-5/16	1-3/8	1.92	49		
1JS43-16-12	1	1-7/16x12	-16	3/4	-12	3.37	86	1-3/8	1-5/8	1.94	49		
1JS43-16-16	1	1-7/16x12	-16	1	-16	3.60	91	1-3/8	1-5/8	2.01	51		
1JS43-16-20	1	1-7/16x12	-16	1-1/4	-20	4.04	103	1-3/4	1-5/8	2.39	61		
1JS43-20-16	1-1/4	1-11/16x12	-20	1	-16	3.64	92	1-3/4	1-7/8	2.02	51		
1JS43-20-20	1-1/4	1-11/16x12	-20	1-1/4	-20	3.77	96	1-3/4	1-7/8	2.08	53		
1JS43-24-20^	1-1/2	2x12	-24	1-1/4	-20	3.88	99	1-3/4	2-1/4	2.23	57		
1JS43-24-24	1-1/2	2x12	-24	1-1/2	-24	3.63	92	2	2-1/4	2.26	57		
1JS43-24-32+	1-1/2	2x12	-24	2	-32	4.37	111	1-7/8	2-7/8	2.59	66		
1JS43-32-32+	2	2-1/2x12	-32	2	-32	4.72	120	2-1/2	2-7/8	2.94	75		

+ Non-standard

## 43 Series Fittings

Seal Lok®

Use with 301, 301LT, 304, 341, 381, 421, 421HT, 421WC, 424, 431, 436, 451TC, 471, 471ST, 481, 601, 604, and 881 hoses.

### 1JC43 Female Seal-Lok® - Swivel Straight - Short

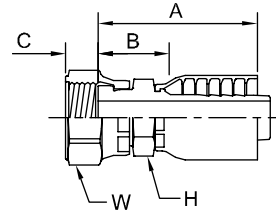

- Note: Seal-Lok® torque table in Section G.
- Note: Seal-Lok® O-Rings are listed in Section F.
- Note: Fittings with an "SM" suffix have a metric hex.
- Note: When measuring overall length to the end of the nut, B & C must be used to calculate cut-off allowance.
- Note: "C" - Stainless Steel Fitting. Must be crimped with Karrykrimp 2, PHastkrimp, Superkrimp, or Parkrimp 2.

#	Thread			Hose		A		C		H	W	B	
	MMMMMM			O						Hexagon	Hexagon		
	Part Number	inch		inch		inch	mm	inch	mm	inch	inch	inch	mm
1JC43-4-4	1/4	9/16x18	-4	1/4	-4	1.63	41	0.32	8	9/16	11/16	0.89	23
1JC43-4-4C	1/4	9/16x18	-4	1/4	-4	1.63	41	0.32	8	9/16	11/16	0.89	23
1JC43-4-4-SM	1/4	9/16x18	-4	1/4	-4	1.63	41	0.32	8	17 mm	17 mm	0.89	23
1JC43-4-6+	1/4	9/16x18	-4	3/8	-6	1.90	48	0.32	8	11/16	11/16	0.87	22
1JC43-4-6C+	1/4	9/16x18	-4	3/8	-6	1.90	48	0.32	8	11/16	11/16	0.87	22
1JC43-6-4	3/8	11/16x16	-6	1/4	-4	1.65	42	0.32	8	11/16	13/16	0.92	23
1JC43-6-4C+	3/8	11/16x16	-6	1/4	-4	1.65	42	0.32	8	11/16	13/16	0.92	23
1JC43-6-4-SM	3/8	11/16x16	-6	1/4	-4	1.68	43	0.32	8	17 mm	22 mm	0.93	24
1JC43-6-5	3/8	11/16x16	-6	5/16	-5	1.76	45	0.32	8	11/16	13/16	1.01	26
1JC43-6-6	3/8	11/16x16	-6	3/8	-6	1.94	49	0.38	10	11/16	13/16	0.91	23
1JC43-6-6C	3/8	11/16x16	-6	3/8	-6	1.94	49	0.38	10	11/16	13/16	0.91	23
1JC43-6-6-SM	3/8	11/16x16	-6	3/8	-6	1.94	49	0.38	10	19 mm	22 mm	0.91	23
1JC43-6-8C+	3/8	11/16x16	-6	1/2	-8	2.16	55	0.38	10	13/16	13/16	0.90	23
1JC43-6-8-SM	3/8	11/16x16	-6	1/2	-8	2.20	56	0.38	10	22 mm	22 mm	0.90	23
1JC43-8-6	1/2	13/16x16	-8	3/8	-6	1.98	50	0.38	10	13/16	15/16	0.98	25
1JC43-8-6C+	1/2	13/16x16	-8	3/8	-6	1.98	50	0.38	10	13/16	15/16	0.98	25
1JC43-8-6-SM	1/2	13/16x16	-8	3/8	-6	1.98	50	0.43	11	19 mm	24 mm	0.98	25
1JC43-8-8	1/2	13/16x16	-8	1/2	-8	2.22	56	0.43	11	13/16	15/16	0.96	24
1JC43-8-8C	1/2	13/16x16	-8	1/2	-8	2.22	56	0.43	11	13/16	15/16	0.96	24
1JC43-8-8-SM	1/2	13/16x16	-8	1/2	-8	2.22	56	0.43	11	22 mm	24 mm	0.96	24
1JC43-8-10+	1/2	13/16x16	-8	5/8	-10	2.36	60	0.43	11	15/16	15/16	0.95	24
1JC43-8-12+	1/2	13/16x16	-8	3/4	-12	2.40	61	0.43	11	1	15/16	0.97	25
1JC43-10-8	5/8	1x14	-10	1/2	-8	2.30	58	0.43	11	15/16	1-1/8	1.05	27
1JC43-10-8-SM	5/8	1x14	-10	1/2	-8	2.30	58	0.43	11	24 mm	30 mm	1.05	27
1JC43-10-10	5/8	1x14	-10	5/8	-10	2.50	64	0.53	13	15/16	1-1/8	1.05	27
1JC43-10-10C	5/8	1x14	-10	5/8	-10	2.50	64	0.53	13	15/16	1-1/8	1.05	27
1JC43-10-10-SM	5/8	1x14	-10	5/8	-10	2.49	63	0.53	13	24 mm	36 mm	1.05	27
1JC43-10-12+	5/8	1x14	-10	3/4	-12	2.63	67	0.53	13	1-1/8	1-1/8	1.19	30
1JC43-12-8	3/4	1-3/16x12	-12	1/2	-8	2.48	63	0.55	14	1-1/8	1-3/8	1.22	31
1JC43-12-8-SM+	3/4	1-3/16x12	-12	1/2	-8	2.48	63	0.57	14	32 mm	36 mm	1.22	31
1JC43-12-10	3/4	1-3/16x12	-12	5/8	-10	2.65	67	0.53	13	1-1/8	1-3/8	1.24	31
1JC43-12-10-SM	3/4	1-3/16x12	-12	5/8	-10	2.65	67	0.53	13	32 mm	36 mm	1.24	31
1JC43-12-12	3/4	1-3/16x12	-12	3/4	-12	2.68	68	0.57	14	1-1/8	1-3/8	1.24	31
1JC43-12-12C	3/4	1-3/16x12	-12	3/4	-12	2.68	68	0.57	14	1-1/8	1-3/8	1.24	31
1JC43-12-12-SM	3/4	1-3/16x12	-12	3/4	-12	2.68	68	0.57	14	32 mm	36 mm	1.24	31
1JC43-12-16	3/4	1-3/16x12	-12	1	-16	2.99	76	0.57	14	1-5/16	1-3/8	1.34	34
1JC43-16-12	1	1-7/16x12	-16	3/4	-12	2.81	71	0.58	15	1-3/8	1-5/8	1.38	35
1JC43-16-12-SM+	1	1-7/16x12	-16	3/4	-12	2.83	72	0.58	15	36 mm	41 mm	1.39	35
1JC43-16-16	1	1-7/16x12	-16	1	-16	3.14	80	0.58	15	1-3/8	1-5/8	1.52	39
1JC43-16-16C	1	1-7/16x12	-16	1	-16	3.14	80	0.58	15	1-3/8	1-5/8	1.52	39
1JC43-16-16-SM+	1	1-7/16x12	-16	1	-16	3.14	80	0.58	15	36 mm	41 mm	1.52	39
1JC43-20-16-SM+	1-1/4	1-1/16x12	-20	1	-16	3.08	78	0.59	15	41 mm	50 mm	1.46	37
1JC43-20-20+	1-1/4	1-11/16x12	-20	1-1/4	-20	3.23	82	0.59	15	1-7/8	1-7/8	1.58	40
1JC43-20-20C	1-1/4	1-11/16x12	-20	1-1/4	-20	3.23	82	0.59	15	1-7/8	1-7/8	1.58	40
1JC43-20-20-SM+	1-1/4	1-11/16x12	-20	1-1/4	-20	3.27	83	0.59	15	50 mm	50 mm	1.58	40
1JC43-24-24C+	1-1/2	2x12	-24	1-1/2	-24	2.94	75	0.57	14	2	2-1/4	1.61	41

+ Non-standard

## 43 Series Fittings

Seal Lok®

Use with 301, 301LT, 304, 341, 381, 421, 421HT, 421WC, 424, 431, 436, 451TC, 471, 471ST, 481, 601, 604, and 881 hoses.

### 1J643 Female Seal-Lok® - Swivel 22½° Elbow

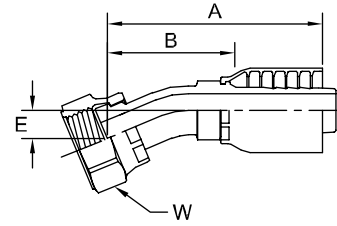

- Note: Seal-Lok® torque table in Section G.  
 Note: Seal-Lok® O-Rings are listed in Section F.  
 Note: "C" - Stainless Steel Fitting. Must be crimped with Karykrimp 2, PHastkrimp, Superkrimp, or Parkrimp 2.

# Part Number	Thread			Hose		A		E		W	B	
	inch	inch	inch	inch	inch	inch	mm	inch	mm	inch	inch	mm
1J643-8-8	1/2	13/16x16	-8	1/2	-8	3.04	77	0.39	10	15/16	1.79	45
1J643-10-10+	5/8	1x14	-10	5/8	-10	3.89	99	0.42	11	1-1/8	2.45	62
1J643-16-16C+	1	1-7/16x12	-16	1	-16	4.38	111	0.94	24	1-5/8	2.53	64

### 1J743 Female Seal-Lok® - Swivel 45° Elbow

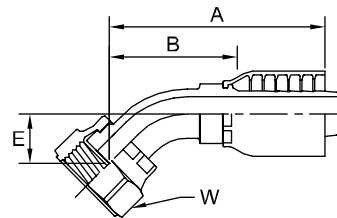

- ^ Must use Parkrimp 2 or Superkrimp and Die Part No. 83C-A20H.  
 Note: Seal-Lok® torque table in Section G.  
 Note: Seal-Lok® O-Rings are listed in Section F.  
 Note: Fittings with an "SM" suffix have metric hex.  
 Note: "C" - Stainless Steel Fitting. Must be crimped with Karykrimp 2, PHastkrimp, Superkrimp, or Parkrimp 2.

# Part Number	Thread			Hose		A		E		W	B	
	inch	inch	inch	inch	inch	inch	mm	inch	mm	inch	inch	mm
1J743-4-4	1/4	9/16x18	-4	1/4	-4	2.24	57	0.39	10	11/16	1.49	38
1J743-4-4-SM	1/4	9/16x18	-4	1/4	-4	2.24	57	0.39	10	17 mm	1.49	38
1J743-4-6	1/4	9/16x18	-4	3/8	-6	2.23	57	0.39	10	11/16	1.20	30
1J743-4-6-SM+	1/4	9/16x18	-4	3/8	-6	2.23	57	0.39	10	17mm	1.20	30
1J743-6-4	3/8	11/16x16	-6	1/4	-4	2.30	58	0.43	11	13/16	1.55	39
1J743-6-4-SM	3/8	11/16x16	-6	1/4	-4	2.30	58	0.43	11	22 mm	1.55	39
1J743-6-5	3/8	11/16x16	-6	5/16	-5	2.38	60	0.43	11	13/16	1.63	41
1J743-6-6	3/8	11/16x16	-6	3/8	-6	2.34	59	0.43	11	13/16	1.31	33
1J743-6-6-SM	3/8	11/16x16	-6	3/8	-6	2.34	59	0.43	11	22 mm	1.31	33
1J743-6-8	3/8	11/16x16	-6	1/2	-8	2.66	68	0.43	11	13/16	1.41	36
1J743-8-4	1/2	13/16x16	-8	1/4	-4	2.56	65	0.59	15	15/16	1.81	46
1J743-8-6	1/2	13/16x16	-8	3/8	-6	2.61	66	0.59	15	15/16	1.58	40
1J743-8-6-SM	1/2	13/16x16	-8	3/8	-6	2.61	66	0.59	15	24 mm	1.58	40
1J743-8-8	1/2	13/16x16	-8	1/2	-8	2.83	72	0.59	15	15/16	1.57	40
1J743-8-8-SM	1/2	13/16x16	-8	1/2	-8	2.83	72	0.59	15	24 mm	1.57	40
1J743-8-10	1/2	13/16x16	-8	5/8	-10	2.92	74	0.59	15	15/16	1.51	38
1J743-8-10-SM+	1/2	13/16x16	-8	5/8	-10	2.92	74	0.59	15	24 mm	1.51	38
1J743-10-8	5/8	1x14	-10	1/2	-8	2.93	74	0.63	16	1-1/8	1.67	42
1J743-10-8-SM+	5/8	1x14	-10	1/2	-8	2.93	74	0.63	16	30 mm	1.67	42
1J743-10-10	5/8	1x14	-10	5/8	-10	3.17	81	0.63	16	1-1/8	1.73	44
1J743-10-10-SM+	5/8	1x14	-10	5/8	-10	3.17	81	0.63	16	30 mm	1.73	44
1J743-10-12	5/8	1x14	-10	3/4	-12	3.36	85	0.65	16	1-1/8	1.93	49

Note: More sizes of this fitting are located on the following page.

+ Non-standard



## 43 Series Fittings

Seal Lok®

Use with 301, 301LT, 304, 341, 381, 421, 421HT, 421WC, 424, 431, 436, 451TC, 471, 471ST, 481, 601, 604, and 881 hoses.

### 1J743 Female Seal-Lok® - Swivel 45° Elbow

Note: More sizes of this fitting are located on the previous page.

# Part Number						A		E			B	
	Thread			Hose		inch	mm	inch	mm	inch	inch	mm
	inch			inch								
1J743-12-8	3/4	1-3/16x12	-12	1/2	-8	3.57	91	0.83	21	1-3/8	2.32	59
1J743-12-8-SM+	3/4	1-3/16x12	-12	1/2	-8	3.57	91	0.82	21	36 mm	2.31	59
1J743-12-10	3/4	1-3/16x12	-12	5/8	-10	3.62	92	0.83	21	1-3/8	2.18	55
1J743-12-12	3/4	1-3/16x12	-12	3/4	-12	3.63	92	0.83	21	1-3/8	2.19	56
1J743-12-12-SM	3/4	1-3/16x12	-12	3/4	-12	3.63	92	0.83	21	36 mm	2.19	56
1J743-12-16	3/4	1-3/16x12	-12	1	-16	4.04	103	0.83	21	1-3/8	2.45	62
1J743-12-16-SM+	3/4	1-3/16x12	-12	1	-16	4.04	103	0.81	21	36 mm	2.42	61
1J743-16-12	1	1-7/16x12	-16	3/4	-12	4.02	102	0.94	24	1-5/8	2.59	66
1J743-16-16	1	1-7/16x12	-16	1	-16	4.34	110	0.94	24	1-5/8	2.72	69
1J743-16-16C+	1	1-7/16x12	-16	1	-16	4.30	109	0.92	23	1-5/8	2.70	69
1J743-16-16-SM+	1	1-7/16x12	-16	1	-16	4.36	111	0.94	24	41 mm	2.76	70
1J743-16-20	1	1-7/16x12	-16	1-1/4	-20	4.59	117	0.94	24	1-5/8	2.94	75
1J743-20-16	1-1/4	1-11/16x12	-20	1	-16	4.52	115	1.00	25	1-7/8	2.93	74
1J743-20-20	1-1/4	1-11/16x12	-20	1-1/4	-20	4.73	120	1.00	25	1-7/8	3.08	78
1J743-20-20-SM+	1-1/4	1-11/16x12	-20	1-1/4	-20	4.72	120	1.00	25	50 mm	3.07	78
1J743-24-20^	1-1/2	2x12	-24	1-1/4	-20	4.94	125	1.07	27	2-1/4	3.29	84
1J743-24-24	1-1/2	2x12	-24	1-1/2	-24	4.66	118	1.07	27	2-1/4	3.34	85
1J743-24-24C+	1-1/2	2x12	-24	1-1/2	-24	4.70	119	1.07	27	2-1/4	3.30	84

Fittings  
43 Series  
**B**

+ Non-standard

## 43 Series Fittings

Seal Lok®

Use with 301, 301LT, 304, 341, 381, 421, 421HT, 421WC, 424, 431, 436, 451TC, 471, 471ST, 481, 601, 604, and 881 hoses.

### 1J943 Female Seal-Lok® - Swivel 90° Elbow - Short Drop

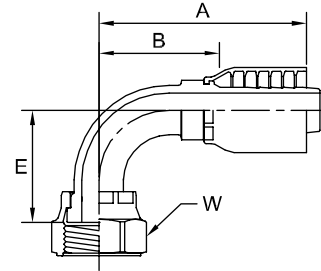

^ Must use Parkrimp 2 or Superkrimp and Die Part No. 83C-A20H.

Note: Seal-Lok® torque table in Section G.

Note: Seal-Lok® O-Rings are listed in Section F.

Note: Fittings with an "SM" suffix have metric hex.

Note: "C" - Stainless Steel Fitting. Must be crimped with Karrykrimp 2, PHastkrimp, Superkrimp, or Parkrimp 2.

# Part Number	Thread			Hose		A		E		W	B	
	inch	mm	inches	inch	mm	inch	mm	inch	mm	inch	mm	mm
1J943-4-4	1/4	9/16x18	-4	1/4	-4	2.21	56	0.83	21	11/16	1.46	37
1J943-4-4C+	1/4	9/16x18	-4	1/4	-4	1.78	45	0.80	20	11/16	1.03	26
1J943-4-4-SM+	1/4	9/16x18	-4	1/4	-4	1.78	45	0.83	21	17mm	1.03	26
1J943-4-6	1/4	9/16x18	-4	3/8	-6	2.33	59	0.82	21	11/16	1.33	34
1J943-6-4	3/8	11/16x16	-6	1/4	-4	2.18	55	0.91	23	13/16	1.43	36
1J943-6-4-SM+	3/8	11/16x16	-6	1/4	-4	2.18	55	0.91	23	22 mm	1.43	36
1J943-6-5	3/8	11/16x16	-6	5/16	-5	2.26	57	0.90	23	13/16	1.51	38
1J943-6-6	3/8	11/16x16	-6	3/8	-6	2.21	56	0.91	23	13/16	1.18	30
1J943-6-6-SM	3/8	11/16x16	-6	3/8	-6	2.21	56	0.91	23	22 mm	1.18	30
1J943-6-8	3/8	11/16x16	-6	1/2	-8	2.53	64	0.90	23	13/16	1.28	33
1J943-6-8-SM	3/8	11/16x16	-6	1/2	-8	2.53	64	0.90	23	22 mm	1.28	33
1J943-8-4	1/2	13/16x16	-8	1/4	-4	2.29	58	1.15	29	15/16	1.54	39
1J943-8-6	1/2	13/16x16	-8	3/8	-6	2.37	60	1.14	29	15/16	1.34	34
1J943-8-6-SM+	1/2	13/16x16	-8	3/8	-6	2.37	60	1.14	29	24 mm	1.34	34
1J943-8-8	1/2	13/16x16	-8	1/2	-8	2.59	66	1.14	29	15/16	1.33	34
1J943-8-8C+	1/2	13/16x16	-8	1/2	-8	2.64	67	1.19	30	15/16	1.38	35
1J943-8-8-SM	1/2	13/16x16	-8	1/2	-8	2.59	66	1.14	29	24 mm	1.33	34
1J943-8-10	1/2	13/16x16	-8	5/8	-10	2.79	71	1.15	29	15/16	1.38	35
1J943-10-8	5/8	1x14	-10	1/2	-8	2.74	70	1.26	32	1-1/8	1.48	38
1J943-10-8-SM+	5/8	1x14	-10	1/2	-8	2.74	70	1.26	32	30mm	1.48	38
1J943-10-10	5/8	1x14	-10	5/8	-10	2.97	75	1.26	32	1-1/8	1.53	39
1J943-10-10C+	5/8	1x14	-10	5/8	-10	2.97	75	1.26	32	1-1/8	1.53	39
1J943-10-10-SM	5/8	1x14	-10	5/8	-10	2.97	75	1.26	32	30 mm	1.53	39
1J943-10-12	5/8	1x14	-10	3/4	-12	3.06	78	1.27	32	1-1/8	1.63	41
1J943-10-12-SM+	5/8	1x14	-10	3/4	-12	3.06	78	1.27	32	30 mm	1.63	41
1J943-12-8	3/4	1-13/16x12	-12	1/2	-8	2.91	74	1.88	48	1-3/8	1.65	42
1J943-12-8C+	3/4	1-13/16x12	-12	1/2	-8	3.17	81	1.88	48	1-3/8	1.92	49
1J943-12-10	3/4	1-3/16x12	-12	5/8	-10	3.49	89	1.89	48	1-3/8	2.05	52
1J943-12-10-SM+	3/4	1-3/16x12	-12	5/8	-10	3.49	89	1.89	48	36mm	2.05	52
1J943-12-12	3/4	1-3/16x12	-12	3/4	-12	3.49	89	1.89	48	1-3/8	2.05	52
1J943-12-12C+	3/4	1-3/16x12	-12	3/4	-12	3.34	85	1.89	48	1-3/8	1.92	49
1J943-12-12-SM+	3/4	1-3/16x12	-12	3/4	-12	3.49	89	1.89	48	36 mm	2.05	52
1J943-12-16	3/4	1-3/16x12	-12	1	-16	3.95	100	1.88	48	1-3/8	2.36	60
1J943-12-16-SM+	3/4	1-3/16x12	-12	1	-16	3.95	100	1.85	47	36 mm	2.33	59
1J943-16-12	1	1-7/16x12	-16	3/4	-12	4.07	103	2.21	56	1-5/8	2.64	67
1J943-16-12C+	1	1-7/16x12	-16	3/4	-12	4.03	102	2.21	56	1-5/8	2.61	66
1J943-16-16	1	1-7/16x12	-16	1	-16	4.28	109	2.20	56	1-5/8	2.66	68
1J943-16-16-SM+	1	1-7/16x12	-16	1	-16	4.29	111	2.21	24	41 mm	2.69	70
1J943-16-20	1	1-7/16x12	-16	1-1/4	-20	4.54	115	2.21	56	1-5/8	2.89	73
1J943-20-16	1-1/4	1-11/16x12	-20	1	-16	4.69	119	2.51	64	1-7/8	3.10	79
1J943-20-16C+	1-1/4	1-11/16x12	-20	1	-16	4.69	119	2.51	64	1-7/8	3.10	79
1J943-20-20	1-1/4	1-11/16x12	-20	1-1/4	-20	4.85	123	2.51	64	1-7/8	3.20	81
1J943-20-20-SM+	1-1/4	1-11/16x12	-20	1-1/4	-20	4.84	123	2.51	64	50 mm	3.19	81
1J943-24-20^	1-1/2	2x12	-24	1-1/4	-20	4.97	126	2.70	69	2-1/4	3.32	84
1J943-24-24	1-1/2	2x12	-24	1-1/2	-24	5.46	139	2.70	69	2-1/4	4.14	105
1J943-24-24C+	1-1/2	2x12	-24	1-1/2	-24	5.51	140	2.70	69	2-1/4	4.11	104

+ Non-standard

## 43 Series Fittings



Seal Lok®

Use with 301, 301LT, 304, 341, 381, 421, 421HT, 421WC, 424, 431, 436, 451TC, 471, 471ST, 481, 601, 604, and 881 hoses.

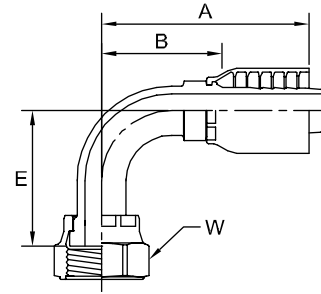
### 1J543 Female Seal-Lok® - Swivel 90° Elbow - Medium Drop



Note: Seal-Lok® torque table in Section G.  
 Note: Seal-Lok® O-Rings are listed in Section F.  
 Note: Fittings with an "SM" suffix have metric hex.

# Part Number						A		E		W	B	
	Thread			Hose		inch	mm	inch	mm	inch	inch	mm
	inch			inch								
1J543-4-4	1/4	9/16x18	-4	1/4	-4	2.26	57	1.26	32	11/16	1.51	38
1J543-6-4	3/8	11/16x16	-6	1/4	-4	2.17	55	1.50	38	13/16	1.42	36
1J543-6-4-SM+	3/8	11/16x16	-6	1/4	-4	2.13	54	1.50	38	22mm	1.38	35
1J543-6-6	3/8	11/16x16	-6	3/8	-6	2.39	61	1.50	38	13/16	1.36	35
1J543-6-6-SM	3/8	11/16x16	-6	3/8	-6	2.39	61	1.50	38	22 mm	1.36	35
1J543-8-6	1/2	13/16x16	-8	3/8	-6	2.45	62	1.61	41	15/16	1.42	36
1J543-8-6-SM+	1/2	13/16x16	-8	3/8	-6	2.45	62	1.61	41	24mm	1.42	36
1J543-8-8	1/2	13/16x16	-8	1/2	-8	2.59	66	1.61	41	15/16	1.33	34
1J543-8-8-SM	1/2	13/16x16	-8	1/2	-8	2.59	66	1.61	41	24 mm	1.33	34
1J543-10-8	5/8	1x14	-10	1/2	-8	2.74	70	1.85	47	1-1/8	1.48	38
1J543-10-10	5/8	1x14	-10	5/8	-10	2.97	75	1.85	47	1-1/8	1.53	39
1J543-10-10-SM+	5/8	1x14	-10	5/8	-10	2.97	75	1.85	47	30 mm	1.53	39
1J543-10-12	5/8	1x14	-10	3/4	-12	3.13	80	1.85	47	1-1/8	1.70	43
1J543-12-12	3/4	1-3/16x12	-12	3/4	-12	3.49	89	2.28	58	1-3/8	2.05	52
1J543-16-16	1	1-7/16x12	-16	1	-16	4.86	123	2.78	71	1-5/8	3.27	83
1J543-20-20	1-1/4	1-5/8x12	-20	1-1/4	-20	4.85	123	3.09	78	1-7/8	3.20	81

Fittings  
43 Series  
**B**

+ Non-standard

## 43 Series Fittings

Seal Lok®

Use with 301, 301LT, 304, 341, 381, 421, 421HT, 421WC, 424, 431, 436, 451TC, 471, 471ST, 481, 601, 604, and 881 hoses.

### 1J143 Female Seal-Lok® - Swivel 90° Elbow - Long Drop

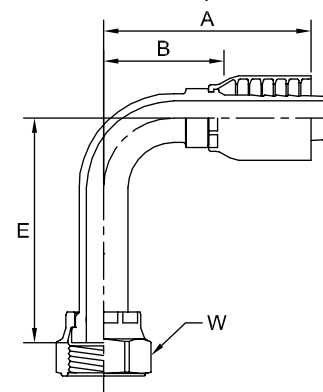

^ Must use Parkrimp 2 or Superkrimp and Die Part No. 83C-A20H.

Note: Seal-Lok® torque table in Section G.

Note: Seal-Lok® O-Rings are listed in Section F.

Note: Fittings with an "SM" suffix have metric hex.

# Part Number	Thread			Hose		A		E		W	B	
	inch			inch		inch	mm	inch	mm	inch	inch	mm
1J143-4-4	1/4	9/16x18	-4	1/4	-4	2.02	51	1.81	46	11/16	1.27	32
1J143-6-4	3/8	11/16x16	-6	1/4	-4	2.26	57	2.29	58	13/16	1.51	38
1J143-6-4-SM+	3/8	11/16x16	-6	1/4	-4	2.26	57	2.13	54	22 mm	1.51	38
1J143-6-6	3/8	11/16x16	-6	3/8	-6	2.39	61	2.13	54	13/16	1.36	35
1J143-6-6-SM	3/8	11/16x16	-6	3/8	-6	2.39	61	2.13	54	22 mm	1.36	35
1J143-8-4+	1/2	13/16x16	-8	3/8	-6	2.32	59	2.51	64	15/16	1.57	40
1J143-8-6	1/2	13/16x16	-8	3/8	-6	2.45	62	2.52	64	15/16	1.42	36
1J143-8-6-SM+	1/2	13/16x16	-8	3/8	-6	2.45	62	2.52	64	24mm	1.42	36
1J143-8-8	1/2	13/16x16	-8	1/2	-8	2.59	66	2.52	64	15/16	1.33	34
1J143-8-8-SM	1/2	13/16x16	-8	1/2	-8	2.59	66	2.52	64	24 mm	1.33	34
1J143-10-8	5/8	1x14	-10	1/2	-8	2.74	70	2.79	71	1-1/8	1.48	38
1J143-10-10	5/8	1x14	-10	5/8	-10	2.97	75	2.76	70	1-1/8	1.53	39
1J143-10-10-SM+	5/8	1x14	-10	5/8	-10	2.97	75	2.76	70	30 mm	1.53	39
1J143-10-12	5/8	1x14	-10	3/4	-12	3.15	80	2.76	70	1-1/8	1.73	44
1J143-12-12	3/4	1-3/16x12	-12	3/4	-12	3.49	89	3.78	96	1-3/8	2.05	52
1J143-12-12-SM+	3/4	1-13/16x16	-12	3/4	-12	3.49	89	3.78	96	36 mm	2.05	52
1J143-16-16	1	1-7/16x12	-16	1	-16	4.28	109	4.49	114	1-5/8	2.66	68
1J143-20-20	1-1/4	1-5/8x12	-20	1-1/4	-20	4.84	123	5.09	129	1-7/8	3.15	80
1J143-24-20^	1-1/2	2x12	-24	1-1/4	-20	4.77	121	5.54	141	2-1/4	3.12	79

+ Non-standard



### 43 Series Fittings

Metric L

Use with 301, 301LT, 304, 341, 381, 421, 421HT, 421WC, 424, 431, 436, 451TC, 471, 471ST, 481, 601, 604, and 881 hoses.

## 11D43 Male Standpipe Metric L - Rigid Straight

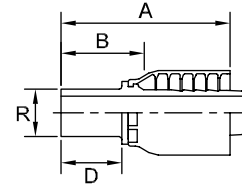

Note: Mates with EO "L" Series Fittings.

# Part Number	R		Hose		A		D		B	
	mm		inch		inch	mm	inch	mm	inch	mm
11D43-6-4	6	-6	1/4	-4	2.03	52	0.87	22	1.28	33
11D43-8-4	8	-8	1/4	-4	2.03	52	0.87	22	1.28	33
11D43-10-5	10	-10	5/16	-5	2.36	60	0.91	23	1.45	37
11D43-10-6	10	-10	3/8	-6	2.28	58	0.91	23	1.14	29
11D43-12-6	12	-12	3/8	-6	2.36	60	0.91	23	1.36	35
11D43-15-8	15	-15	1/2	-8	2.56	65	0.98	25	1.22	31
11D43-18-10	18	-18	5/8	-10	2.99	76	1.02	26	1.48	38
11D43-18-12	18	-18	3/4	-12	2.80	71	1.02	26	1.22	31
11D43-22-12	22	-22	3/4	-12	2.87	73	1.10	28	1.26	32
11D43-28-16	28	-28	1	-16	3.31	84	1.18	30	1.46	37
11D43-42-24+	42	-42	1-1/2	-24	3.50	89	1.40	36	2.18	55

## 1D043 Male Metric L - Rigid Straight (24° Cone)

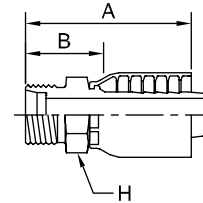

Note: Mates with EO "L" Series Fittings.

# Part Number	Thread		Hose		A		H	B		
	mm		inch		inch	mm	mm	inch	mm	
1D043-6-4	6	M12x1,5	-6	1/4	-4	1.73	44	14	0.93	24
1D043-8-4	8	M14x1,5	-8	1/4	-4	1.61	41	14	0.93	24
1D043-10-5	10	M16x1,5	-10	5/16	-5	1.97	50	19	0.83	21
1D043-10-6	10	M16x1,5	-10	3/8	-6	1.97	50	19	0.83	21
1D043-12-6	12	M18x1,5	-12	3/8	-6	1.97	50	19	0.83	21
1D043-15-8	15	M22x1,5	-15	1/2	-8	2.28	58	22	0.94	24
1D043-18-10	18	M26x1,5	-18	5/8	-10	2.68	68	27	1.14	29
1D043-18-12	18	M26x1,5	-18	3/4	-12	2.68	68	27	1.14	29
1D043-22-12	22	M30x2	-22	3/4	-12	2.72	69	30	1.22	31
1D043-28-16	28	M36x2	-28	1	-16	3.11	79	36	1.30	33

+ Non-standard

### 43 Series Fittings

Metric / Metric L

Use with 301, 301LT, 304, 341, 381, 421, 421HT, 421WC, 424, 431, 436, 451TC, 471, 471ST, 481, 601, 604, and 881 hoses.

### 1C043 Female Metric - Swivel Straight (Ball Nose)

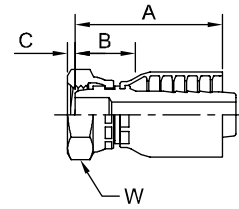

^ Must use Parkrimp 2 or Superkrimp and Die Part No. 83C-A20H.  
 Note: Mates with DIN 7631 60° Cone.  
 Note: When measuring overall length to the end of the nut, B & C must be used to calculate cut-off allowance.

# Part Number	Thread			Hose		A		C		W	B	
	mm			inch		inch	mm	inch	mm	mm	inch	mm
	1C043-20-12	20	M30x1,5	-20	3/4	-12	2.48	63	0.21	5	36	0.94
1C043-25-16	25	M38x1,5	-25	1	-16	2.99	76	0.28	7	46	1.14	29
1C043-32-20^+	32	M45x1,5	-32	1-1/4	-20	3.35	85	0.19	5	55	1.46	37

### 1C343 Female Metric L - Swivel Straight (Ball Nose)

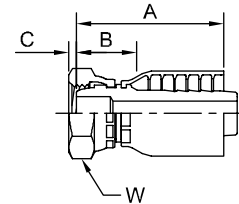

Note: When measuring overall length to the end of the nut, B & C must be used to calculate cut-off allowance.  
 Note: Mates with EO "L" Series Fittings.

# Part Number	Thread			Hose		A		C		W	B	
	mm			inch		inch	mm	inch	mm	mm	inch	mm
	1C343-6-4	6	M12x1,5	-6	1/4	-4	1.75	44	0.09	2	14	1.16
1C343-8-4	8	M14x1,5	-8	1/4	-4	1.77	45	0.11	3	17	1.16	29
1C343-10-5	10	M16x1,5	-10	5/16	-5	2.01	51	0.06	2	19	1.20	30
1C343-10-6	10	M16x1,5	-10	3/8	-6	2.06	52	0.06	2	19	1.10	28
1C343-12-5	12	M18x1,5	-12	5/16	-5	1.87	47	0.10	3	22	0.70	18
1C343-12-6	12	M18x1,5	-12	3/8	-6	2.23	57	0.10	3	22	1.18	30
1C343-15-6+	15	M22x1,5	-15	3/8	-6	2.12	54	0.17	4	27	1.18	30
1C343-15-8	15	M22x1,5	-15	1/2	-8	2.42	61	0.17	4	27	1.29	33
1C343-18-10	18	M26x1,5	-18	5/8	-10	2.65	67	0.10	3	32	1.23	31
1C343-18-12	18	M26x1,5	-18	3/4	-12	2.80	71	0.10	3	32	1.37	35
1C343-22-12	22	M30x2	-22	3/4	-12	2.87	73	0.18	5	36	1.42	36
1C343-28-16	28	M36x2	-28	1	-16	3.35	85	0.22	6	46	1.76	45

+ Non-standard

**43 Series Fittings**

Use with 301, 301LT, 304, 341, 381, 421, 421HT, 421WC, 424, 431, 436, 451TC, 471, 471ST, 481, 601, 604, and 881 hoses.

### 1C443 Female Metric L - Swivel 45° Elbow (Ball Nose)

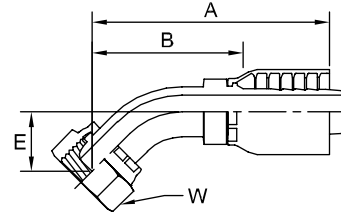

Note: Mates with EO "L" Series Fittings.

# Part Number	Thread			Hose		A		E		W	B	
	mm			inch		inch	mm	inch	mm	mm	inch	mm
1C443-8-4	8	M14x1,5	-8	1/4	-4	2.40	61	0.59	15	17	1.50	38
1C443-10-5	10	M16x1,5	-10	5/16	-5	2.60	66	0.67	17	19	1.61	41
1C443-10-6	10	M16x1,5	-10	3/8	-6	2.76	70	0.67	17	19	1.61	41
1C443-12-6	12	M18x1,5	-12	3/8	-6	2.76	70	0.67	17	22	1.61	41
1C443-15-8	15	M22x1,5	-15	1/2	-8	3.35	85	0.79	20	27	1.97	50
1C443-18-10	18	M26x1,5	-18	5/8	-10	4.09	104	1.14	29	32	2.52	64
1C443-22-12	22	M30x2	-22	3/4	-12	3.78	96	0.91	23	36	2.20	56
1C443-28-16	28	M36x2	-28	1	-16	4.53	115	1.10	28	46	2.81	71

### 1C543 Female Metric L - Swivel 90° Elbow (Ball Nose)

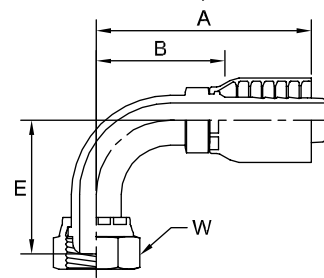

Note: Mates with EO "L" Series Fittings.

# Part Number	Thread			Hose		A		E		W	B	
	mm			inch		inch	mm	inch	mm	mm	inch	mm
1C543-6-4	6	M12x1,5	-6	1/4	-4	1.89	48	1.14	29	14	0.98	25
1C543-8-4	8	M14x1,5	-8	1/4	-4	2.05	52	1.10	28	17	1.18	30
1C543-10-5	10	M16x1,5	-10	5/16	-5	2.20	56	1.18	30	19	1.22	31
1C543-10-6	10	M16x1,5	-10	3/8	-6	2.40	61	1.18	30	19	1.40	36
1C543-12-6	12	M18x1,5	-12	3/8	-6	2.40	61	1.22	31	22	1.40	36
1C543-15-8	15	M22x1,5	-15	1/2	-8	2.95	75	1.57	40	27	1.57	40
1C543-18-10	18	M26x1,5	-18	5/8	-10	3.58	91	2.36	60	32	2.05	52
1C543-22-12	22	M30x2	-22	3/4	-12	3.58	91	1.97	50	36	2.00	51
1C543-28-16	28	M36x2	-28	1	-16	4.33	110	2.48	63	46	2.56	65

+ Non-standard

**43 Series Fittings**

Use with 301, 301LT, 304, 341, 381, 421, 421HT, 421WC, 424, 431, 436, 451TC, 471, 471ST, 481, 601, 604, and 881 hoses.

## 1CA43 Female Metric L - Swivel Straight (24° Cone with O-Ring)

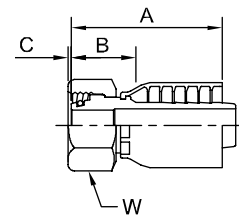

Note: When measuring overall length to the end of the nut, B & C must be used to calculate cut-off allowance.

Note: Mates with EO "L" Series Fittings.

Note: "C" - Stainless Steel Fitting. Must be crimped with Karrykrimp 2, PHastkrimp, Superkrimp, or Parkrimp 2.

# Part Number	Thread			Hose		A		C		W	B	
	mm			inch		inch	mm	inch	mm	mm	inch	mm
1CA43-6-4	6	M12x1,5	-6	1/4	-4	1.81	46	0.02	1	14	1.06	27
1CA43-8-4	8	M14x1,5	-8	1/4	-4	1.68	43	0.01	0	19	0.88	22
1CA43-10-5	10	M16x1,5	-10	5/16	-5	1.73	44	0.04	1	19	0.82	21
1CA43-12-6	12	M18x1,5	-12	3/8	-6	2.17	55	0.03	1	22	1.02	26
1CA43-15-8	15	M22x1,5	-15	1/2	-8	2.52	64	0.07	2	27	1.14	29
1CA43-18-10	18	M26X1.5	-18	5/8	-10	3.02	77	0.02	1	32	1.61	41
1CA43-18-10C+	18	M26X1.5	-18	5/8	-10	3.02	77	0.02	1	32	1.61	41
1CA43-18-12	18	M26X1.5	-18	3/4	-12	2.56	65	0.02	1	32	1.11	28
1CA43-22-12	22	M30x2	-22	3/4	-12	2.83	72	0.13	3	36	1.30	33
1CA43-28-16	28	M36x2	-28	1	-16	3.35	85	0.14	4	46	1.57	40
1CA43-35-20	35	M45x2	-35	1-1/4	-20	3.28	83	0.00	0	50	1.55	39

## 1CE43 Female Metric L - Swivel 45° Elbow (24° Cone with O-Ring)

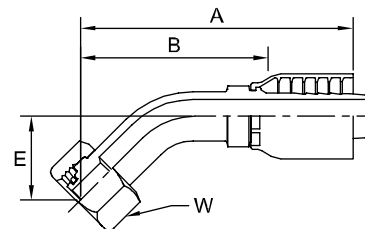

Note: Mates with EO "L" Series Fittings.

# Part Number	Thread			Hose		A		E		W	B	
	mm			inch		inch	mm	inch	mm	mm	inch	mm
1CE43-10-6	10	M16x1,5	-10	3/8	-6	3.43	87	0.73	19	19	2.44	62
1CE43-12-6	12	M18x1,5	-12	3/8	-6	2.87	73	0.87	22	22	1.73	44
1CE43-15-8	15	M22x1,5	-15	1/2	-8	3.39	86	0.87	22	27	2.00	51
1CE43-22-12	22	M30x2	-22	3/4	-12	3.82	97	0.98	25	36	2.28	58

+ Non-standard

### 43 Series Fittings

Metric L / Metric S

Use with 301, 301LT, 304, 341, 381, 421, 421HT, 421WC, 424, 431, 436, 451TC, 471, 471ST, 481, 601, 604, and 881 hoses.

## 1CF43 Female Metric L - Swivel 90° Elbow (24° Cone with O-Ring)

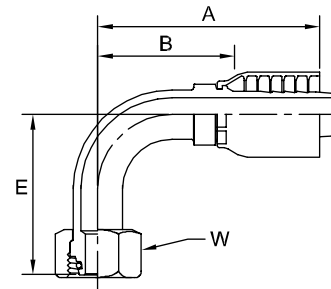

Note: Mates with EO "L" Series Fittings.

# Part Number	Thread			Hose		A		E		W	B	
	mm			inch		inch	mm	inch	mm	mm	inch	mm
	mm	M	-	inch	-							
1CF43-10-5	10	M16x1,5	-10	5/16	-5	2.30	58	1.16	29	19	1.46	37
1CF43-10-6	10	M16x1,5	-10	3/8	-6	2.56	65	1.38	35	19	1.58	40
1CF43-12-6	12	M18x1,5	-12	3/8	-6	2.40	61	1.22	31	22	1.40	36
1CF43-15-8	15	M22x1,5	-15	1/2	-8	2.95	75	1.65	42	27	1.57	40
1CF43-18-10	18	M26x1.5	-18	5/8	-10	3.17	81	1.77	45	32	1.71	43
1CF43-22-12	22	M30x2	-22	3/4	-12	3.54	90	2.09	53	36	2.00	51
1CF43-35-20	35	M45x2	-35	1-1/4	-20	4.72	120	3.11	79	50	2.87	73

## 13D43 Male Standpipe Metric S - Rigid Straight

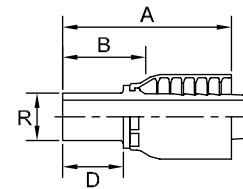

^^ Light Series 11D43-6-4, 11D43-8-4 AND 11D43-12-6 are used in place of their Heavy Series equivalent size and accept the EO Heavy "S" Series ferrules and nuts.

Note: "C" - Stainless Steel Fitting. Must be crimped with Karrykrimp 2, PHastkrimp, Superkrimp, or Parkrimp 2.

# Part Number	R		Hose		A		D		B	
	mm		inch		inch	mm	inch	mm	inch	mm
	mm	-	inch	-						
11D43-6-4^^	6	-6	1/4	-4	2.03	52	0.87	22	1.28	33
11D43-8-4^^	8	-8	1/4	-4	2.03	52	0.87	22	1.28	33
13D43-10-4	10	-10	1/4	-4	2.13	54	1.02	26	1.26	32
13D43-10-4C+	10	-10	1/4	-4	2.19	56	1.02	26	1.44	37
13D43-12-5	12	-12	5/16	-5	2.52	64	1.02	26	1.61	41
11D43-12-6^^	12	-12	3/8	-6	2.36	60	0.91	23	1.36	35
13D43-12-8C+	12	-12	1/2	-8	2.71	69	1.02	26	1.45	37
13D43-14-6	14	-14	3/8	-6	2.52	64	1.14	29	1.38	35
13D43-16-8	16	-16	1/2	-8	2.68	68	1.18	30	1.42	36
13D43-20-10	20	-20	5/8	-10	3.39	86	1.42	36	1.88	48
13D43-20-12	20	-20	3/4	-12	3.19	81	1.42	36	1.57	40
13D43-20-12C+	20	-20	3/4	-12	3.19	81	1.42	36	1.77	45
13D43-25-12	25	-25	3/4	-12	3.35	85	1.57	40	1.73	44
13D43-30-16	30	-30	1	-16	3.82	97	1.73	44	2.01	51
13D43-38-24+	38	-38	1-1/2	-24	4.05	103	1.97	50	2.42	61

+ Non-standard

## 43 Series Fittings

Metric S

Use with 301, 301LT, 304, 341, 381, 421, 421HT, 421WC, 424, 431, 436, 451TC, 471, 471ST, 481, 601, 604, and 881 hoses.

### 1D243 Male Metric S - Rigid Straight (24° Cone)

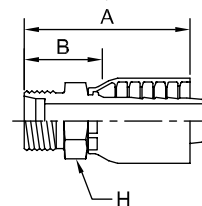

Note: Mates with EO "S" Series Fittings.

# Part Number	Thread			Hose		A		H	B	
	mm			inch		inch	mm	mm	inch	mm
1D243-8-4	8	M16x1,5	-8	1/4	-4	1.73	44	17	0.87	22
1D243-10-4	10	M18x1,5	-10	1/4	-4	1.73	44	19	0.87	22
1D243-12-5	12	M20x1,5	-12	5/16	-5	2.20	56	22	1.29	33
1D243-12-6	12	M20x1,5	-12	3/8	-6	2.09	53	22	0.94	24
1D243-14-6	14	M22x1,5	-14	3/8	-6	2.17	55	22	0.98	25
1D243-16-8	16	M24x1,5	-16	1/2	-8	2.36	60	24	1.17	30
1D243-20-10	20	M30x2	-20	5/8	-10	2.95	75	30	1.44	37
1D243-25-12	25	M36x2	-25	3/4	-12	2.87	73	36	1.30	33
1D243-30-16	30	M42x2	-30	1	-16	3.39	86	46	1.54	39

### 1C643 Female Metric S - Swivel Straight (Ball Nose)

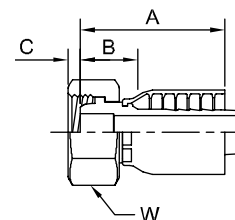

Note: When measuring overall length to the end of the nut, B & C must be used to calculate cut-off allowance.

Note: Mates with EO "S" Series Fittings.

Note: Fittings with an "SA" suffix have an inch hex.

Note: "C" - Stainless Steel Fitting. Must be crimped with Karrykrimp 2, PHastkrimp, Superkrimp, or Parkrimp 2.

# Part Number	Thread			Hose		A		C		W	B	
	mm			inch		inch	mm	inch	mm	mm	inch	mm
1C643-8-4	8	M16x1,5	-8	1/4	-4	1.57	40	0.15	4	19	1.20	30
1C643-10-4	10	M18x1,5	-10	1/4	-4	1.63	41	0.10	3	22	1.20	30
1C643-12-5	12	M20x1,5	-12	5/16	-5	1.87	47	0.08	2	24	1.20	30
1C643-12-6	12	M20x1,5	-12	3/8	-6	1.76	45	0.08	2	24	1.32	34
1C643-12-8	12	M20x1,5	12	1/2	-8	2.18	55	0.08	2	24	1.30	33
1C643-14-6	14	M22x1,5	-14	3/8	-6	1.94	49	0.17	4	27	1.32	34
1C643-16-8	16	M24x1,5	-16	1/2	-8	2.13	54	0.19	5	30	1.39	35
1C643-16-8C-SA+	16	M24x1,5	-16	1/2	-8	2.21	56	0.19	5	1-1/4	0.95	24
1C643-20-10	20	M30x2	-20	5/8	-10	2.38	60	0.21	5	36	1.39	35
1C643-20-12	20	M30x2	-20	3/4	-12	2.46	62	0.21	5	40	1.47	37
1C643-25-12	25	M36x2	-25	3/4	-12	2.48	63	0.28	7	46	1.56	40
1C643-25-12C-SA+	25	M36x2	-25	3/4	-12	2.47	63	0.28	7	1-7/8	1.03	26
1C643-30-16	30	M42x2	-30	1	-16	2.89	73	0.37	9	50	1.95	50
1C643-30-16C-SA+	30	M42x2	-30	1	-16	2.87	73	0.37	9	2	1.25	32

+ Non-standard

### 43 Series Fittings

Metric S

Use with 301, 301LT, 304, 341, 381, 421, 421HT, 421WC, 424, 431, 436, 451TC, 471, 471ST, 481, 601, 604, and 881 hoses.

### 1C943 Female Metric S - Swivel Straight (24° Cone with O-Ring)

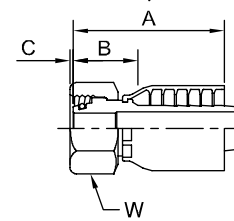

Note: When measuring overall length to the end of the nut, B & C must be used to calculate cut-off allowance.

Note: Mates with EO "S" Series Fittings.

# Part Number	Thread			Hose		A		C		W	B	
	mm			inch		inch	mm	inch	mm	mm	inch	mm
1C943-8-4	8	M16x1,5	-8	1/4	-4	1.64	42	0.01	0	19	1.18	30
1C943-10-4	10	M18x1,5	-10	1/4	-4	1.64	42	0.01	0	22	1.18	30
1C943-10-6	10	M18x1,5	-10	3/8	-6	1.97	50	0.01	0	22	0.83	21
1C943-12-5	12	M20x1,5	-12	5/16	-5	1.80	46	0.03	1	24	0.99	25
1C943-12-6	12	M20x1,5	-12	3/8	-6	1.99	51	0.03	1	24	1.04	26
1C943-14-6	14	M22x1,5	-14	3/8	-6	2.05	52	0.03	1	27	1.17	30
1C943-16-8	16	M24x1,5	-16	1/2	-8	2.33	59	0.09	2	30	1.15	29
1C943-20-10	20	M30x2	-20	5/8	-10	2.59	66	0.05	1	36	1.22	31
1C943-20-12	20	M30x2	-20	3/4	-12	2.59	66	0.05	1	36	1.22	31
1C943-25-12	25	M36x2	-25	3/4	-12	2.67	68	0.10	3	46	1.24	31
1C943-30-16	30	M42x2	-30	1	-16	3.19	81	0.19	5	50	1.60	41
1C943-38-20	38	M52x2	-38	1-1/4	-20	3.35	85	0.23	6	60	1.70	43

### 10C43 Female Metric S - Swivel 45° Elbow (24° Cone with O-Ring)

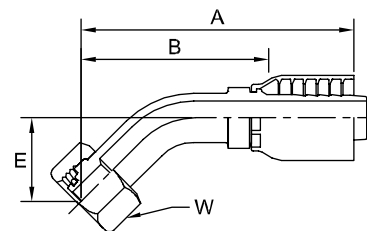

Note: Mates with EO "S" Series Fittings.

# Part Number	Thread			Hose		A		E		W	B	
	mm			inch		inch	mm	inch	mm	mm	inch	mm
10C43-10-4+	10	M18x1.5	-10	1/4	-4	2.85	72	0.71	18	22	2.10	53
10C43-12-6	12	M20x1,5	-12	3/8	-6	3.28	83	0.87	22	24	2.28	58
10C43-14-6+	14	M22x1,5	-14	3/8	-6	3.27	83	0.87	22	27	2.27	58
10C43-16-8	16	M24x1,5	-16	1/2	-8	3.96	101	0.96	24	30	2.71	69
10C43-20-10	20	M30x2	-20	5/8	-10	4.78	121	1.12	28	36	3.37	86
10C43-25-12	25	M36x2	-25	3/4	-12	3.97	101	1.06	27	46	2.40	61
10C43-30-16	30	M42x2	-30	1	-16	4.65	118	1.22	31	50	2.87	73
10C43-38-20	38	M52x2	-38	1-1/4	-20	4.96	126	1.30	33	60	1.89	48

+ Non-standard

## 43 Series Fittings

Metric S / BSP

Use with 301, 301LT, 304, 341, 381, 421, 421HT, 421WC, 424, 431, 436, 451TC, 471, 471ST, 481, 601, 604, and 881 hoses.

### 11C43 Female Metric S - Swivel 90° Elbow (24° Cone with O-Ring)

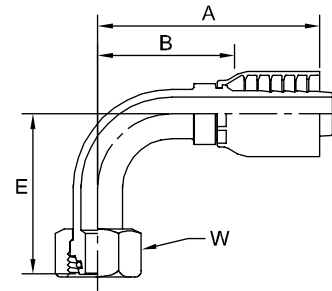

Note: Mates with EO "S" Series Fittings.

# Part Number	Thread			Hose		A		E		W	B	
	mm			inch		inch	mm	inch	mm	mm	inch	mm
11C43-8-4	8	M16x1,5	-8	1/4	-4	1.83	46	1.26	32	19	1.41	36
11C43-10-4	10	M18x1,5	-10	1/4	-4	2.45	62	1.34	34	22	1.71	43
11C43-12-5	12	M20x1,5	-12	5/16	-5	2.30	58	1.22	31	24	1.51	38
11C43-12-6	12	M20x1,5	-12	3/8	-6	2.36	60	1.48	38	24	1.36	35
11C43-14-6	14	M22x1,5	-14	3/8	-6	2.35	60	1.48	38	27	1.35	34
11C43-16-8	16	M24x1,5	-16	1/2	-8	2.94	75	1.75	44	30	1.69	43
11C43-20-10	20	M30x2	-20	5/8	-10	3.45	88	2.17	55	36	2.04	52
11C43-25-12	25	M36x2	-25	3/4	-12	3.74	95	2.17	55	46	2.22	56
11C43-30-16	30	M42x2	-30	1	-16	4.45	113	2.64	67	50	2.64	67
11C43-38-20	38	M52x2	-38	1-1/4	-20	5.67	144	2.87	73	60	2.99	76

### 1D943 Male BSP Parallel Pipe - Rigid Straight (60° Cone)

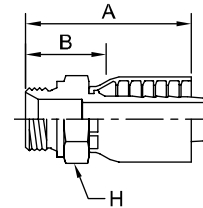

Note: When used in a port, a bonded seal must be used. See Section F.

# Part Number	Thread		Hose		A		H	B	
	inch		inch		inch	mm	mm	inch	mm
1D943-4-4	1/4x19	-4	1/4	-4	1.77	45	19	0.91	23
1D943-6-5	3/8x19	-6	5/16	-5	2.13	54	22	1.22	31
1D943-6-6	3/8x19	-6	3/8	-6	2.13	54	22	1.22	31
1D943-8-8	1/2x14	-8	1/2	-8	2.44	62	27	1.10	28
1D943-12-12	3/4x14	-12	3/4	-12	2.76	70	32	1.18	30
1D943-16-16	1x11	-16	1	-16	3.23	82	41	1.38	35

+ Non-standard



### 43 Series Fittings

Use with 301, 301LT, 304, 341, 381, 421, 421HT, 421WC, 424, 431, 436, 451TC, 471, 471ST, 481, 601, 604, and 881 hoses.

## 19243 Female BSP Parallel Pipe - Swivel Straight (60° Cone)

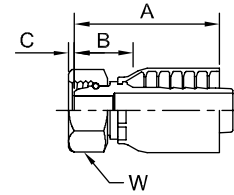

Note: When measuring overall length to the end of the nut, B & C must be used to calculate cut-off allowance.

# Part Number	Thread		Hose		A		C		W	B	
	inch		inch		inch	mm	inch	mm	mm	inch	mm
19243-4-4	1/4x19	-4	1/4	-4	1.65	42	0.22	6	19	0.92	19
19243-6-6	3/8x19	-6	3/8	-6	2.17	49	0.26	7	22	1.16	20
19243-8-8	1/2x14	-8	1/2	-8	2.28	58	0.28	7	27	1.03	24
19243-10-8	5/8x14	-10	1/2	-8	2.17	55	0.37	9	30	0.92	20
19243-10-10	5/8x14	-10	5/8	-10	2.36	60	0.37	9	30	0.95	21
19243-12-10	3/4x14	-12	5/8	-10	2.64	67	0.35	9	32	0.94	24
19243-12-12	3/4x14	-12	3/4	-12	2.52	64	0.35	9	32	1.09	28
19243-16-16	1x11	-16	1	-16	2.99	76	0.44	11	41	1.40	36
19243-20-16+	1-1/4x11	-20	1	-16	3.82	97	0.41	10	50	2.20	56
19243-24-24+	1-1/2x11	-24	1-1/2	-24	4.64	118	0.53	13	60	2.95	75

## 1B143 Female BSP Parallel Pipe - Swivel 45° Elbow (60° Cone)

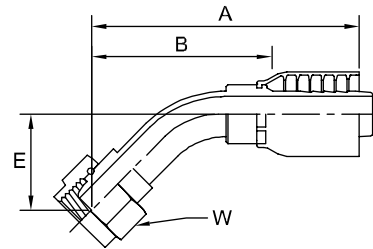

# Part Number	Thread		Hose		A		E		W	B	
	inch		inch		inch	mm	inch	mm	mm	inch	mm
1B143-4-4	1/4x19	-4	1/4	-4	2.44	62	0.63	16	19	1.54	39
1B143-6-4+	3/8x19	-6	1/4	-4	2.69	68	1.00	25	19	1.94	49
1B143-6-6	3/8x19	-6	3/8	-6	3.25	83	0.79	20	22	2.25	57
1B143-8-8	1/2x14	-8	1/2	-8	3.35	85	0.79	20	27	1.97	50
1B143-10-10	5/8x14	-10	5/8	-10	4.03	102	0.85	22	30	2.62	67
1B143-12-10	3/4x14	-12	5/8	-10	4.09	104	1.14	29	32	2.52	64
1B143-12-12	3/4x14	-12	3/4	-12	4.02	102	1.14	29	32	2.44	62
1B143-16-16	1x11	-16	1	-16	4.53	115	1.14	29	41	2.76	70

+ Non-standard

**43 Series Fittings**

Use with 301, 301LT, 304, 341, 381, 421, 421HT, 421WC, 424, 431, 436, 451TC, 471, 471ST, 481, 601, 604, and 881 hoses.

**1B243 Female BSP Parallel Pipe - Swivel  
90° Elbow (60° Cone)**

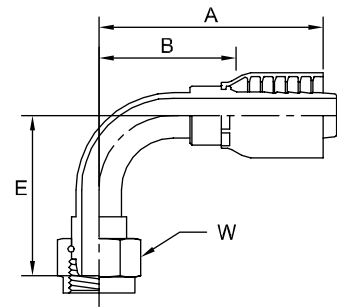

# Part Number	Thread		Hose		A		E		W	B	
	inch		inch		inch	mm	inch	mm	mm	inch	mm
1B243-4-4	1/4x19	-4	1/4	-4	1.83	46	1.12	28	19	1.08	27
1B243-6-6	3/8x19	-6	3/8	-6	2.32	59	1.46	37	22	1.32	34
1B243-8-8	1/2x14	-8	1/2	-8	2.95	75	1.57	40	27	1.57	40
1B243-10-8	5/8x14	-10	1/2	-8	2.91	74	1.57	40	30	1.54	39
1B243-10-10	5/8x14	-10	5/8	-10	3.13	80	1.57	40	30	1.72	44
1B243-12-10	3/4x14	-12	5/8	-10	3.62	92	2.32	59	32	2.05	52
1B243-12-12	3/4x14	-12	3/4	-12	3.58	91	2.32	59	32	2.00	51
1B243-16-16	1x11	-16	1	-16	4.33	110	2.48	63	41	2.56	65
1B243-20-20	1-1/4x11	-20	1-1/4	-20	4.72	120	2.99	76	50	2.87	73

**1B443 Female BSP Parallel Pipe - Swivel  
90° Elbow - Block Type (60° Cone)**

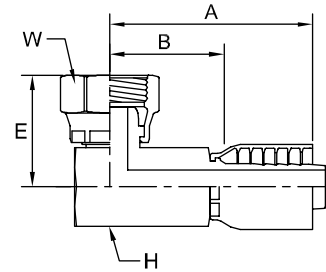

# Part Number	Thread		Hose		A		E		H	W	B		
	inch		inch		inch	mm	inch	mm	mm	mm	inch	mm	
1B443-4-4	1/4	1/4x19	-4	1/4	-4	2.40	61	1.14	29	17	19	1.40	36
1B443-6-6	3/8	3/8x19	-6	3/8	-6	2.76	70	1.02	26	19	22	1.42	36
1B443-8-8	1/2	1/2x14	-8	1/2	-8	3.19	81	1.02	26	22	27	1.57	40
1B443-12-12	3/4	3/4x14	-12	3/4	-12	3.30	84	1.30	33	23	32	0.98	25

+ Non-standard

### 43 Series Fittings

BSP / French Gaz

Use with 301, 301LT, 304, 341, 381, 421, 421HT, 421WC, 424, 431, 436, 451TC, 471, 471ST, 481, 601, 604, and 881 hoses.

## 1B543 Female BSP Parallel Pipe - Swivel Straight (Flat Seat)

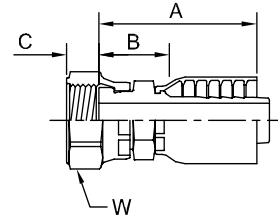

Note: When measuring overall length to the end of the nut, B & C must be used to calculate cut-off allowance.

# Part Number	Thread		Hose		A		C		W	B	
	inch		inch		inch	mm	inch	mm	mm	inch	mm
	1B543-6-6	3/8x19	-6	3/8	-6	2.01	51	0.35	9	22	0.98
1B543-8-6	1/2x14	-8	3/8	-6	2.06	52	0.43	11	27	1.03	26
1B543-8-8	1/2x14	-8	1/2	-8	2.28	58	0.43	11	27	1.02	26
1B543-12-12	3/4x14	-12	3/4	-12	2.63	67	0.33	8	36	1.19	30

## 1F443 Female French Gaz Series - Swivel Straight (Ball Nose)

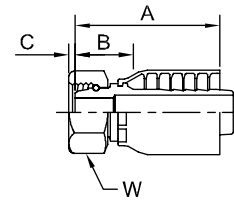

Note: When measuring overall length to the end of the nut, B & C must be used to calculate cut-off allowance.

# Part Number	Thread		Hose		A		C		W	B		
	mm		inch		inch	mm	inch	mm	mm	inch	mm	
	1F443-27-12	27	M36x1,5	-27	-12	3/4	3.00	76	0.14	4	55	1.14

+ Non-standard

### 43 Series Fittings

Use with 301, 301LT, 304, 341, 381, 421, 421HT, 421WC, 424, 431, 436, 451TC, 471, 471ST, 481, 601, 604, and 881 hoses.

### 14943 DIN Metric Banjo Straight

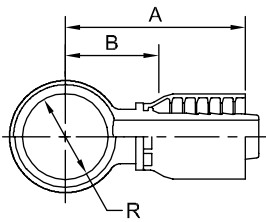

### AM Banjo Bolt with DIN Metric Thread

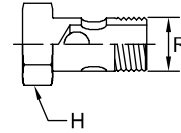

Note: Two (2) copper washers per bolt must be ordered separately.

# Part Number	R		Hose		A		B	
	mm	inch	mm	inch	mm	inch	mm	inch
14943-12-4	12	-12	1/4	-4	1.85	47	0.98	25
14943-14-5	14	-14	5/16	-5	2.01	51	1.06	27
14943-16-6	16	-16	3/8	-6	2.28	58	1.14	29
14943-18-8	18	-18	1/2	-8	2.60	66	1.22	31
14943-22-10	22	-22	5/8	-10	2.91	74	1.38	35
14943-26-12	26	-26	3/4	-12	3.07	78	1.54	39
14943-30-16+	30	-30	1	-16	3.62	92	1.85	47

# Part Number	R Thread		H	Copper Washer
	mm	inch	mm	2
AM-03	8	M8x1	12	853009-8
AM-04	10	M10x1	14	853009-10
AM-06	12	M12x1.5	17	853009-12
AM-08	14	M14x1.5	19	853009-14
AM-10	16	M16x1.5	22	853009-16
AM-13	18	M18x1.5	24	853009-18
AM-16	22	M22x1.5	27	853009-22
AM-20	26	M26x1.5	32	853009-26
AM-30	30	M30x1.5	36	853009-30

### 1UT43 Male BSP Taper Pipe - Rigid Straight (60° Cone)

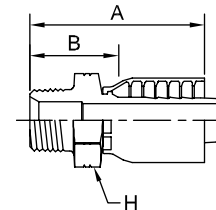

# Part Number	R		Hose		A		H		B	
	inch	mm	inch	mm	inch	mm	mm	inch	mm	
1UT43-4-4	1/4x19	-4	1/4	-4	1.93	49	19	1.18	30	
1UT43-6-4+	3/8x19	-6	1/4	-4	1.99	51	22	1.24	31	
1UT43-6-5+	3/8x19	-6	5/16	-5	2.07	53	22	1.32	34	
1UT43-6-6	3/8x19	-6	3/8	-6	2.24	57	22	1.24	31	
1UT43-6-8+	3/8x19	-6	1/2	-8	2.46	62	22	1.21	31	
1UT43-8-6+	1/2x14	-8	3/8	-6	2.43	62	27	1.43	36	
1UT43-8-8	1/2x14	-8	1/2	-8	2.68	68	27	1.43	36	
1UT43-8-10+	1/2x14	-8	5/8	-10	2.84	72	27	1.44	37	
1UT43-8-12+	1/2x14	-8	3/4	-12	2.98	76	27	1.54	39	
1UT43-12-8+	3/4x14	-12	1/2	-8	2.77	70	36	1.52	39	
1UT43-12-10+	3/4x14	-12	5/8	-10	2.94	75	36	1.54	39	
1UT43-12-12	3/4x14	-12	3/4	-12	2.96	75	36	1.53	39	
1UT43-12-16+	3/4x14	-12	1	-16	3.27	83	36	1.67	42	
1UT43-16-12+	1x11	-16	3/4	-12	3.15	80	41	1.73	44	
1UT43-16-16	1x11	-16	1	-16	3.46	88	41	1.87	47	
1UT43-16-20+	1x11	-16	1-1/4	-20	3.59	91	50	1.90	48	
1UT43-20-20	1-1/4x11	-20	1-1/4	-20	3.75	95	50	2.10	53	
1UT43-20-24+	1-1/4x11	-20	1-1/2	-24	3.36	85	50	1.99	51	

+ Non-standard

**43 Series Fittings**

Use with 301, 301LT, 304, 341, 381, 421, 421HT, 421WC, 424, 431, 436, 451TC, 471, 471ST, 481, 601, 604, and 881 hoses.

**1FU43 Female BSP Parallel Pipe - Swivel Straight (30° Flare)**

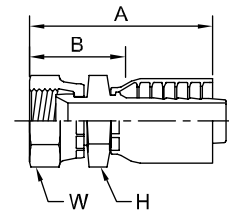

# Part Number	Thread		Hose		A		H	W	B	
	inch		inch		inch	mm	mm	mm	inch	mm
1FU43-4-4	1/4x19	-4	1/4	-4	1.97	50	19	19	1.24	31
1FU43-4-6+	1/4x19	-4	3/8	-6	2.23	57	19	19	1.30	33
1FU43-6-6	3/8x19	-6	3/8	-6	2.37	60	22	22	1.37	35
1FU43-8-8	1/2x14	-8	1/2	-8	2.72	69	27	27	1.47	37
1FU43-12-12	3/4x14	-12	3/4	-12	3.11	79	36	36	1.68	43
1FU43-16-16	1x11	-16	1	-16	3.51	89	41	41	1.92	49
1FU43-20-20	1-1/4x11	-20	1-1/4	-20	3.87	98	50	50	2.22	56
1FU43-32-32+	2X11	-32	2	-32	4.38	111	70	70	2.60	66

**1GU43 Female BSP Parallel Pipe - Swivel Straight (60° Cone)**

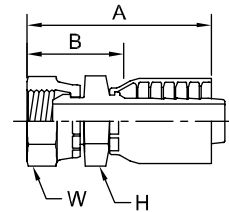

# Part Number	Thread		Hose		A		H	W	B	
	inch		inch		inch	mm	mm	mm	inch	mm
1GU43-2-4+	1/8x28	-2	1/4	-4	1.73	44	14	14	0.98	25
1GU43-4-4	1/4x19	-4	1/4	-4	1.77	45	19	19	1.30	33
1GU43-4-6+	1/4x19	-4	3/8	-6	2.29	58	19	19	1.29	33
1GU43-6-4+	3/8x19	-6	1/4	-4	1.85	47	22	22	1.10	28
1GU43-6-5+	3/8x19	-6	5/16	-5	1.93	49	22	22	1.18	30
1GU43-6-6	3/8x19	-6	3/8	-6	2.38	60	22	22	1.38	35
1GU43-6-8+	3/8x19	-6	1/2	-8	2.62	67	22	22	1.36	35
1GU43-8-4+	1/2x14	-8	1/4	-4	1.88	48	27	27	1.13	29
1GU43-8-6+	1/2x14	-8	3/8	-6	2.52	64	27	27	1.49	38
1GU43-8-8	1/2x14	-8	1/2	-8	2.74	70	27	27	1.49	38
1GU43-10-8+	5/8x14	-10	1/2	-8	2.86	73	30	30	1.54	39
1GU43-10-10+	5/8x14	-10	5/8	-10	2.98	76	30	30	1.56	40
1GU43-12-8+	3/4x14	-12	1/2	-8	2.98	76	36	36	1.73	44
1GU43-12-10+	3/4x14	-12	5/8	-10	3.15	80	36	36	1.74	44
1GU43-12-12	3/4x14	-12	3/4	-12	3.17	81	36	36	1.74	44
1GU43-16-12+	1x11	-16	3/4	-12	3.28	83	41	41	1.86	47
1GU43-16-16	1x11	-16	1	-16	3.59	91	41	41	2.00	51
1GU43-20-20	1-1/4x11	-20	1-1/4	-20	4.05	103	50	50	2.36	60
1GU43-32-32+	2x11	-32	2	-32	4.69	119	70	70	3.11	79

+ Non-standard

**43 Series Fittings**

Use with 301, 301LT, 304, 341, 381, 421, 421HT, 421WC, 424, 431, 436, 451TC, 471, 471ST, 481, 601, 604, and 881 hoses.

## 1MU43 Female Metric - Swivel Straight (30° Flare)

**Note: Japanese Fittings - Female Swivel 30° Flare with Metric Threads.** Some Japanese equipment use 30° flare fittings with metric threads. The combination of the 1MU43 and 1MU71 fittings in sizes up to -8 and the 1XU43 and 1XU71 in sizes -10 and larger, all 30° flared fitting size requirements are available.

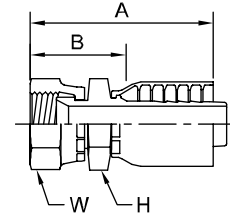

# Part Number	Thread		Hose		A		H	W	B	
	mm		inch		inch	mm	mm	mm	inch	mm
1MU43-4-4	M14x1,5	-4	1/4	-4	2.08	53	19	19	1.12	28
1MU43-4-6+	M14x1,5	-4	3/8	-6	2.35	60	19	19	1.35	34
1MU43-4-8+	M14x1,5	-4	1/2	-8	2.56	65	22	22	1.30	33
1MU43-6-4	M18x1,5	-6	1/4	-4	2.19	56	24	24	1.46	37
1MU43-6-6	M18x1,5	-6	3/8	-6	2.32	59	24	24	1.43	36
1MU43-8-6+	M22x1,5	-8	3/8	-6	2.62	67	27	27	1.59	40
1MU43-8-8	M22x1,5	-8	1/2	-8	2.72	69	27	27	1.37	35
1MU43-8-10+	M22x1,5	-8	5/8	-10	3.03	77	27	27	1.58	40
1MU43-32-32+	M60X2	-32	2	-32	4.50	114	70	70	2.72	69

## 1XU43 Female Metric - Swivel Straight (30° Flare)

**Note: Japanese Fittings - Female Swivel 30° Flare with Metric Threads.** Some Japanese equipment use 30° flare fittings with metric threads. The combination of the 1MU43 and 1MU71 fittings in sizes up to -8 and the 1XU43 and 1XU71 in sizes -10 and larger, all 30° flared fitting size requirements are available.

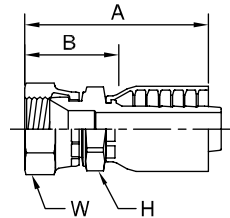

# Part Number	Thread		Hose		A		H	W	B		
	mm		inch		inch	mm	mm	mm	inch	mm	
1XU43-10-8+	5/8	M24x1.5	-10	1/2	-8	3.06	78	30	32	1.80	46
1XU43-10-10	5/8	M24x1.5	-10	5/8	-10	3.25	83	30	32	1.81	46
1XU43-10-12+	5/8	M24x1.5	-10	3/4	-12	3.27	83	32	32	1.83	46
1XU43-10-20+	5/8	M24x1.5	-10	1-1/4	-20	3.78	96	46	32	2.09	53
1XU43-12-12	3/4	M30x1.5	-12	3/4	-12	3.40	86	32	36	1.96	50
1XU43-12-16+	3/4	M30x1.5	-12	1	-16	3.89	99	36	36	2.27	58
1XU43-16-12+	1	M33x1.5	-16	3/4	-12	3.72	94	36	41	2.28	58
1XU43-16-16	1	M33x1.5	-16	1	-16	4.03	102	36	41	2.41	61
1XU43-20-12+	1-1/4	M36x1.5	-20	3/4	-12	3.87	98	46	46	2.43	62
1XU43-20-16+	1-1/4	M36x1.5	-20	1	-16	4.06	103	46	46	2.44	62
1XU43-20-20	1-1/4	M36x1.5	-20	1-1/4	-20	4.19	106	46	46	2.50	64
1XU43-24-16+	1-1/2	M42x1.5	-24	1	-16	4.41	112	50	55	2.79	71
1XU43-24-20+	1-1/2	M42x1.5	-24	1-1/4	-20	4.54	115	50	46	2.85	72
1XU43-24-24	1-1/2	M42x1.5	-24	1-1/2	-24	4.12	105	50	55	2.75	70

+ Non-standard