

**SACC-DSIV-MS-5CON-L180SCOTHRSH**

Order No.: 1439968

<http://eshop.phoenixcontact.de/phoenix/treeViewClick.do?UID=1439968>

Sensor/actuator flush-type connector, connector, 5-pos., M12  
SPEEDCON, shielded, A-coded, rear/screw mounting with M12  
thread, with straight THR solder connection

**Commercial data**

GTIN (EAN)	 4 046356 476683
sales group	D125
Pack	60 pcs.
Customs tariff	85366990
Catalog page information	Page 387 (PC-2011)

**Product notes**

WEEE/RoHS-compliant since:  
12/01/2008



[http://  
www.download.phoenixcontact.com](http://www.download.phoenixcontact.com)  
Please note that the data given  
here has been taken from the  
online catalog. For comprehensive  
information and data, please refer  
to the user documentation. The  
General Terms and Conditions of  
Use apply to Internet downloads.

**Technical data****General data**

Rated current at 40°C	0.5 A
Rated voltage	48 V
Number of positions	8

Volume resistance	< 5 mΩ
Insulation resistance	> 100 MΩ
Ambient temperature (operation)	-40 °C ... 85 °C

#### General characteristics

Surge voltage category	III
Pollution degree	3
Degree of protection	IP67, when plugged in
Insertion/withdrawal cycles	≥ 100
Contact material	CuZn
Contact surface material	Ni/Au
Contact carrier material	PA 66
Material of grip body	Zinc die-cast, nickel-plated
Material, knurls	Zinc die-cast, nickel-plated
Material	Zinc die-cast (nickel-plated)
Sealing material	NBR

#### Conductor data

Transmission characteristics (category)	CAT6 <sub>A</sub>
---	-------------------

#### Diagrams/Drawings

Drilling plan/solder pad geometry

Soldering pad geometry

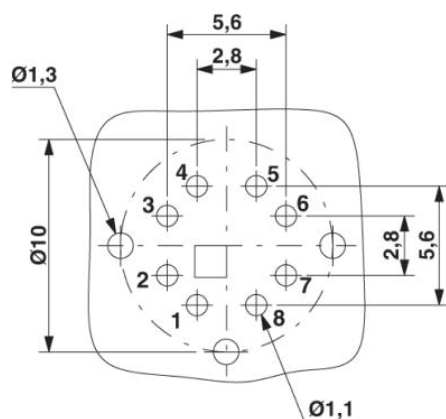

Dimensioned drawing

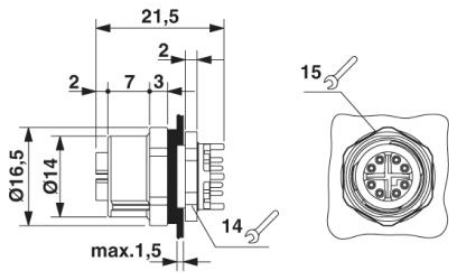

M12 flush-type socket

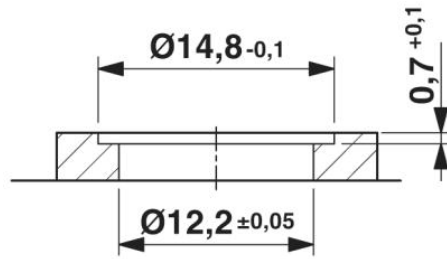

Housing cut-out for two-part M12 flush-type connectors with THR and wave soldering connection, version 1

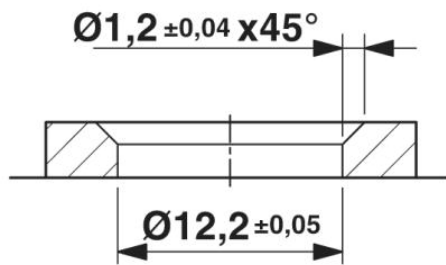

Housing cut-out for two-part M12 flush-type connectors with THR and wave soldering connection, version 2

Schematic diagram

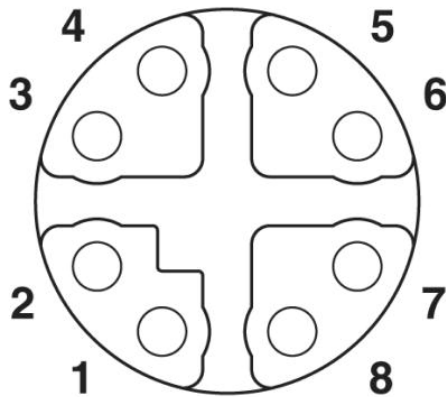

Pin assignment M12 connector, 8-pos., view socket side

**Address**

PHOENIX CONTACT Deutschland GmbH  
Flachmarktstr. 8  
32825 Blomberg, Germany  
Phone +49 5235 3 12000  
Fax +49 5235 3 41200  
<http://www.phoenixcontact.de>



© 2011 Phoenix Contact  
Technical modifications reserved;