

## HYDRAULIC SPREADERS

Part Number	Spread (in.)		Capacity (Tons)	Weight (lbs.)
	Min. (A)	Max. (B)		
PXFS15-FL	.24	.63	15	7.3
PXFS15-ST	.24	.63	15	7.3
PXFS25-FL	.31	1.0	25	17
PXHS-1000	1.3	11.9	1	25
PXHS-0750	1.0	3.0	.75	5



PXFS15-FL

PXFS15-ST

PXFS25-FL



PXHS-1000

PXHS-0750

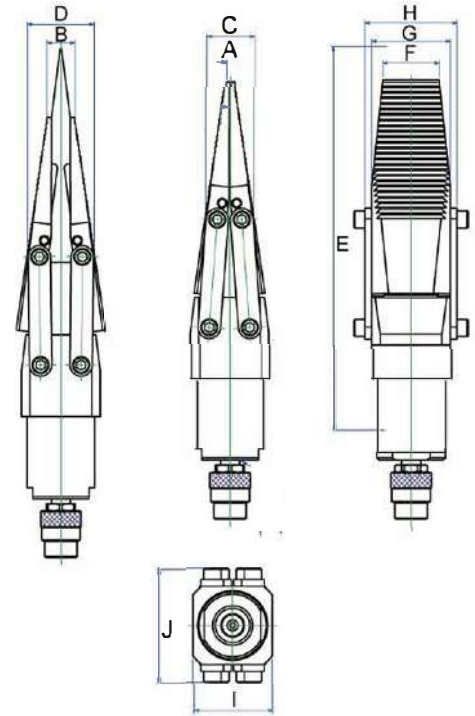

### DESCRIPTION

- Compact design will optimize use in low clearance applications
- Lightweight for increased portability
- Manufactured from high quality hardened steel

### Dimensions

Part Number	C (In.)	D (In.)	E (In.)	F (In.)	G (In.)	H (In.)	I (In.)	J (In.)
PXFS15-FL	1.4	1.8	9.1	1.2	1.8	2.2	2.5	2.5
PXFS15-ST	1.4	1.8	9.1	1.2	1.8	2.2	2.5	2.5
PXFS25-FL	1.7	2.3	13.5	2.0	2.8	3.2	2.8	4.0
PXHS-1000	6.6	6.6	19.2	2.4	2.4	2.4	2.4	6.6
PXHS-0750	1.0	2.1	8.8	2.1	2.1	2.1	2.1	2.1