

"338" Series

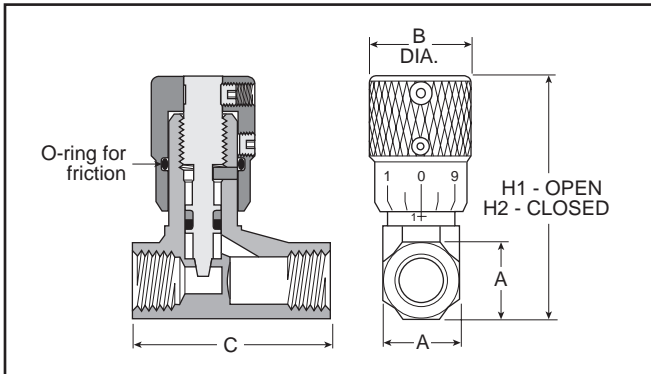
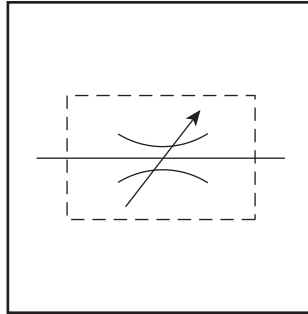

General Information

"338" Series needle valves bi-directionally meter the flow of air through the valve.

This series features a fine tapered needle providing precise flow of air in both directions. Numerical micrometer position markings are stamped on the perimeter of the adjustment knob which provide a visual indication of the setting. Once the desired flow is selected, a set screw can be tightened to maintain the setting.

These valves are available with NPTF ports in 1/8", 1/4", 3/8" 1/2" and 3/4" sizes. This series is recommended for pneumatic service

Valve Specifications

Maximum Operating Pressure 250 PSIG (Air)

Operating Temperature Standard: 0° to 180°F*
Extended Temperature 0°F to 300°F* (Consult factory)

* Ambient temperatures below freezing require moisture-free air. Ambient temperatures below freezing and above 180° require lubricants especially selected for suitability at these temperatures. Pneumatic valves should be used with filtered and lubricated air.

Component Materials

Body Material Brass
Internal Components Stainless Steel / Brass
Seals Nitrile (Fluorocarbon optional – consult factory)

Model Selection and Dimensions

Model Number	Port Size	Dimensions					Kit
		A	B	C	H1	H2	
00338 1100	1/8"	9/16"	0.75	1.47	2.03	1.81	00337 8000
00338 1101	1/4"	11/16"	0.75	1.47	2.28	2.03	00337 8001
00338 1102	3/8"	7/8"	0.88	2.31	2.84	2.53	00337 8002
00338 1103	1/2"	1-3/16"	1.06	3.25	3.62	3.22	00337 8003
00338 1104	3/4"	1-3/8"	1.06	3.25	3.72	3.31	00337 8004

Performance Data – Flow

Model Number	Port Size	Flow (SCFM†)
00338 1100	1/8"	15
00338 1101	1/4"	28
00338 1102	3/8"	59
00338 1103	1/2"	126
00338 1104	3/4"	140

† At 100 PSIG inlet pressure with full pressure drop.

