

- Aluminium bodies
- Rugged brass body design
- Standard or high temperature options
- Long life
- Low 0,1 bar operating pressure
- Full flow in one direction only
- Instant push-in connections



Operating and additional information

Non return valves - Female - VB

Operating pressure: 0,1 to 10 bar
 Operating temperature: -20°C to +70°C
 Body material: Anodised aluminium
 Seal material: Nitrile

Non return valves - Push-in - PWA

Operating pressure: 0,2 to 10 bar
 Operating temperature: -15°C to +70°C
 Storage temperature: -20°C to +70°C
 Body material: Thermo plastic

Non return valves - Male thread - 3047

Operating pressure: 0,1 to 17 bar
 Flow: Qmax at 6 bar, l/min*
 1/8 = 1200L/m;
 1/4 = 1350 L/m
 Operating temperature:
 Standard: -26°C to +85°C
 High: -26°C to +230°C
 Body material: Brass
 Seal material Standard: Nitrile
 High: Viton

VB Series

VB - Aluminium

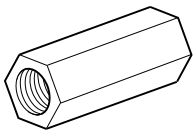

Symbol



Port size	Weight g	Order code
G1/8	10	VB12-Q-NQ-5
G1/4	10	VB22-Q-NQ-5
G1/2	50	VB42-Q-NQ-5

Dimensions (mm)

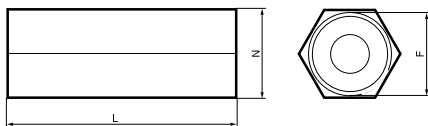

Order code	F	L	N
VB12-Q-NQ-5	G1/8	31	14
VQB22-Q-NQ-5	G1/4	40	17
VB42-Q-NQ-5	G1/2	59	27

PWA Series

Line Mounted

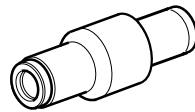

Symbol



Sold in lots of 10

Push-in Connection Ømm	Flow Rate at 6 bar, l/min	Order code
4	200	PWA-L1444
6	660	PWA-L1466
8	1600	PWA-L1488

Dimensions (mm)

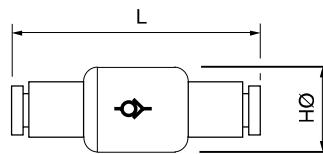

Order code	ØH	L
PWA-L1444	16,0	38,5
PWA-L1466	16,0	41,0
PWA-L1488	19,0	51,5

3047 Series

Standard version



Symbol



Thread Size	Weight g	Order code
R1/8	68	3047X
R1/4	72	3047B

High temperature version



Symbol



Thread Size	Weight g	Order code
R1/8	68	3047XV
R1/4	72	3047BV

Dimensions (mm)

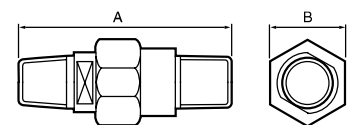

Order code	Port Size	A	B
3047X/XV	R1/8	51	21
3047B/BV	R1/4	49	21