

**Features**

- Tested in accordance with ISO 8573.9
- High liquid removal efficiencies at all flow conditions
- Low pressure losses for low operational costs
- Multiple port sizes for a given flow rate provides increased flexibility during installation
- Suitable for variable flow compressors
- Works with all types of compressor and compressor condensate
- Low maintenance
- Lightweight cast aluminum housing with 1/4" to 3" ports
- External surface epoxy painted for maximum corrosion resistance



**Applications**

- Bulk liquid removal at any point in a compressed air system
- Protection of refrigeration and heatless regenerative desiccant dryers
- Liquid removal from compressor Inter-coolers / after-coolers
- Liquid separation within refrigeration dryers
- Pre-filtration

**Operating information**

P3TF (Bulk Liquid Separator)	
Operating pressure	232 PSIG (16 bar) Max
Operating temperature	35°F to 176°F (1,5°C to 80°C)
For technical information see CD	

**Flow**

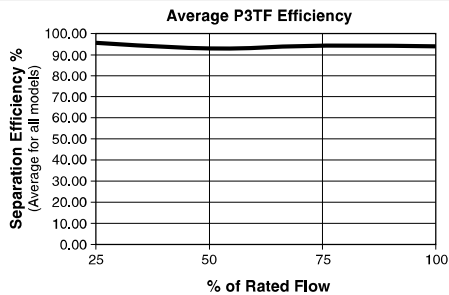

**Material specifications**

Description	P3TF (Bulk Liquid Separator)
Auto float drain	Plastic
Housing / bowl	Aluminum
Seals	Fluorocarbon

**Service kits**

Drain	<b>EF1</b>
-------	------------

**P3TF Bulk Liquid Separator**

	Pipe size	Flow SCFM (L/s)	Weight lb. (kg)	Part number (NPT)
P3TF	1/4"	21 (10)	0.9 (0.4)	<b>P3TFA92WAAN</b>
	3/8"	85 (40)	2.2 (1.0)	<b>P3TFA93WBAN</b>
	1/2"	85 (40)	2.2 (1.0)	<b>P3TFA94WCAN</b>
	3/4"	233 (110)	4.8 (2.2)	<b>P3TFA96WDAN</b>
	1"	233 (110)	2.6 (5.7)	<b>P3TFA98WEAN</b>
	1-1/2"	742 (350)	5.3 (11.6)	<b>P3TFA9BVGAN</b>
	2"	742 (350)	5.3 (11.6)	<b>P3TFA9CWHAN</b>
	3"	1695 (800)	12.0 (26.4)	<b>P3TFA9EWKAN</b>



**Pressure Differential at Rated Flow ...** 1.0 PSID (0,07 bar)  
 Stated flows are for operation at 102 PSIG (7 bar) with reference to 20°C, 1 bar (a), 0% relative water vapor pressure.

Note: BSPT threads available upon request.

Most popular.



**P3TF (Bulk Liquid Separator)**

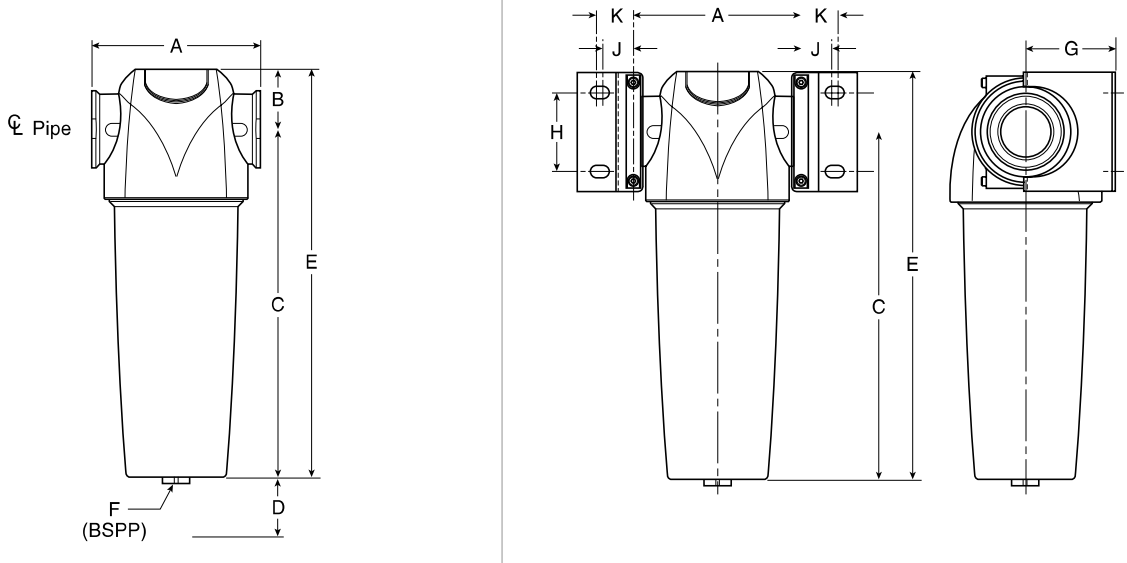

**Dimensions**

Part number	Pipe size	A	B	C	D	E	BSPP F	G	H	J	K	Wall mounting bracket kit
P3TFA92WAAN	1/4"	3.00 (76)	1.12 (28.5)	6.02 (153)	1.58 (40)	7.15 (181.5)	1/2	2.05 (50)	1.18 (30)	0.71 (18)	0.96 (24.5)	<b>P3TKA00MWA</b>
P3TFA93WBAN	3/8"	3.83 (97.5)	1.34 (34)	7.91 (201)	1.97 (50)	9.25 (235)	1/2	2.36 (60)	1.57 (40)	0.81 (20.5)	1.00 (25.5)	<b>P3TKA00MWB</b>
P3TFA94WCAN	1/2"	3.83 (97.5)	1.34 (34)	7.91 (201)	1.97 (50)	9.25 (235)	1/2	2.36 (60)	1.57 (40)	0.81 (20.5)	1.00 (25.5)	<b>P3TKA00MWB</b>
P3TFA96WDAN	3/4"	5.07 (129)	1.67 (42.5)	13.09 (232.5)	2.76 (70)	10.80 (275)	1/2	2.68 (68)	2.36 (60)	0.91 (23)	1.10 (28)	<b>P3TKA00MWD</b>
P3TFA98WEAN	1	5.07 (129)	1.67 (42.5)	12.68 (322)	2.76 (70)	14.35 (364.5)	1/2	2.68 (68)	2.36 (60)	0.91 (23)	1.10 (28)	<b>P3TKA00MWD</b>
P3TFA9BVGAN	1-1/2"	6.70 (170)	1.97 (50)	18.68 (474.5)	3.94 (100)	20.64 (524.5)	1/2	3.62 (92)	3.31 (84)	1.26 (32)	1.54 (39)	<b>P3TKA00MWF</b>
P3TFA9CWHAN	2"	6.70 (170)	1.97 (50)	18.68 (474.5)	3.94 (100)	20.64 (524.5)	1/2	3.62 (92)	3.31 (84)	1.26 (32)	1.54 (39)	<b>P3TKA00MWF</b>
P3TFA9EWKAN	3"	8.07 (205)	2.36 (60)	30.39 (772)	4.72 (120)	32.76 (832)	1/2	5.31 (135)	3.94 (100)	1.40 (35.5)	1.67 (42.5)	<b>P3TKA00MWJ</b>

Inches (mm)



**Wall Mounting Bracket Kit**

Mounting brackets provide additional support to filters installed in flexible piping systems or OEM equipment.

**For External Drains, please reference WDV3-G Automatic Electrical Drain or ED Zero Loss Drain.**

