

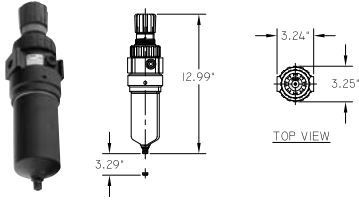

Prep-Air® II Coalescer Piggyback Filter/Regulator

Integral piggyback filter/regulators are an excellent choice where accurate pressure regulation and high moisture removal efficiency are required in a space-saving package. Coalescing filters are designed to remove over 99.9% of the liquid aerosols, both water and oil, and submicron particulate matter from your pneumatic system. These filters will provide for applications needing oil-free, clean air. A pressure differential indicator is standard on all Parker coalescing filters. This feature shows positive indication when the element is dirty. Rated at grade 6; 99.97% efficient at 0.3 to 0.6 micron.



Caution:

- Should not be located in areas where they could be subjected to direct sunlight, an impact blow, or temperatures outside of the rated range
- Do not expose to chlorinated hydro-carbons, ketones, esters, and certain alcohols
- Do not use in air systems where compressors are lubricated with fire-resistant fluids such as phosphate ester and di-ester types

Bowl Capacity: 7.2 oz
Bowl Type: Metal Bowl
Drain Type: Twist Drain
Filter Element: 0.01 µm (Grade 6)
Port Type: NPT

Standard

Order No.	Mfr. No.	Port Size (in)	Flow (scfm)	Net Price
MA6392299	12E33E13AA	1/2	40	\$158.13
MA6392300	12E43E13AA	3/4	45	158.13

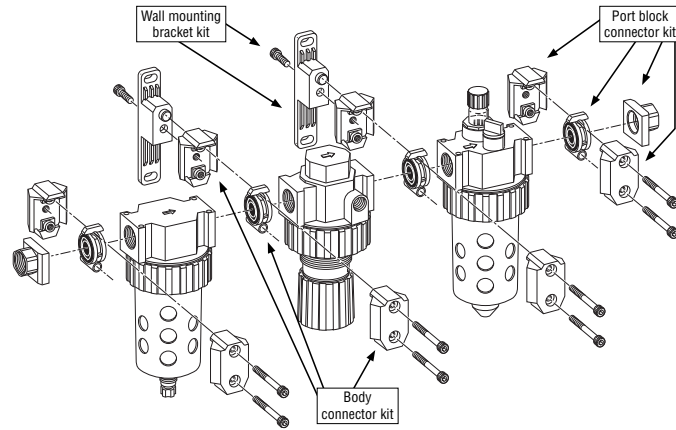

Port Block Connector Kit



Port block connectors are used to couple an FRL component with a threaded pipe. Installing port blocks instead of threading pipe directly to the FRL permits easy replacement without disturbing piping and can reduce spare parts inventory. Instead of stocking multiple FRL units of the same body size (series) with different port sizes, a single FRL unit can be fitted to a range of pipe sizes with port blocks.

Includes:

- All necessary pieces to make two port connections

Port Type: NPT

Series	Type	Port Size (in)	Order No.	Mfr. No.	Net Price
05, 15	Economy	1/4	MA6391893	PS95001P	\$20.59
		3/8	MA6391895	PS95002P	20.59
06, 16	Compact	1/4	MA6390060	PS750P ^a	21.60
		3/8	MA6390061	PS751P ^a	21.60
		1/2	MA6390062	PS752P ^a	21.60
07, 17	Standard	3/8	MA6390069	PS851P	22.47
		1/2	MA6390070	PS852P	22.47
		3/4	MA6390071	PS853P	22.47

^a Use 1/4" or 3/8" ported bodies.



Body Connector Kit



Body connectors allow for easy assembly and disassembly of modular components. The body connector pulls the units together against the one-piece seal, allowing for a tight seal. Because the one-piece seal is firmly mounted into the retainer, there are no o-rings to fall out or become misaligned. **Body connectors are not supplied with manifold blocks.**

Includes:

- One set of connectors

Series	Type	Order No.	Mfr. No.	Net Price
05	Economy	MA8138550	PS954P	\$6.67
06	Compact	MA6390063	PS754P	8.93
07	Standard	MA6390072	PS854P	9.25



Modular Manifold Block



A modular manifold block can be used between any two modular units to give additional outlet ports. Any standard pipe plug can be used to close off unused ports.

Features:

- Block provides two additional outlets in 3/8" and 1/2" sizes

Port Type: NPT

Series	Type	Order No.	Mfr. No.	Port Size (in)	No. of Ports	Net Price
05	Economy	MA6391887	PS95701P	1/4	4	\$16.00
06, 16	Compact	MA6393322	PS757P	3/8	4	21.44
07, 17	Standard	MA6393323	PS857P	1/2	4	23.16



Wall Mounting Bracket Kit



Wall mounting kits provide solid mounting of modular FRL assemblies.

Order two kits per FRL assembly.

Includes:

- 1 bracket and hardware

Series	Type	Order No.	Mfr. No.	Net Price
05	Economy	MA6391896	PS955P	\$4.85
06, 07	Compact, Standard	MA6390064	PS755P	7.83



Mounting Bracket Kit



This plated steel mounting bracket is prefabricated to save time in mounting FRLs to walls, machine surfaces, unistruts, or aluminum framing material. **Order one kit per FRL component.**

Includes:

- Mounting fasteners

Component	Series	Order No.	Mfr. No.	Net Price
Regulator	05	MA6392305	PS963P ^a	\$7.00
	06, 11	MA6390057	PS707P ^a	8.76
	07, 12	MA6390066	PS807P ^a	8.76
Regulator, Filter, Lubricator	10, 14	MA0173050	PS417BP	7.67
	P3N	MA0659125	P3NKA00MW	28.46
Filter, Lubricator	06, 11, 16	MA6390059	PS743P ^a	8.76
	07, 12, 17	MA6390067	PS843P ^a	8.43

^a Panel mount nut included.



Panel Mount Nut



Panel mount nut is used to secure pressure regulators on a control panel or mounting bracket. Use one per regulator.

Features:

- Standard nut fits both compact and full-sized regulators
- Maximum panel thickness 3/16"
- Hole diameter required 1 3/16"

Metal

Series	Type	Order No.	Mfr. No.	Net Price
05	Economy	MA0315286	PS964P	\$5.19
06, 07	Compact, Standard	MA6392950	P04079B	5.63
14	Miniature	MA9567046	P01531	3.87

Plastic

Series	Type	Order No.	Mfr. No.	Net Price
06, 07	Compact, Standard	MA6390073	P04082	\$5.54
14	Miniature	MA6590505	P78652	3.24

